

PUBLIC PATH DIVERSION ORDER

TOWN AND COUNTRY PLANNING ACT 1990, SECTION 257

**Broxbourne Borough Council
(Hoddesdon 9)
Diversion Order 2024**

This Order is made by Broxbourne Borough Council ('the authority') under section 257 of the Town and Country Planning Act 1990 because it is satisfied that it is necessary to divert the footpath to which this Order relates in order to enable development to be carried out in accordance with planning permission granted under Part III of the Town & Country Planning Act 1990 namely:

High Leigh Garden Village, Hoddesdon, Hertfordshire, EN11, 07/13/0899/O and 07/23/0760/PROW; outline application for construction of a new mixed use development together with associated infrastructure comprising: 1) 485 housing units 2) Delivery of a 2FE Primary School 3) Associated green space, landscaping and Green infrastructure including allotments 4) Associated hard landscaping and drainage systems.

BY THIS ORDER

1. The footpath over the land shown by the solid black line between points A and B on the attached plan ('the Order Plan') and described in Part 1 of the Schedule to this Order ('the Schedule') shall be diverted as provided below.
2. There shall be created to the reasonable satisfaction of Broxbourne Borough Council alternative public footpaths for the use as replacements for the said footpath as provided in Part 2 of the Schedule and shown by bold black dashes on the attached Order Plan.
3. The diversion of the footpath shall have effect on the date on which Broxbourne Borough Council certify that the terms of Article 2 have been complied with.
4. Where immediately before the date on which the footpath is diverted there is apparatus under, in, on, over, along or across it belonging to statutory undertakers for the purpose of carrying on their undertaking, the undertakers shall continue to have the same rights in respect of the apparatus as they then had.

IN WITNESS whereof the COMMON SEAL of Broxbourne Borough Council was hereunto affixed this 10th day of April 2024

The Common Seal of
Broxbourne Borough
Council was hereunto
affixed in the presence of:-

SCHEDULE

PART 1
Description of Existing Path or Way

The full width of Hoddesdon Footpath 9 commencing at the pedestrian footbridge, west of Paddicks Close (public road) at TL 3662 0914 (Point A on the Order Plan) and running in a generally west direction for approximately 320 metres to a junction with Hoddesdon Restricted Byway 7 (Bramble Lane) at TL 3630 0916 (Point B on the Order Plan).

Part 2
Description of Alternative Footpaths

1. A public footpath commencing at the pedestrian footbridge, west of Paddicks Close (public road) TL 3662 0914 (Point A on the Order Plan) and running west, parallel to the Dinant Link Road, for approximately 165 metres to TL 3645 0912 (Point C on the Order Plan)

Width: 3 metres from TL 3662 0914 (Point A on the Order Plan) to TL 3645 0912 (Point C on the Order Plan)

2. A public footpath commencing at High Leigh Garden Village TL 3645 0912 (Point C on the plan) running generally north for approximately 55 metres to TL 3644 0917 (Point D on the Order Plan)

Width: 3 metres from TL 3645 0912 (Point C on the Order plan) to TL 3644 0917 (Point D on the Order Plan)

3. A public footpath commencing at High Leigh Garden Village) TL 3644 0917 (Point D on the Order Plan) continuing generally west for approximately 145 metres to re-connect with Hoddesdon Restricted Byway 7 (Bramble Lane) at TL 3630 0917 (Point E on the Order Plan)

Width: 3 metres from TL 3644 0917 (Point D on the Order Plan) to TL 3630 0917 (Point E on the Order Plan).

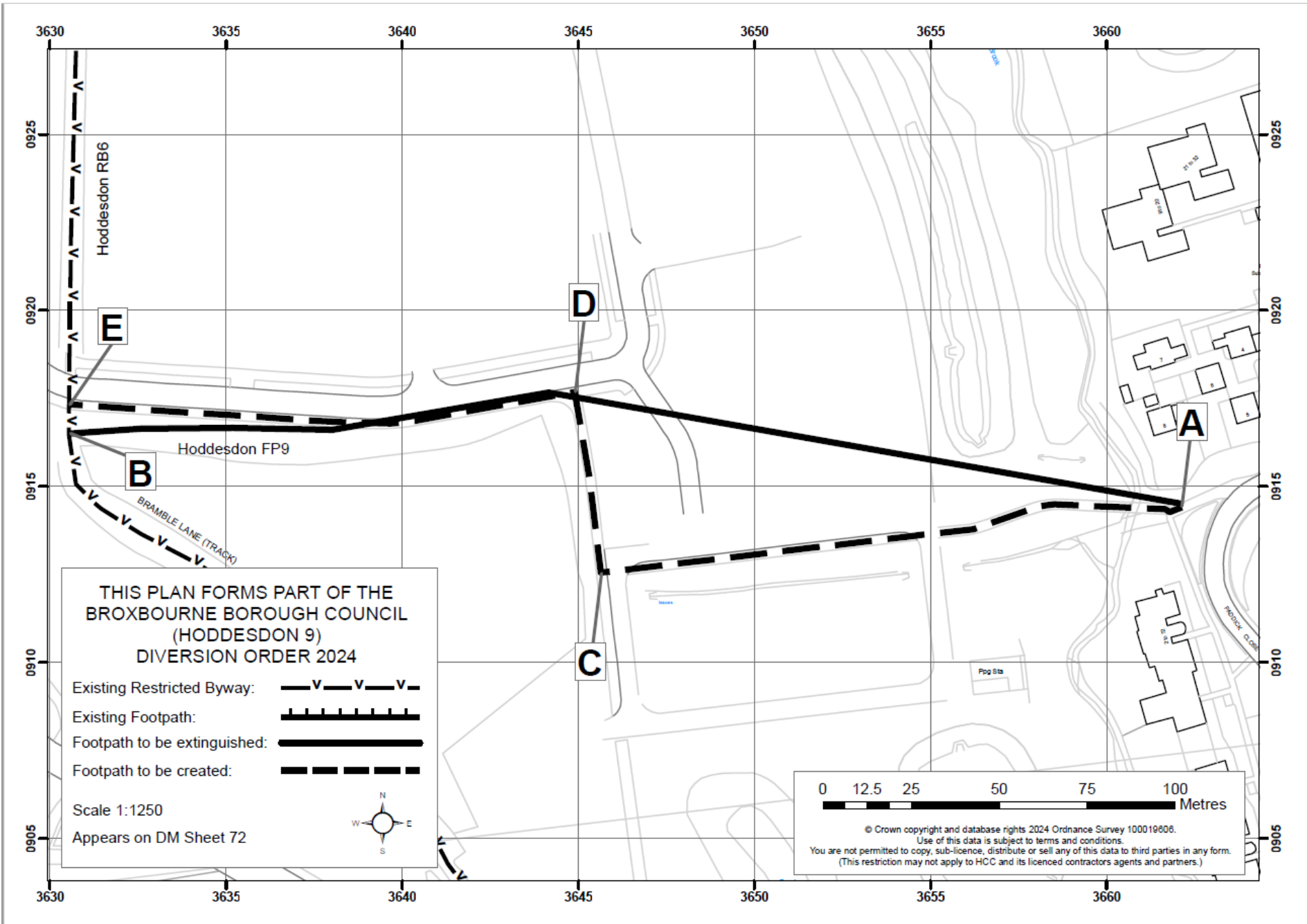

THIS PLAN FORMS PART OF THE
 BROXBOURNE BOROUGH COUNCIL
 (HODDESDON 9)
 DIVERSION ORDER 2024

- Existing Restricted Byway:
- Existing Footpath:
- Footpath to be extinguished:
- Footpath to be created:

Scale 1:1250
 Appears on DM Sheet 72

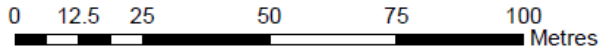

© Crown copyright and database rights 2024 Ordnance Survey 100019808.
 Use of this data is subject to terms and conditions.
 You are not permitted to copy, sub-licence, distribute or sell any of this data to third parties in any form.
 (This restriction may not apply to HCC and its licenced contractors agents and partners.)