

Goff's Oak improvement plan

Options analysis

Summary of options

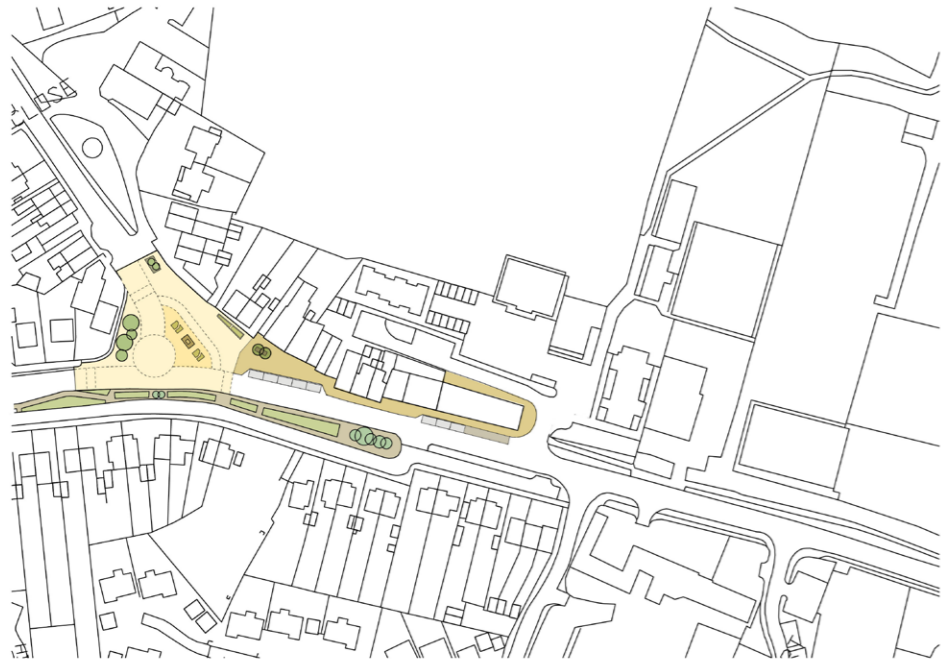

Option 01

Village centre improvement plan with **parking retained**

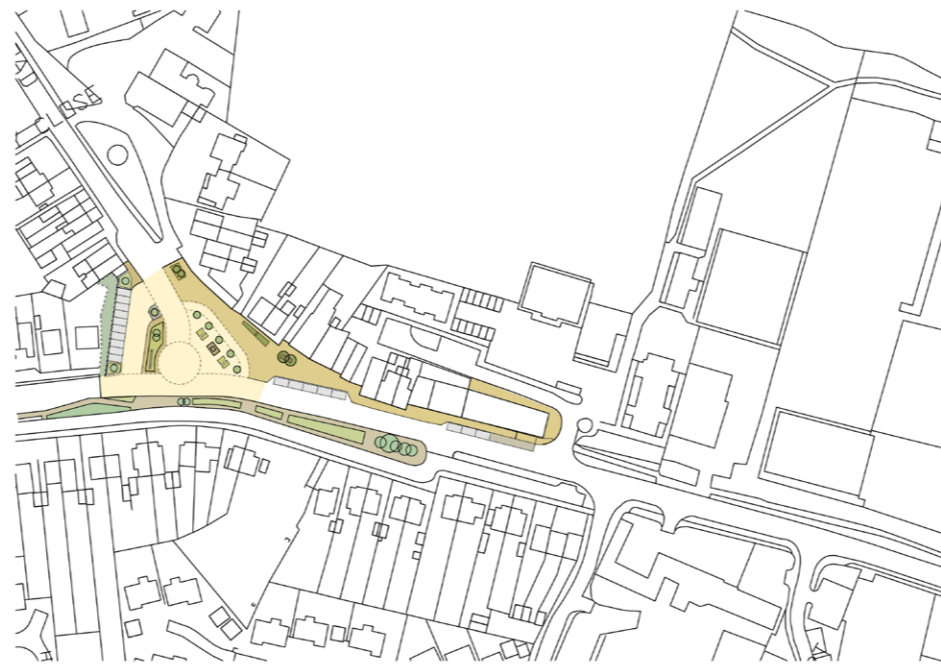

Option 02

Village centre improvement plan with **additional parking space**

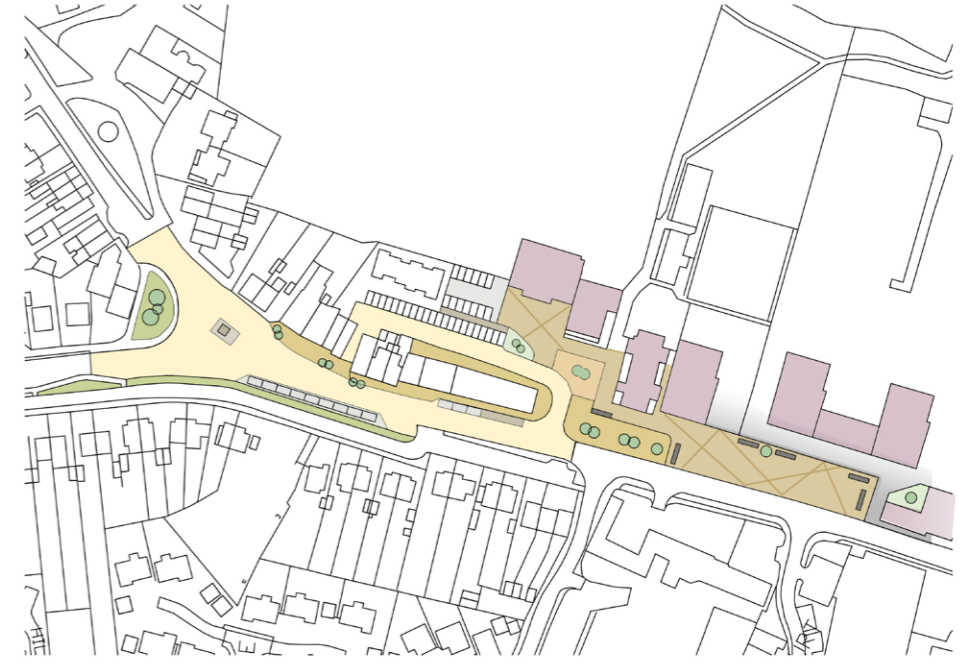

Option 03

Village centre improvement plan **integrating social infrastructure as part of a phased masterplan**

Option 01

Concept sketch and initial ideas



Mini parklets around bus stops, Slough public realm



Success of Frideswide Square at Oxford using an informal roundel whilst creating a public square



Option 01

Improvement plan



Traffic calming measures including 20mph limit

Shared surface treatments with indicative road markings and trench drains to capture rain water

Increase footway width and paving near retail/businesses to facilitate longer dwell times and create a pedestrian priority shopping environment

Potential site for A3/A4 uses near Bus Stop

Safe pedestrian crossing points

Retain mature trees

Low level planting and seating framing the memorial as a character feature

Green buffer screening houses fronting onto the street from heavy traffic

Bus stop

Option 02

Concept sketch and initial ideas



Additional parking spaces

Green buffer screening houses fronting onto the street

Increased footway width and spill out public realm area in close proximity to retail uses



High quality paving and planting creates desirable streetscapes as seen on Argyle Street



Safe pedestrian crossings marked across roads

Option 02

Improvement plan



New proposed parking space for the village centre

Shared surface treatments with indicative road markings and trench drains to capture rainwater

Increase footway width and paving along the development edge creating a wider footpath experience

Potential site for A3/A4 uses near Bus Stop

Feature seating and plating buffering the parking space

Low level planting and seating framing the Memorial

Green buffer screening houses fronting onto the street from heavy traffic

Bus stop

Option 03

Concept sketch and initial ideas



Public realm at Thomas More square framed and activated by buildings of various uses



Mobile green seating isles with planter boxes

Option 03

Improvement plan

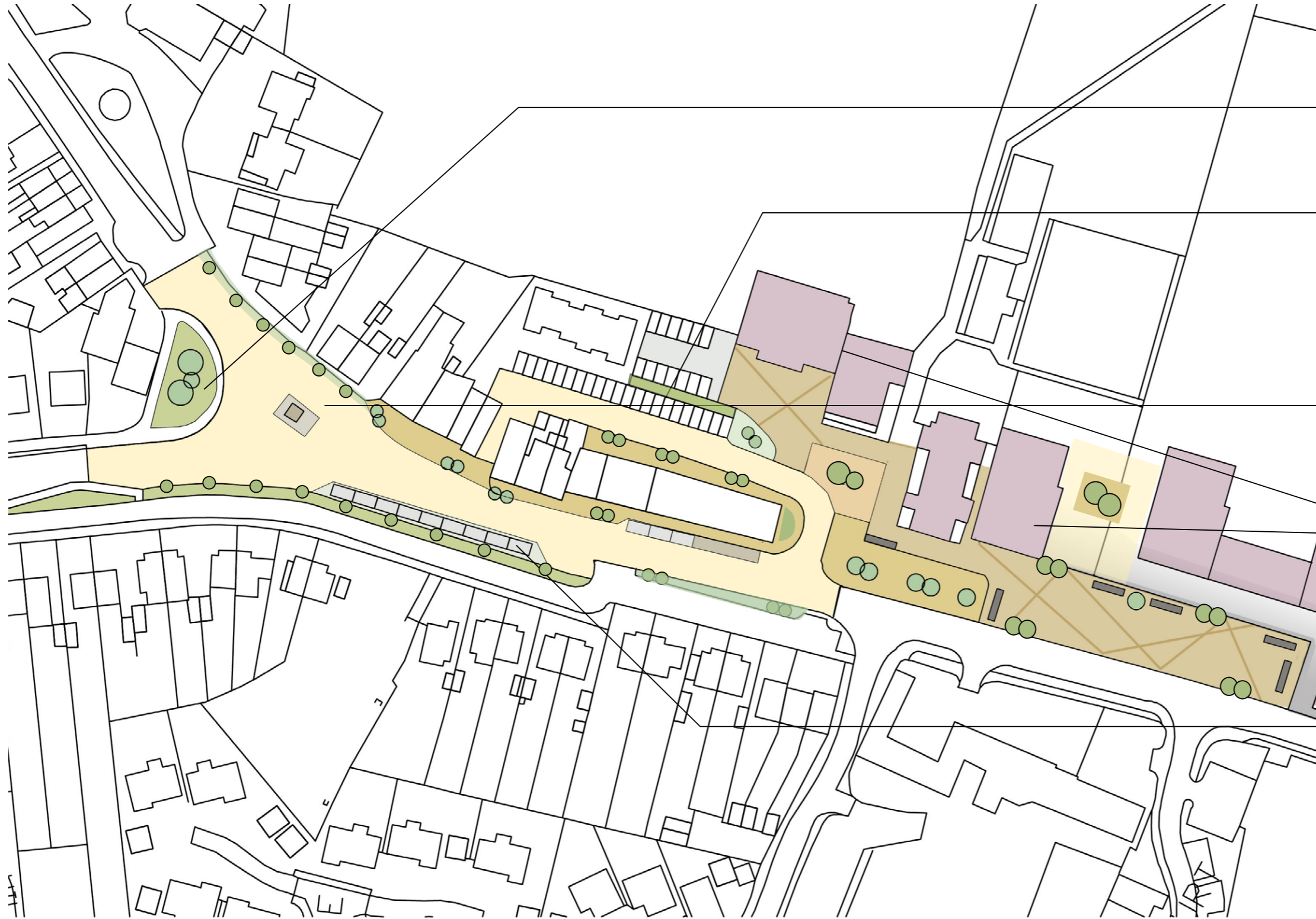

Mature trees replanted with soil cells for tree roots

Parking spaces reconfigured to create a more efficient layout and create a new connections

Centreline omitted from the carriageway to encourage lower speeds alongside paved surface treatments and decluttering measures

Library, GP surgery, Community Hall and other elements of social infrastructure are framed around public space that captures footfall and creates a strong identity

Parking relocated away from the primary footpath to provide a better street edge and shopping experience

Wider Context

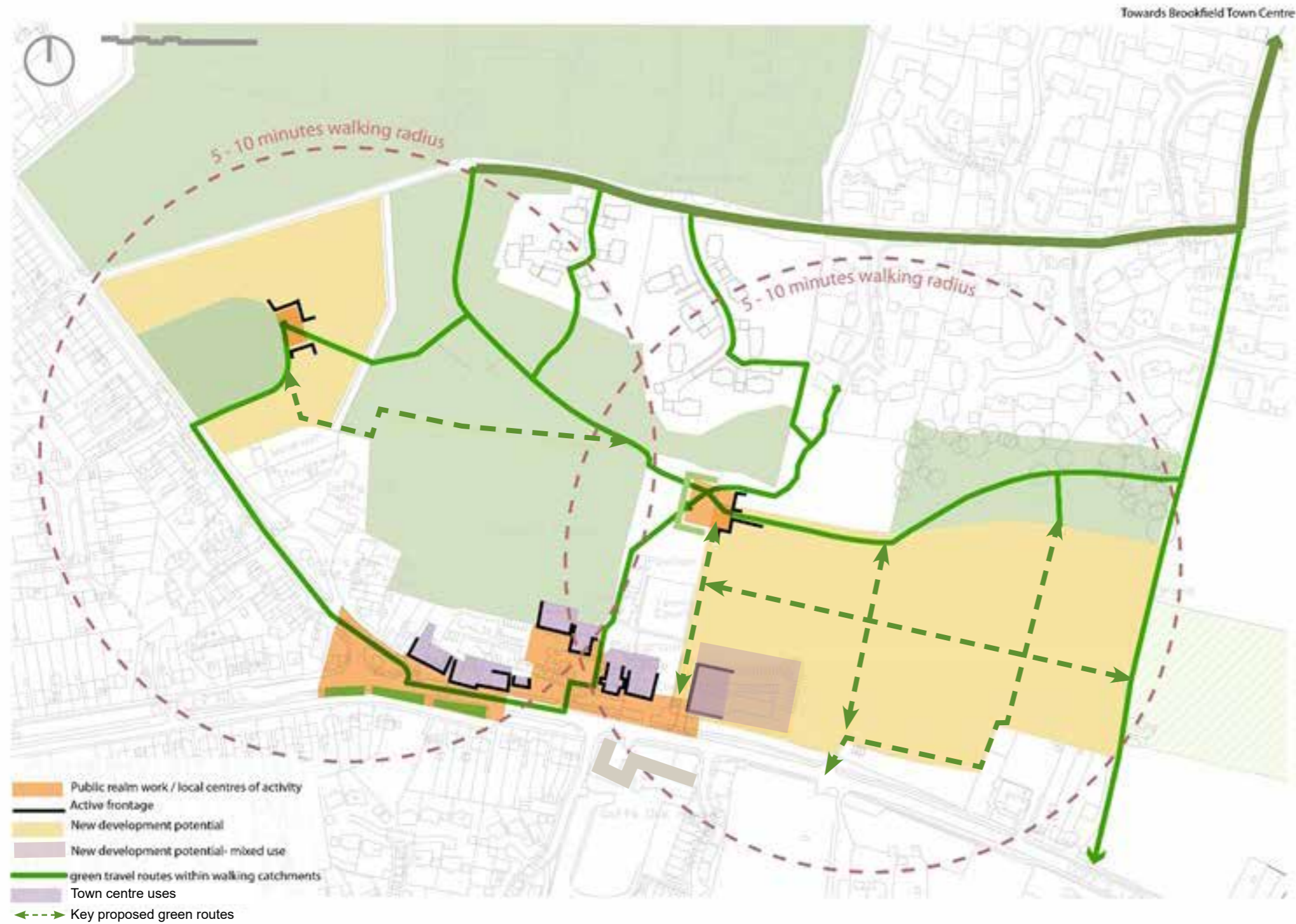

Goff's Oak village centre is within a 5 minute catchment of nearby shopping parades and community facilities. By providing ample car parking spaces in close proximity to the village centre, residents can drive into Goff's Oak and access all nearby facilities by foot.

Goff's Oak improvement plan

Option updates

Option 01

Improvement plan

Total number of village centre parking spaces = 8 spaces
Parking near community facilities = 58 spaces



Option 01

Areas of change



Option 02

Improvement plan

Total number of village centre parking spaces = 12 spaces
Parking near community facilities = 65 spaces

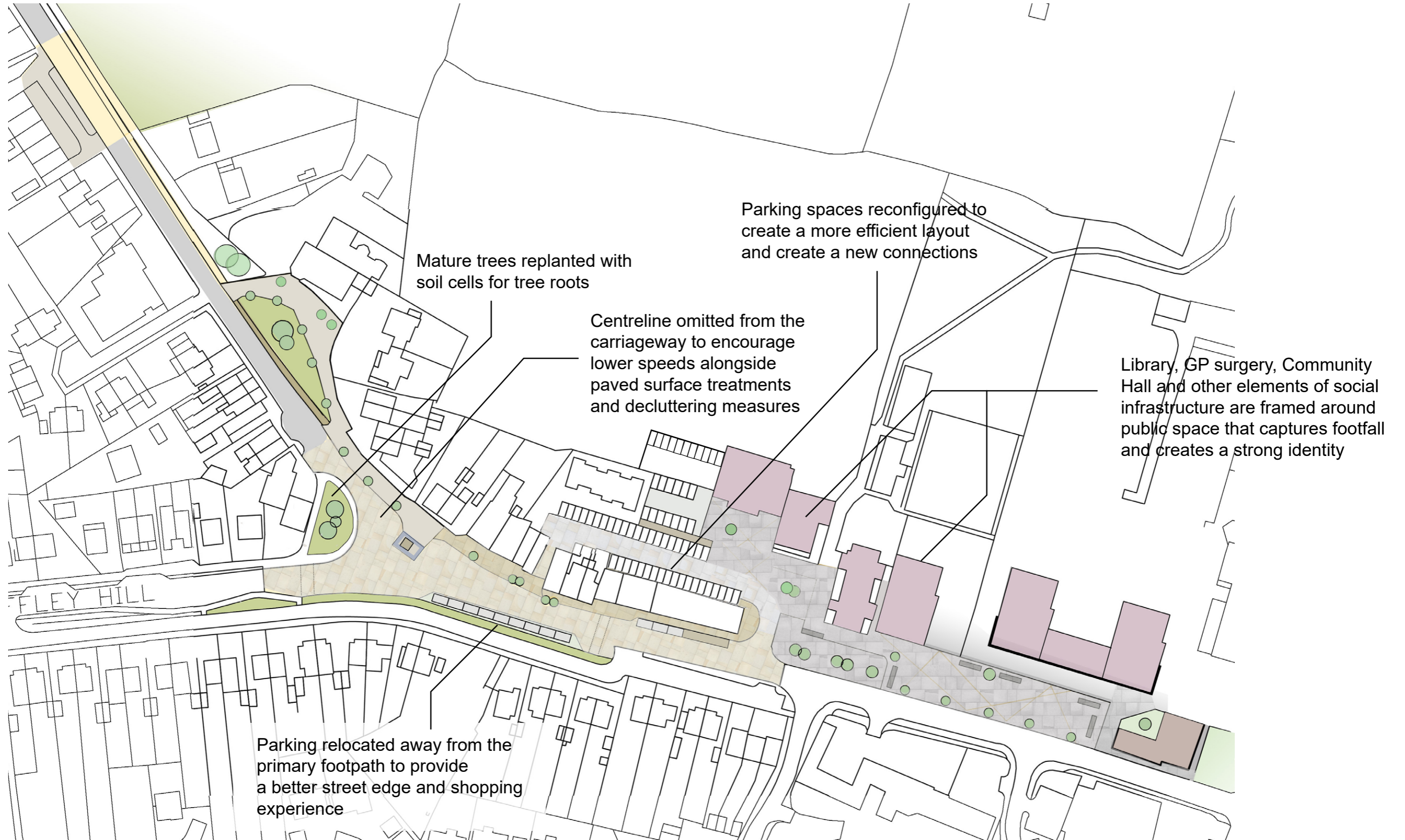

Option 02

Areas of change



Alternative to Maximize Parking

Exploring an increase in parking spaces across the two options

