

**HERTFORDSHIRE COUNTY COUNCIL**  
**ROAD TRAFFIC REGULATION ACT 1984**

Date of Order : 8 November 2013  
Order No : 7736

**THE HERTFORDSHIRE (AMWELL STREET and BREWERY ROAD, HODDESODON)**  
**(PARKING PLACES) ORDER 2013**

The Hertfordshire County Council in exercise of their powers under Sections 32 and 35 of the Road Traffic Regulation Act 1984 (which said Act of 1984 is hereinafter referred to as "the Act of 1984"), and Part IV of Schedule 9 of the Act of 1984 and of all other enabling powers and after consultation with the Chief Officer of Police in accordance with Part III of Schedule 9 of the Act of 1984, hereby makes the following Order:-

1. This Order may be cited as "The Hertfordshire (Amwell Street and Brewery Road, Hoddesdon) (Parking Places) Order 2013" and shall come into operation on Monday 18 November 2013.
2. Save as provided in Articles 4 and 5 of this Order those lengths of Amwell Street and Brewery Road, Hoddesdon specified in the Schedule to this Order are authorised for use as parking places between 9.00am and 6.00pm Monday to Saturday limited to 1 hour waiting with no return within the next 2 hours.
3. Save as provided in Article 4 of this Order where in Article 2 of this Order a length of Amwell Street and Brewery Road, Hoddesdon is described as authorised for use as a parking place between 9.00am and 6.00pm Monday to Saturday limited to 1 hour waiting with no return within the next 2 hours, the driver of a vehicle shall not permit the vehicle to wait in that parking place unless it is wholly parked within the marked limits of the parking place.
- 4(1) Nothing in Articles 2 and 3 of this Order applies to the lengths of road restricted by those Articles (which said lengths of road are referred to in this Article as "the restricted area") in relation to –
  - (a) a vehicle being used for Fire and Rescue, Ambulance or Police purposes.
  - (b) Anything done with the permission of or at the direction of a Police Constable in uniform; or with permission of a Civil Enforcement Officer as defined by the Traffic Management Act 2004 and appointed by Broxbourne Borough Council.
  - (c) a vehicle which is prevented from proceeding by circumstances beyond the drivers control or which has stopped in order to avoid injury or damage to persons or property or when required to do so by law;
  - (d) a vehicle which is stationary in order that it may be used for one or more of the purposes specified in sub-Article (2) of this Article and which cannot reasonably be used for such a purpose without stopping in the restricted area;
  - (e) a marked vehicle which, whilst used by a universal service provider in the course of the provision of a universal postal service, is stationary only for so long as may be reasonably necessary for postal packets to be delivered or collected;

In this Article -

The expressions "universal service provider", "provision of a universal postal Service" and "postal packet" shall bear the same meanings as in the Postal Services Act 2000.

(2) The "purposes" referred to in sub-Article (1)(d) of this Article are –

- (a) any operation involving building, demolition or excavation;
- (b) the removal of any obstruction to traffic;
- (c) the maintenance, improvement or reconstruction of a road;
- (d) constructing, improving, maintaining, or cleaning of any street furniture; or
- (e) the laying, erection, alteration, repair or cleaning of any sewer or of any main pipe or apparatus for the supply of gas, water or electricity, or of any telecommunications apparatus kept or installed for the purposes of a telecommunications code system or of any other telecommunications apparatus lawfully kept installed in any position.

5. (1) Nothing in Article 2 of this Order shall render it unlawful to cause or permit a disabled person's vehicle which displays in the relevant position a disabled person's badge, to wait at any time in the lengths of road specified in the Schedule of this Order.

(2) In this Article -

"disabled person's vehicle" has the same meaning as in Section 142(1) of the Act of 1984;

"disabled person's badge" has the same meaning as given in Regulation 3(1) of The Local Authorities' Traffic Orders (Exemptions for Disabled Persons) (England) Regulations 2000

"parking disc" has the same meaning as given in Regulation 8(5) of The Local Authorities' Traffic Orders (Exemptions for Disabled Persons) (England) Regulations 2000; and

"relevant position" has the same meaning as given in Regulation 4 of The Local Authorities' Traffic Orders (Exemptions for Disabled Persons) (England) Regulations 2000

6. The Interpretation Act 1978 shall apply for the interpretation of this Order as it applies for the Interpretation of an Act of Parliament.

7. The provisions of the following Order are hereby revoked only in so far as they are affected by the restrictions imposed by this Order -

The Broxbourne Borough Council (Control of Parking) (Consolidation) Order 2011

8. The restrictions imposed by this Order shall be in addition to and not in derogation from any restriction or requirement imposed by any other regulations made or having effect as if made under the act of 1984 or by any other enactment.

#### SCHEDULE

lengths of Amwell Street and Brewery Road, Hoddesdon - designated parking places 9.00am to 6.00pm Monday to Saturday limited to 1 hour waiting with no return within the next 2 hours

Amwell Street (west side) from a point 8 metres south of a point in line with the south east kerbline of Pauls Lane southwards for 11 metres.

Brewery Road (north east side) a) from a point 10 metres north west of a point in line with the boundary between 1 and 2 Christies Court south eastwards for 20 metres.

b) from a point 12 metres north west of a point in line with the boundary between 3 and 4 Christies Court south eastwards for 13.5 metres.

IN WITNESS whereof the Common Seal of the Hertfordshire County Council was hereunto affixed this 8<sup>th</sup> day of November 2013.

The Common Seal of Hertfordshire County Council was hereunto affixed in the presence of:-

)  
)  
)  
)

1349/13

Kathryn Pettitt

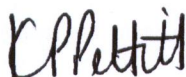

**Chief Legal Officer**



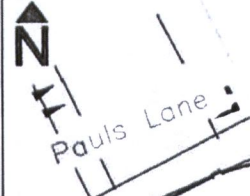

New parking bays to be installed with following restrictions: Bays to be Monday to Saturday 9AM to 6:00PM, 1 hour parking, no return within 2 hours

No waiting and No loading at any time

No waiting and No loading at any time

No waiting and No loading at any time

New bus stop, No parking, no waiting and no loading 7 days a week at any time

Arweil Street

BUS STOP



No waiting and No loading at any time

BUS STOP

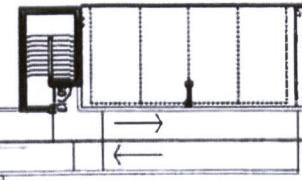
No waiting and No loading at any time



**Key (road markings):**

-  Proposed Double Yellow Lines - No Waiting, No Loading At Any Time
-  Parking Places Mon-Sat 9AM-6:00PM 1 hr parking, no return within next 2 hrs

Cut Line Drawing No: OA/ITP1.3068/2/1200/008  
 Drawing No: OA/ITP1.3068/2/1200/009

Cut Line Drawing No: OA/ITP1.3068/2/1200/008  
 Drawing No: OA/ITP1.3068/2/1200/009

Cut Line Drawing No: OA/ITP1.3068/2/1200/010  
 Drawing No: OA/ITP1.3068/2/1200/009

No waiting, No loading at any time

High Street

**DRAFT**





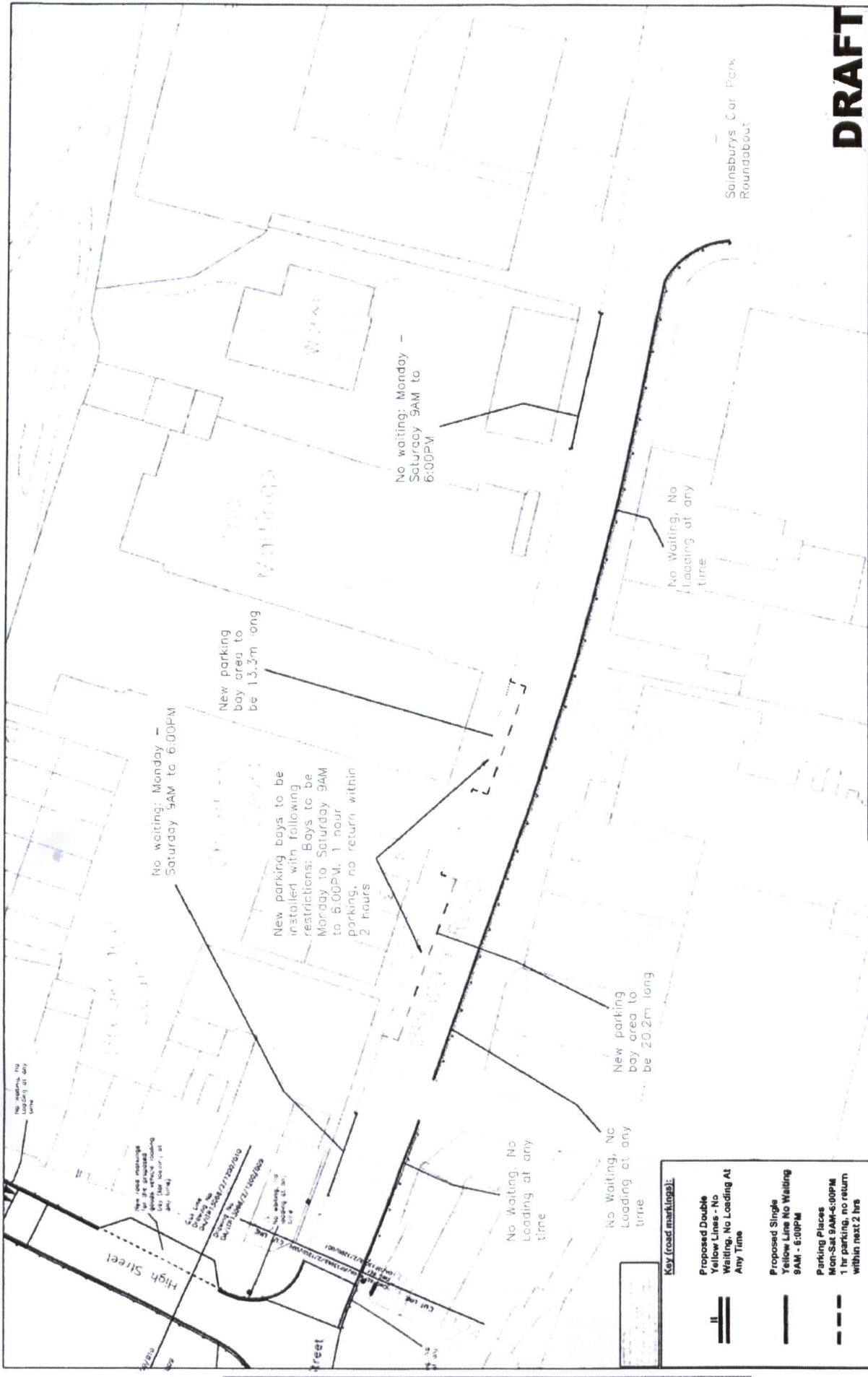

COUNTY HALL  
 Pigs Lane  
 Hereford Herefs  
 SG13 8DA  
 Phone: 01932 355865

Sainsbury's Car Park Roundabout

**DRAFT**

**Key (road markings)**

	Proposed Double Yellow Lines - No Waiting, No Loading At Any Time
	Proposed Single Yellow Line No Waiting 9AM - 6:00PM
	Parking Places Mon-Sat 9AM-6:00PM 1 hr parking, no return within next 2 hrs

© Crown Copyright and Database Right 2012 Ordnance Survey 100020426

Not to be printed or copied without permission of the City of Southampton. This document is for the use of the City of Southampton only. It is not to be used for any other purpose.

COUNTY HILL  
 Page 1889  
 Hurdwood Park  
 SO10 8PS  
 Phone: 01703 505555



11  
 0 5 10 15 20 25 30 35 40 45 50 55 60 65 70 75 80 85 90 95 100

1:1000

Fig. 148

## HERTFORDSHIRE COUNTY COUNCIL

THE HERTFORDSHIRE (VARIOUS ROADS, HODDESDON) (PROHIBITION OF STOPPING AND RESTRICTION OF WAITING) ORDER 2013

THE HERTFORDSHIRE (AMWELL STREET and BREWERY ROAD, HODDESDON) (PARKING PLACES) ORDER 2013

THE HERTFORDSHIRE (HIGH STREET, HODDESDON) (GOODS VEHICLE LOADING BAY) ORDER 2013

THE HERTFORDSHIRE (AMWELL STREET, HIGH STREET, BURFORD STREET AND BREWERY ROAD, HODDESDON) (PROHIBITION OF STOPPING AND WAITING ON FOOTWAYS) ORDER 2013

THE HERTFORDSHIRE (BREWERY ROAD, HODDESDON) (PROHIBITION OF ENTRY EXCEPT BUSES AND PEDAL CYCLES) ORDER 2013

THE HERTFORDSHIRE (AMWELL STREET, HIGH STREET, BURFORD STREET, BREWERY ROAD, BROCKET ROAD AND CONDUIT LANE, HODDESDON) (20MPH SPEED LIMIT) ORDER 2013

NOTICE is given that the Hertfordshire County Council has made Orders under the Road Traffic Regulation Act 1984 to introduce waiting restrictions, parking places, goods vehicle loading bay, no stopping and waiting on footways, no entry and a 20mph speed limit on various roads in Hoddesdon as specified in the Schedules to this Notice. The Orders will come into effect on Monday 18 November 2013.

Documents giving more detailed particulars of the Orders may be inspected from 14 November 2013 to 27 December 2013 during normal office hours at the offices of Broxbourne Borough Council, Bishops College, Churchgate, Cheshunt and at Main Reception, Hertfordshire County Council, County Hall, Pegs Lane, Hertford or viewed at [www.hertsdirect.org/trafficorders](http://www.hertsdirect.org/trafficorders) by clicking on the relevant local area (Quoting Ref: B/004-011/13)

Enquiries relating to the Order should be referred to the Highways Engineer concerned Martin Sears tel: 01992 658269 or [martin.sears@hertfordshire.gov.uk](mailto:martin.sears@hertfordshire.gov.uk)

Any person wishing to question the validity of the Orders, or of any provision contained in them, on the grounds that it is not within the powers conferred by the Road Traffic Regulation Act 1984, or on the grounds that any requirement of the Act or any Instrument made under it has not been complied with in relation to the Orders, may within 6 weeks from the date of this Notice apply to the High Court for this purpose.

**SCHEDULE 1:** No waiting, loading or unloading at any time – those sections of road listed below and as set out in the Order and accompanying plan – parts of Pauls Lane, Amwell Street, High Street, Burford Street and Brewery Road, Hoddesdon

**SCHEDULE 2:** No waiting 9.00am to 6.00pm Monday to Saturday – those sections of road listed below and as set out in the Order and accompanying plan – parts of Brewery Road, Hoddesdon

**SCHEDULE 3:** Parking places 9.00am to 6.00pm Monday to Saturday limited to 1 hour waiting with no return within the next 2 hours – those sections of road listed below and as set out in the Order and accompanying plan – Parts of Amwell Street and Brewery Road, Hoddesdon

**SCHEDULE 4:** Goods Vehicle Loading Bay at any time – that section of road listed below and as set out in the Order and accompanying plan – part of High Street, Hoddesdon

**SCHEDULE 5:** Prohibition of Stopping and Waiting on Footways – those sections of footway listed below and as set out in the Order and accompanying plan – parts of Amwell Street, High Street and Burford Street, Hoddesdon

**SCHEDULE 6:** Prohibition of Entry Except Buses and Pedal Cycles – that section of road listed below and as set out in the Order and accompanying plan – Brewery Road, Hoddesdon from Sainsburys Car Park Roundabout

**SCHEDULE 7:** 20mph speed limit - those sections of road listed below and as set out in the Order and accompanying plan – Parts of Amwell Street, High Street, Burford Street, Brewery Road, Brocket Road and Conduit Lane, Hoddesdon

County Hall  
Hertford  
Herts SG13 8DN

14 November 2013  
John Wood  
Chief Executive & Director of Environment

**STATEMENT OF REASONS FOR PROPOSING  
THE HERTFORDSHIRE (AMWELL STREET and BREWERY ROAD, HODDESDON)  
(PARKING PLACES) ORDER 2013**

The Hertfordshire County Council in conjunction with Broxbourne Borough Council is currently preparing proposals for Hoddesdon Town Centre in order to improve road safety on various roads within the Town Centre.

The proposals include: –

- 'Parking Places' 9.00am to 6.00pm Monday to Saturday limited to 1 hour waiting no return within the next 2 hours in Amwell Street and Brewery Road, Hoddesdon

The proposals are to address safety and access concerns due to current on road parking habits and vehicles parking at junctions and along the lengths of the roads currently restrict visibility and access. The limited waiting will allow for parking for the nearby shops, local amenities and access to the Town Centre.

It therefore appears to the Highway Authority having also considered the duty imposed under Section 122 Road Traffic Regulation Act 1984 that it is necessary and expedient to make the Order in the interests of highway safety for avoiding danger to persons or other traffic using the road and for preventing the likelihood of such danger arising. It is also for preserving or improving the amenities of the area through which the road runs and to prevent or relieve congestion on the highway.

All the proposed measures have been subject to consultation with local and County Councillors representing the area and Broxbourne Borough Council. The local Police, Fire and Rescue Services, Hertfordshire County Council Passenger Transport Unit, local residents have also been consulted.