

BOROUGH OF BROXBOURNE
ROAD TRAFFIC REGULATION ACT 1984

THE BOROUGH OF BROXBOURNE (VARIOUS ROADS)
(DISABLED PERSONS' PARKING PLACES) ORDER 2012

THE COUNCIL OF THE BOROUGH OF BROXBOURNE, pursuant to arrangements made with the Hertfordshire County Council under Section 19 of the Local Government Act 2000 and the Local Government (Arrangements for Discharge of Functions) (England) Regulations 2000, and in exercise of its powers under Sections 32 and 35 of the Road Traffic Regulation Act 1984, (hereinafter called "the 1984 Act") and of all other enabling powers, and after consultation with the Chief Officer of Police in accordance with Part III of Schedule 9 of the Act of 1984, hereby make the following Order:

1(1) In this Order

"Disabled Person's Badge" has the same meaning as in The Local Authorities' Traffic Orders (Exemptions for Disabled Persons) (England) Regulations 2000.

"Disabled Person's Vehicle" has the same meaning as in Section 142(1) of the 1984 Act

"driver", in relation to a vehicle waiting in a parking place, means the person driving the vehicle at the time it was left in the parking place

"parking place" means any part of a road authorised by this Order to be used as a parking place

- (2) For the purposes of this Order a vehicle shall be regarded as displaying a Disabled Person's Badge in the relevant position if:
- (i) in the case of a vehicle fitted with a dashboard or fascia panel, the badge is exhibited thereon so that the serial number and the date of expiry of the badge is legible from outside the vehicle; or
 - (ii) in the case of a vehicle not fitted with a dashboard or fascia panel, the badge is exhibited in a conspicuous position on the vehicle so that the serial number and the date of expiry of the badge is legible from outside the vehicle.
- 2(1) Those parts of the roads specified in Column 1 of Schedule 1 to this Order are authorised to be used in a position specified in Column 2 of the said Schedule 1 and subject to the following provisions of this Order, as parking places at any time for Disabled Person's Vehicles which display in the relevant position a Disabled Person's Badge.
- (2) Nothing in paragraph (1) of this Article shall restrict the power of the Council, for preventing obstruction of the roads, by order, or by notice on the occasion of any public procession, rejoicing or illumination, or when the roads are thronged or liable to be obstructed, to close the parking place.
- 3 Where in Column 1 of Schedule 1 to this Order a parking place is described as available for a Disabled Person's Vehicle which displays in the relevant position a Disabled Person's Badge, the driver of a vehicle shall not permit it to wait in that parking place unless it is:

- (a) a Disabled Person's Vehicle on which is displayed in the relevant position a Disabled Persons Badge, and
 - (b) wholly within the limits of the parking place.
- 4 A driver of a vehicle shall not use a parking place:-
 - (a) so as unreasonably to prevent access to any premises adjoining the road, or the use of the road by other persons, or so as to be a nuisance;
 - (b) when for preventing obstruction of the road the Council shall by order or by notice made on the occasion of any public procession, rejoicing or illumination or when the roads are thronged or liable to be obstructed have closed that parking place and exhibited notice of such closing on or near the parking place.
- 5 The driver of a motor vehicle using a parking place shall stop the engine as soon as the vehicle is in a position in the parking place, and shall not start the engine except when about to change the position of the vehicle in or to depart from the parking place.
- 6 No person shall use a vehicle, while it is in a parking place, in connection with the sale of any article to persons in or near the parking place or in connection with the selling or offering for hire of his skill or service.
- 7 Subject to the provision hereto, when a vehicle is left in a parking place in contravention of any of the provisions contained in Articles 3 and 4 of this Order a person authorised in that behalf by the Council may remove the vehicle or arrange for it to be removed from that parking place provided that when a vehicle is waiting in a parking place in contravention of the provisions of Articles 3 and 4 of this Order, a person authorised in that behalf by the Council may alter or cause to be altered the position of the vehicle in order that its position shall comply with that provision.
- 8 Any person removing a vehicle or altering its position by virtue of the last preceding Article of this Order may do so by towing or driving the vehicle or in such other manner as he may think necessary and may take such measures in relation to the vehicle as he may think necessary to enable him to remove it or alter its position, as the case may be.
- 9 When a person authorised by the Council removes or makes arrangements for the removal of a vehicle from a parking place by virtue of Article 7 of this Order, he shall make such arrangements as may be reasonably necessary for safe custody of the vehicle.
- 10 The provisions of the following Order are hereby revoked but only in so far as they are affected by the restrictions imposed by this Order, The Borough of Broxbourne (Control of Parking) (Consolidation) Order 2008.
- 11 Paragraph 20 of Schedule 1 to the Borough of Broxbourne (Various Roads) (Disabled Persons Parking Places) Order 2008 is hereby revoked.
- 12 Paragraph 16 of Schedule 1 to the Borough of Broxbourne (Various Roads) (Disabled Persons Parking Places) Order No.2 2008 is hereby revoked.
- 13 Paragraph 8 of Schedule 1 to the Borough of Broxbourne (Various Roads) (Disabled Persons Parking Places) Order No.2 2010 is hereby revoked.

- 14 Paragraphs 3 & 19 of Schedule 1 to the Borough of Broxbourne (Various Roads) (Disabled Persons Parking Places) Order No.2 2011 are hereby revoked.
- 15 This Order shall come into operation on the 3rd May 2012 and may be cited as the Borough of Broxbourne (Various Roads) (Disabled Person's Parking Places) 2012.

SCHEDULE 1

Column 1	Column 2
Description of the parking place	Position in which the vehicle may wait
1 Brampton Close, CHESHUNT west side from a point 15.85m north east of a point in line with the southern flank wall of Nos.61- 63 Brampton Close northeastward for a distance of 2.8m	Lengthwise at 90° to the kerb in a North West / South East direction
2 Flamstead End Road, CHESHUNT east side from a point 0.7m north of a point in line with the southern flank wall of No.38 Flamstead End Road northwards for a distance of 2.6 metres	Lengthwise at 90° to the kerb in a East / West direction
3 High Street, CHESHUNT East side from a point 9.75m south of a point in line with the boundary between Nos. 74 & 76 High Street southwards for a distance of 2.9m	Lengthwise at 90° to the kerb in a East / West direction
4 Wavell Close, CHESHUNT east side from a point 1.55m south of a point in line the boundary between Nos. 14 & 16 Wavell Close southward for a distance of 4.9 metres	Parallel and adjacent to the kerb
5 Castle Close, HODDESDON south west side from a point in line with the boundary between Nos. 2 & 4 Castle Close northwestward for a distance of 6 metres	Parallel and adjacent to the kerb
6 Hawthorn Road, HODDESDON north side from a point in line with the boundary between Nos. 40 & 42 Hawthorn Road westward for a distance of 6 metres	Parallel and adjacent to the kerb
7 Ogard Road, HODDESDON west side from a point 7.7m south of a point in line with the northern flank wall of Nos.47 – 51 Ogard Road southwards for a distance of 2.4m	Lengthwise at 90° to the kerb in a Northeast / Southwest direction

- | | | |
|----|-----------------------------------------------------------------------------------------------------------------------------------------------------------------------------------------------------------|------------------------------------------------------------|
| 8 | Southern Car Park Section, Stanstead Road, HODDESDON southeast side from a point 4.6m south east of a point in line with the northern flank wall of No.64 Stanstead Road eastwards for a distance of 2.3m | Lengthwise at 45° to the kerb in a North / South direction |
| 9 | Whitehands Close, HODDESDON north side from a point in line with the western flank wall of Nos.7 – 8 Whitehands Close eastward for a distance of 5.6m | Parallel and adjacent to the kerb |
| 10 | Winterscroft Road, HODDESDON North side from a point in line with northern flank wall of No.84 westwards for a distance of 2.5m | Lengthwise at 90° to the kerb in a North / South direction |
| 11 | Juniper Close, TURNFORD west side from a point in line with the southern flank wall of Nos.61-71 Juniper Close southward for a distance of 1.9m | Lengthwise at 90° to the kerb in a East / West direction |
| 12 | Rowan Drive, TURNFORD north side from a point in line with the boundary between Nos. 32 & 34 Rowan Drive, and to the rear of Nos. 32 – 34 Rowan Drive, westward for a distance of 6m | Parallel and adjacent to the kerb |
| 13 | Fishers Close, WALTHAM CROSS east side from a point 13.65m north of a point in line with the southern flank wall of Nos.113-143 Fishers Close northward for a distance of 6.0m | Parallel and adjacent to the kerb |
| 14 | Kenworth Close, WALTHAM CROSS north side from a point in line with the boundary between Nos. 3 & 5 Kenworth Close eastward for a distance of 6m | Parallel and adjacent to the kerb |
| 15 | Sterling Avenue, WALTHAM CROSS west side from a point in line with the boundary between Nos. 20 & 22 Sterling Avenue northward for a distance of 6m | Parallel and adjacent to the kerb |
| 16 | Clyfton Close, WORMLEY south side from a point 0.5m east of a point in line with the boundary between Nos. 59 & 61 Clyfton Close westward for a distance of 6.0m | Parallel and adjacent to the kerb |
| 17 | Fairfield Drive, WORMLEY southside from a point 6.55m west of a point in line with the western flank wall of No.60 Macers Court westward for a distance of 2.4m | Lengthwise at 90° to the kerb in a North / South direction |

SCHEDULE 2

Column 1

Description of the parking place

- 1 Dewhurst Road, CHESHUNT north side from a point in line with the boundary between Nos.59 & 61 Dewhurst Road eastwards for a distance of 5.3 metres
- 2 Dewhurst Road, CHESHUNT south side from a point in line with the boundary of Nos.62/64 Dewhurst Road eastwards for a distance of 6 metres
- 3 Gews Corner, CHESHUNT, east side from a point in line with the boundary between Nos. 13 &14 southwards for a distance of 6 metres.
- 4 Grovedale Close, CHESHUNT east side, from a point in line with a point 18 metres south of the southernmost flank wall of No. 54, southwards for a distance of 2.5 metres.
- 5 Pengelly Close, CHESHUNT south side, from a point in line with a point 19 metres east of the western flank wall of No. 56, eastwards for a distance of 6 metres.
- 6 Hawthorn Road, HODDESDON north side from a point in line with the boundary of Nos. 16 & 18 Hawthorn Road westwards for a distance of 6 metres
- 7 Old Highway, HODDESDON east side from a point in line with the boundary between Nos.138 & 140 north westwards for a distance of 6 metres.
- 8 Perram Close, TURNFORD west side from a point 11 metres west of a point in line with the eastern flank wall of Nos. 9 & 10 northwards for a distance of 2.4 metres.
- 9 Central Avenue, WALTHAM CROSS west side from a point in line with the boundary of between Nos.33 & 35 northwards for a distance of 6 metres.
- 10 Eleanor Road, WALTHAM CROSS north side from a point in line with the eastern flank wall of No 63 eastwards for a distance of 6 metres.
- 11 Raglan Avenue, WALTHAM CROSS west side from a point 5m north of a point in line with the boundary between Nos. 33 & 35 Raglan Avenue northwards for a distance of 6m

IN WITNESS whereof the Common Seal of the Council of the Borough of Broxbourne has hereunto been affixed on this 30th April 2012

The Common Seal of the COUNCIL OF THE BOROUGH OF BROXBOURNE was hereunto affixed in the presence of:-



M. J. Walker
Chief Executive Officer

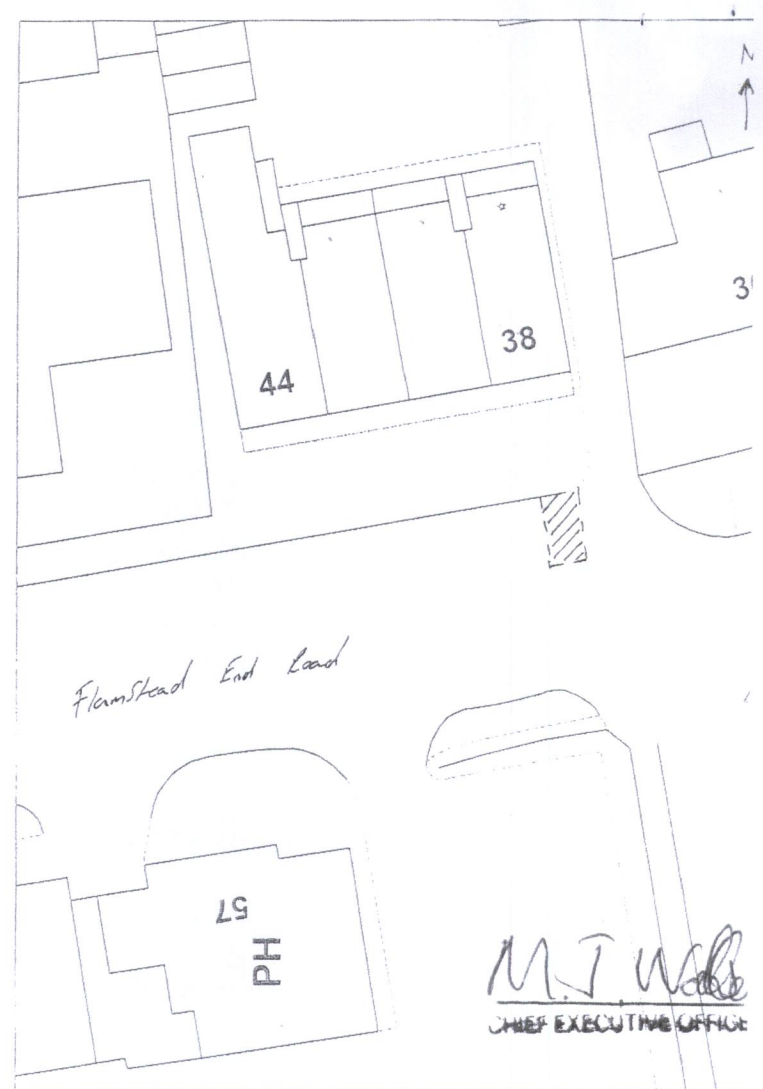

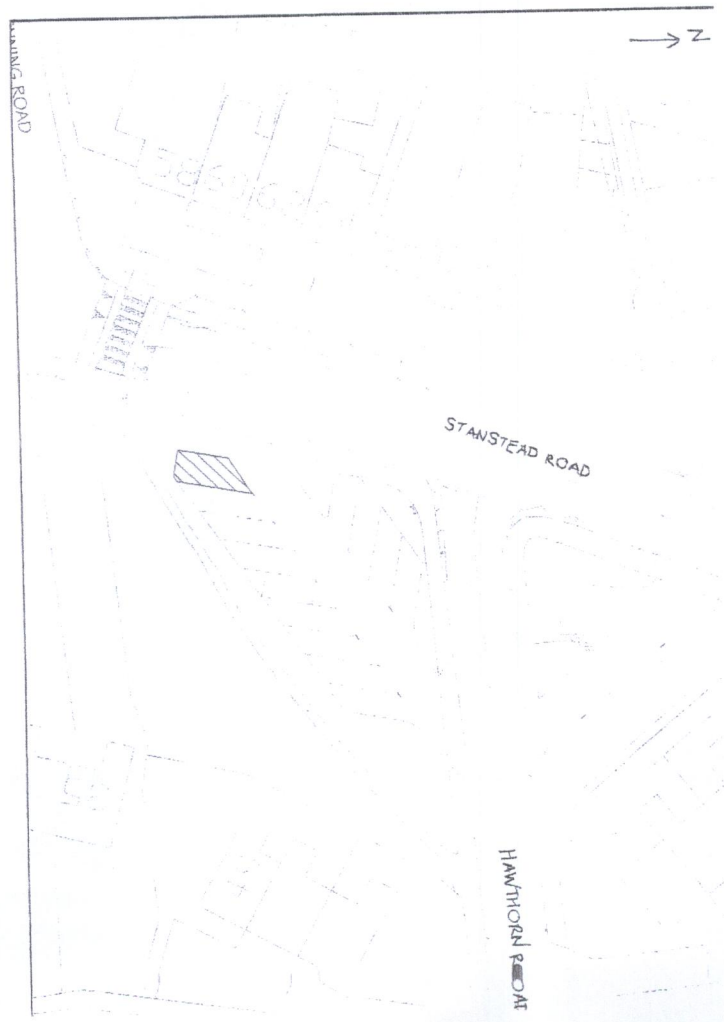
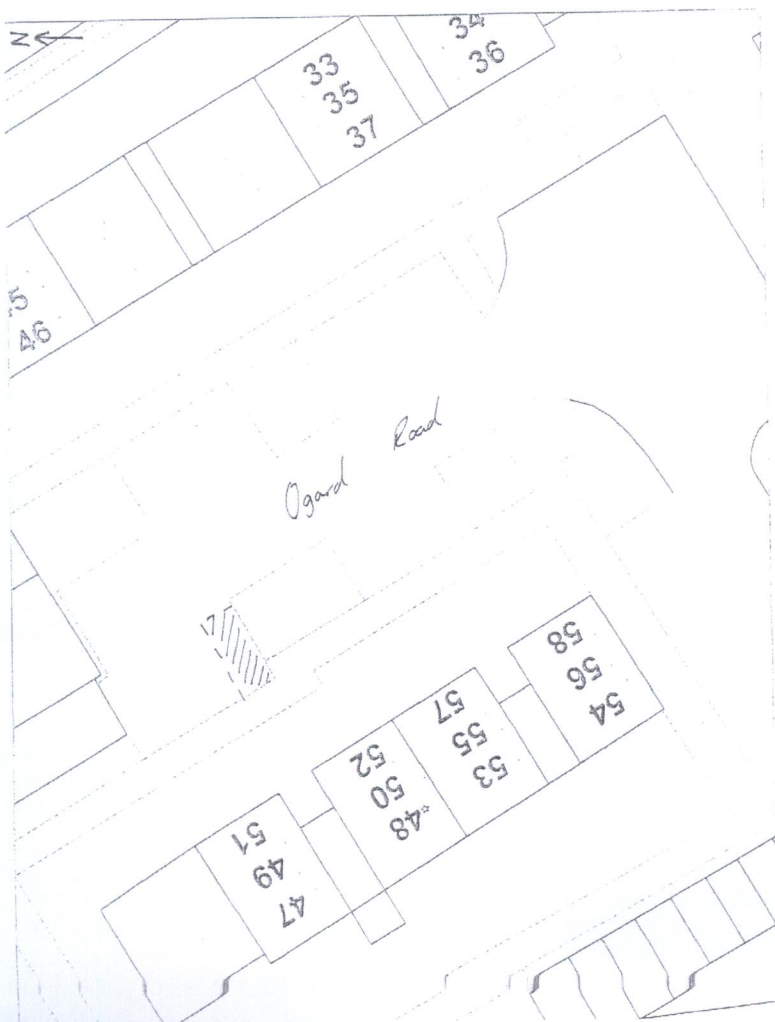

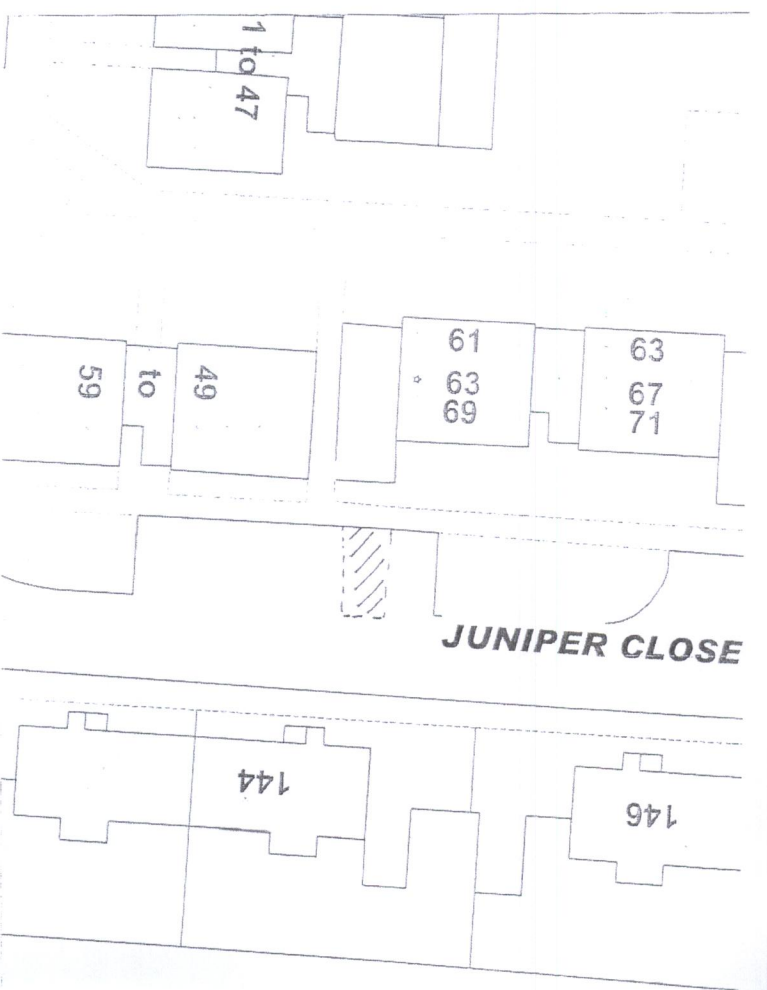



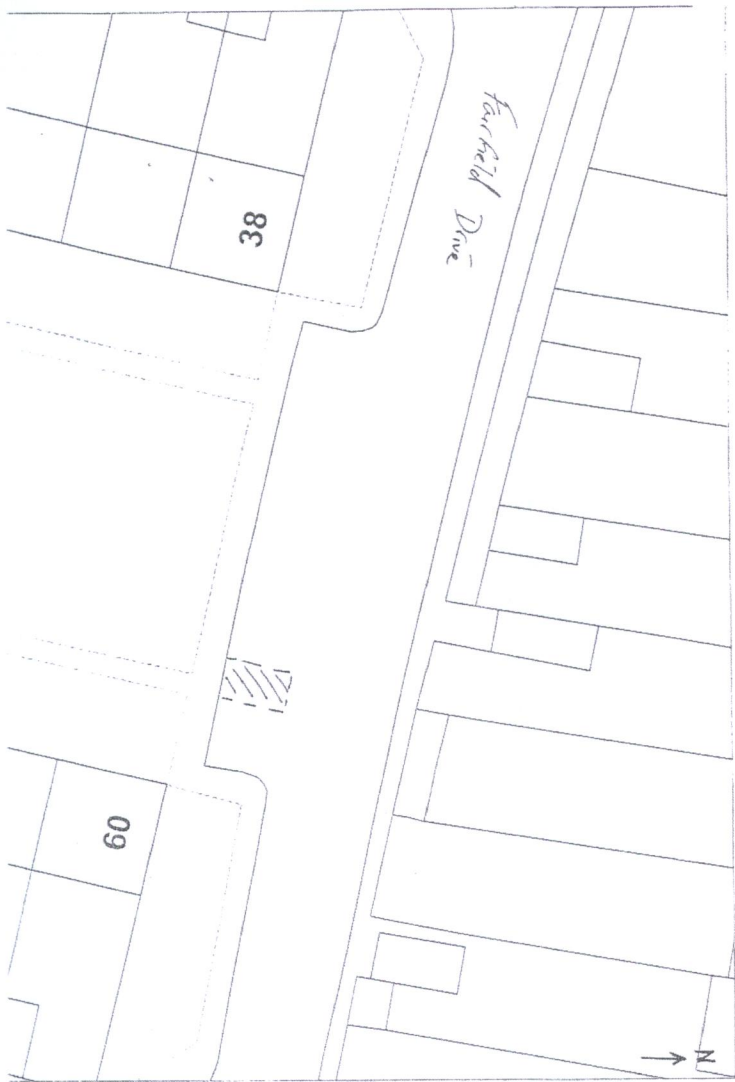

M. J. Walker
CHIEF EXECUTIVE OFFICER

Dated 30th April 2012

ROAD TRAFFIC REGULATION ACT 1984

THE BOROUGH OF BROXBOURNE
(VARIOUS ROADS) (DISABLED
PERSONS PARKING PLACES)
ORDER 2012