

BOROUGH OF BROXBOURNE
ROAD TRAFFIC REGULATION ACT 1984

THE BOROUGH OF BROXBOURNE (VARIOUS ROADS)
(DISABLED PERSONS' PARKING PLACES) ORDER No. 2 2013

THE COUNCIL OF THE BOROUGH OF BROXBOURNE, pursuant to arrangements made with the Hertfordshire County Council under Section 19 of the Local Government Act 2000 and the Local Authorities (Arrangements for the Discharge of Functions) (England) Regulations 2000, and in exercise of its powers under Sections 32 and 35 of the Road Traffic Regulation Act 1984, (hereinafter called "the 1984 Act") and of all other enabling powers, and after consultation with the Chief Officer of Police in accordance with Part III of Schedule 9 of the Act of 1984, hereby make the following Order:

1(1) In this Order

"Disabled Person's Badge" has the same meaning as in The Local Authorities' Traffic Orders (Exemptions for Disabled Persons) (England) Regulations 2000.

"Disabled Person's Vehicle" has the same meaning as in Section 142(1) of the 1984 Act

"Driver", in relation to a vehicle waiting in a Parking Place, means the person driving the vehicle at the time it was left in the Parking Place

"Parking Place" means any part of a road authorised by this Order to be used as a parking place

(2) For the purposes of this Order a vehicle shall be regarded as displaying a Disabled Person's Badge in the relevant position if:

- (i) in the case of a vehicle fitted with a dashboard or fascia panel, the badge is exhibited thereon so that the serial number and the date of expiry of the badge is legible from outside the vehicle; or
- (ii) in the case of a vehicle not fitted with a dashboard or fascia panel, the badge is exhibited in a conspicuous position on the vehicle so that the serial number and the date of expiry of the badge is legible from outside the vehicle.

2(1) Those parts of the roads specified in Column 1 of Schedule 1 to this Order are authorised to be used in a position specified in Column 2 of the said Schedule 1 and subject to the following provisions of this Order, as Parking Places at any time for Disabled Person's Vehicles which display in the relevant position a Disabled Person's Badge.

(2) Nothing in paragraph (1) of this Article shall restrict the power of the Council, for preventing obstruction of the roads, by order, or by notice on the occasion of any public procession, rejoicing or illumination, or when the roads are thronged or liable to be obstructed, to close the Parking Place.

3 Where in Column 1 of Schedule 1 to this Order a Parking Place is described as available for a Disabled Person's Vehicle which displays in the relevant position a Disabled Person's Badge, the Driver of a vehicle shall not permit it to wait in that Parking Place unless it is:

- (a) a Disabled Person's Vehicle on which is displayed in the relevant position a Disabled Person's Badge, and
- (b) wholly within the limits of the Parking Place.

- 4 A Driver of a vehicle shall not use a Parking Place:-
- (a) so as unreasonably to prevent access to any premises adjoining the road, or the use of the road by other persons, or so as to be a nuisance;
 - (b) when for preventing obstruction of the road the Council shall by order or by notice made on the occasion of any public procession, rejoicing or illumination or when the roads are thronged or liable to be obstructed have closed that Parking Place and exhibited notice of such closing on or near the Parking Place.
- 5 The Driver of a motor vehicle using a Parking Place shall stop the engine as soon as the vehicle is in a position in the Parking Place, and shall not start the engine except when about to change the position of the vehicle in or to depart from the Parking Place.
- 6 No person shall use a vehicle, while it is in a Parking Place, in connection with the sale of any article to persons in or near the Parking Place or in connection with the selling or offering for hire of his skill or service.
- 7 Subject to the provision hereto, when a vehicle is left in a Parking Place in contravention of any of the provisions contained in Articles 3 and 4 of this Order a person authorised in that behalf by the Council may remove the vehicle or arrange for it to be removed from that Parking Place provided that when a vehicle is waiting in a Parking Place in contravention of the provisions of Articles 3 and 4 of this Order, a person authorised in that behalf by the Council may alter or cause to be altered the position of the vehicle in order that its position shall comply with that provision.
- 8 Any person removing a vehicle or altering its position by virtue of Article 7 of this Order may do so by towing or driving the vehicle or moving the vehicle in such other manner as he may think necessary and may take such measures in relation to the vehicle as he may think necessary to enable him to remove it or alter its position, as the case may be.
- 9 When a person authorised by the Council removes or makes arrangements for the removal of a vehicle from a Parking Place by virtue of Article 7 of this Order, he shall make such arrangements as may be reasonably necessary for safe custody of the vehicle.
- 10 The lengths of road specified in Schedule 2 of this Order are no longer authorised for the sole parking of disabled persons vehicles.
- 11 The provisions of The Borough of Broxbourne (Control of Parking) (Consolidation) Order 2011 ("the 2011 Order") are hereby revoked but only in so far as they affected by the restrictions imposed by this Order.
- 12 Paragraph 7 of Schedule 1 of the Borough of Broxbourne (Various Roads) (Disabled Persons Parking Places) Order 2011 is revoked.
- 13 Paragraph 1 of Schedule 1 of the Borough of Broxbourne (Various Roads) (Disabled Persons Parking Places) Order 2012 is revoked.
- 12 This Order shall come into operation on 6th November 2013 and may be cited as the Borough of Broxbourne (Various Roads) (Disabled Persons' Parking Places) Order No. 2 2013.

SCHEDULE 1

Column 1	Column 2
Description of the Parking Place	Position in which the vehicle may wait
1 ALBURY GROVE ROAD, CHESHUNT south side from a point in line with the boundary between Nos. 25 & 27 Albury Grove Road westwards for a distance of 6.0m.	Parallel and adjacent to the kerb
2 COLLEGE ROAD, CHESHUNT north side from a point 1.1m west of a point in line with the boundary between Nos. 48 & 50 College Road westwards for a distance of 5.0m	Parallel and adjacent to the kerb
3 COLLET GARDENS, CHESHUNT west side from a point 7.0m south of a point in line with the eastern corner of No.2 Collet Gardens southwards for a distance of 2.4m	Lengthwise at 90° to the kerb in a East / West direction
4 ELDERBEK, CHESHUNT north side from a point 9.0m east of a point in line with the western flank wall of Nos.30 & 32 Elderbek eastwards for a distance of 2.4m	Lengthwise at 90° to the kerb in a North / South direction
5 BARCLAY COURT, HODDESDON south side from a point 20.5m east of a point in line with the eastern wall of Nos.25 – 36 Barclay Court eastwards for a distance of 2.4m	Lengthwise at 90° to the kerb in a North / South direction
6 THE DRIVE, HODDESDON north side, in parking bay, from a point 14.6m east of a point in line with the western flank wall of No 21 The Drive eastwards for a distance of 2.4m	Lengthwise at 90° to the kerb in a North / South direction
7 WHITEHANDS CLOSE, HODDESDON north side from a point 9.0m east of a point in line with the western flank wall of Nos.15 & 16 Whitehands Close eastwards for a distance of 6.0m	Parallel and adjacent to the kerb
8 ROWAN DRIVE, TURNFORD south side, in parking bay, from a point in line with the eastern flank wall of No.1 Rowan Drive westwards for a distance of 2.4m	Lengthwise at 90° to the kerb in a North / South direction
9 CENTRAL AVENUE, WALTHAM CROSS west side from a point in line with the boundary of Nos.37 & 39 Central Avenue northwards for a distance of 6.0m	Parallel and adjacent to the kerb

- | | | |
|----|---|--|
| 10 | KINGS ROAD, WALTHAM CROSS south side, in parking bay, from a point 1.9m west of a point in line with the boundary of Nos.18 & 20 Kings Road westwards for a distance of 2.5m | Lengthwise at 90° to the kerb in a North / South direction |
| 11 | NORTHFIELD ROAD, WALTHAM CROSS northeast side from a point 2.0m southeast of a point in line with the boundary between Nos.18 & 20 Northfield Road south-eastwards for a distance of 6.0m | Parallel and adjacent to the kerb |

SCHEDULE 2

Description of those parking places to be removed

Churchfields, Broxbourne east side from a point in line with the northern flank wall of No. 20 Churchfields southward for a distance of 6 metres.

Ashbourne Road, Broxbourne north side from a point in line with a point 11.5 metres south east of the easternmost flank wall of No.5 Ashbourne Rd south eastwards for a distance of 6 metres.

St Augustines Drive, Broxbourne west side from a point in line with the northern flank wall of No.9 St Augustines Drive north-eastwards for a distance of 6 metres.

Albermarle Avenue, Cheshunt east side from a point in line with the northern flank wall of Nos.10 to 16 Albermarle Ave southwards for a distance of 6 metres.

Brampton Close, Cheshunt west side from a point 15.8m north east of a point in line with the southern flank wall of Nos.61 – 63 Brampton Close north-eastward for a distance of 2.8m

Kennedy Close, Cheshunt east side from a point in line with a point 1 metre north east of the boundary between No.18 Medcalf Court north-eastwards for a distance of 2.5 metres.

Longmoor, Cheshunt north side from a point in line with a point 1 metre south east of the westernmost flank wall of No.46 Longmoor south-eastwards for a distance of 5 metres.

Rowlands Close, Cheshunt east side from a point 5.5 metres north of the boundary between Nos.72 & 73 Rowlands Close northwards for a distance of 5.5 metres.

Wheatcroft, Cheshunt south side from a point 1.5 metres west of the boundary between Nos.22 & 23 Wheatcroft westwards for a distance of 2.4 metres.

Whitefields Road, Cheshunt west side from a point 1 metre north of the boundary wall between Nos.193 & 195 Whitefields Rd southwards for a distance of 6 metres.

Briscoe Road, Hoddesdon north side from a point in line with the boundary between Nos.46 & 48 Briscoe Rd westwards for a distance of 6 metres.

Burford Street, Hoddesdon west side from a point 1 metre north of the northern flank wall of No.102 Burford St southwards for a distance of 6 metres.

Castle Road, Hoddesdon east side from a point in line with a point 4 metres south east of the northern flank wall of No.53 Castle Rd south-eastwards for a distance of 3 metres.

Cherry Tree Road, Hoddesdon west side from a point 5 metres west of a point in line with the eastern flank wall of No.13 Cherry Tree Rd westwards for a distance of 5 metres.

Hamilton Avenue, Hoddesdon south side from a point 0.7 metres west of the boundary between Nos.9 & 10 Hamilton Avenue eastwards for a distance of 6 metres.

Hawthorn Road, Hoddesdon north side from a point 1m west of a point in line with the western flank wall of No. 24 Hawthorn Rd eastwards for a distance of 6 metres.

Park Road, Hoddesdon south side from a point in line with the boundary wall between Nos. 28 & 30 Park Rd eastwards for a distance of 6 metres.

Rye Road, Hoddesdon north side from a point in line with the boundary between Nos. 96 & 98 Rye Rd westward for a distance of 6 metres

Brickcroft, Turnford west side from a point 1 metre south of the boundary of Nos.3 & 4 Brickcroft southward for a distance of 3 metres

Garner Drive, Turnford west side from a point 2.7 metres south of the boundary between Nos.7 & 9 Garner Drive south-eastwards for a distance of 6 metres.

Cornwall Close, Waltham Cross east side from a point in line with the boundary wall between Nos. 10 & 12 Cornwall Close southwards for a distance of 2 metres.

Park Lane, Waltham Cross north side from a point 3 metres east of a point in line with the boundary wall between Nos.86 & 88 Park Lane westwards for a distance of 6 metres.

Swanfield Road, Waltham Cross north side from a point in line with the boundary between Nos.43 & 45 Swanfield Rd westwards for a distance of 6 metres.

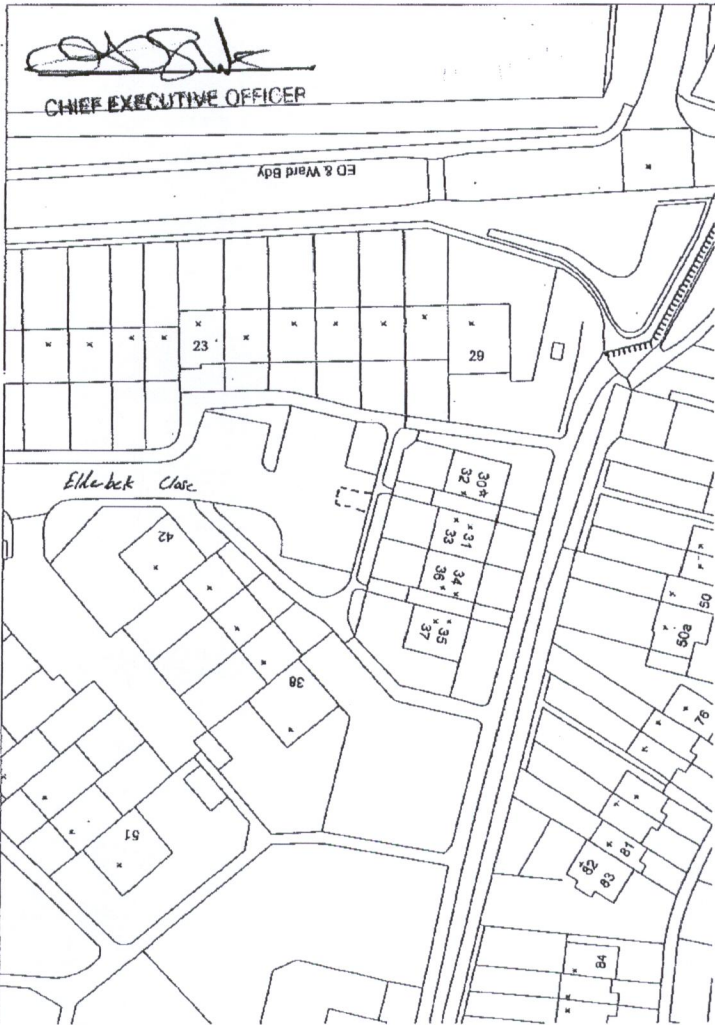
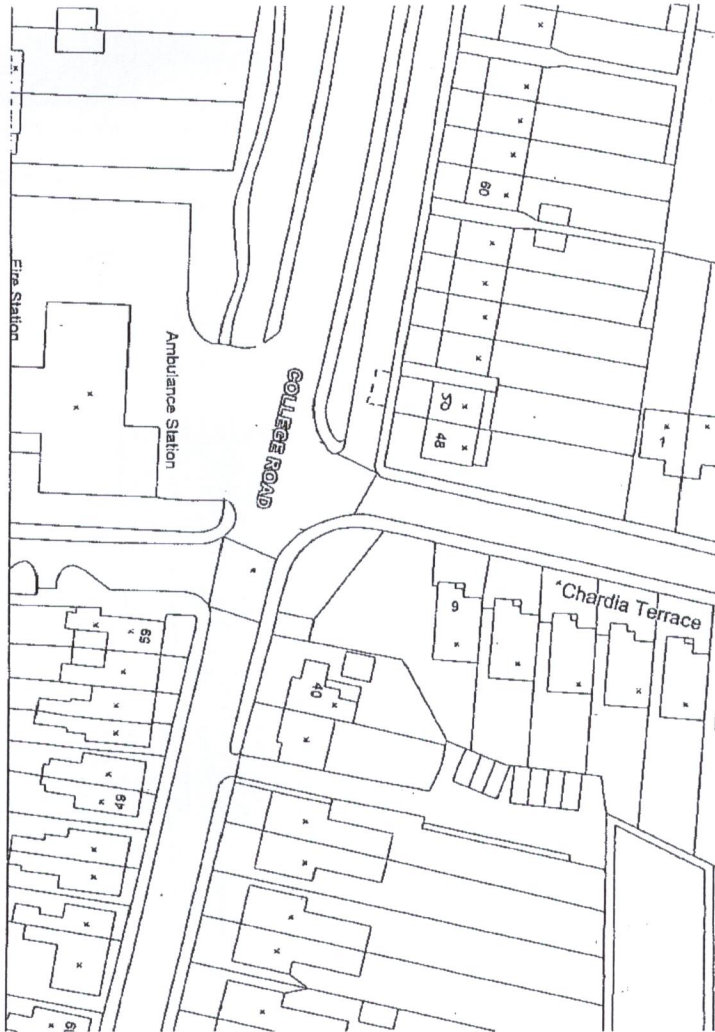

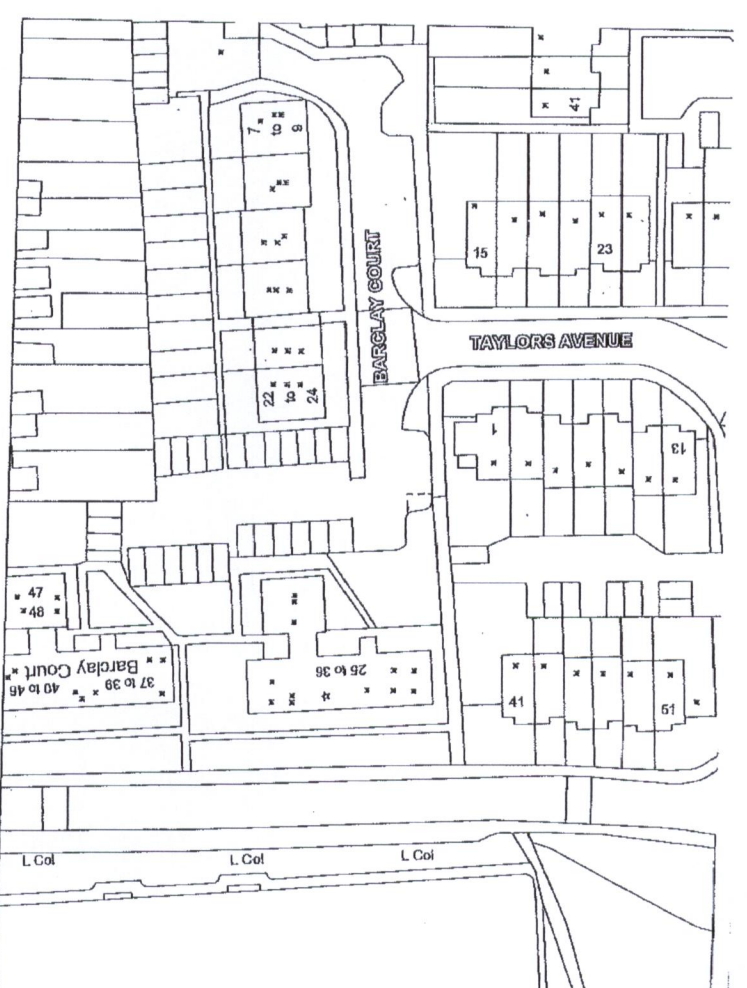
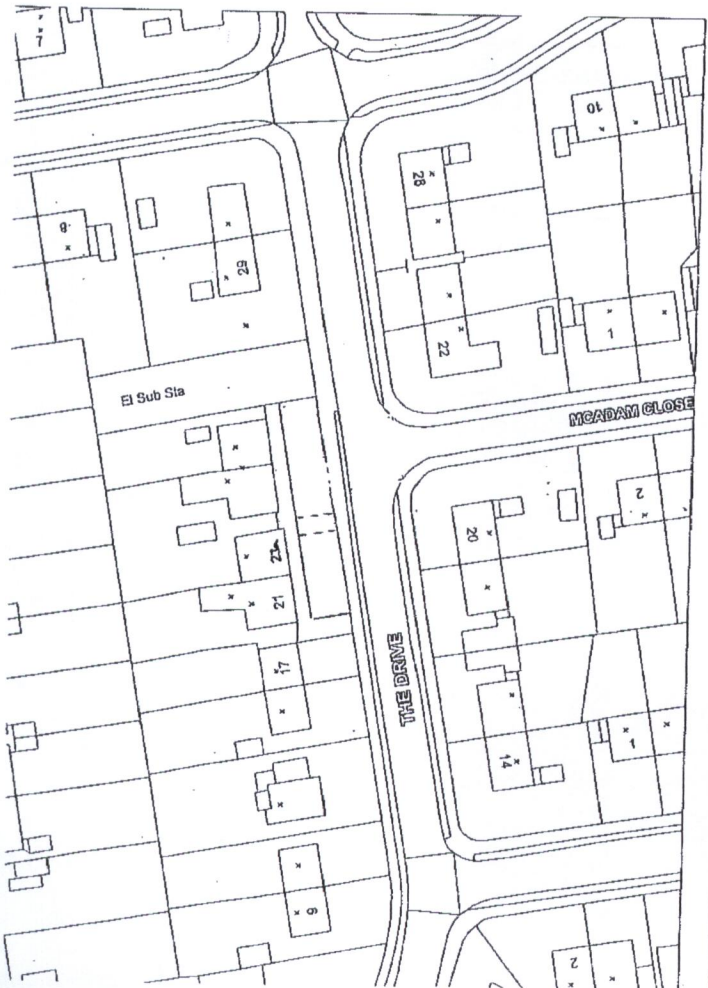
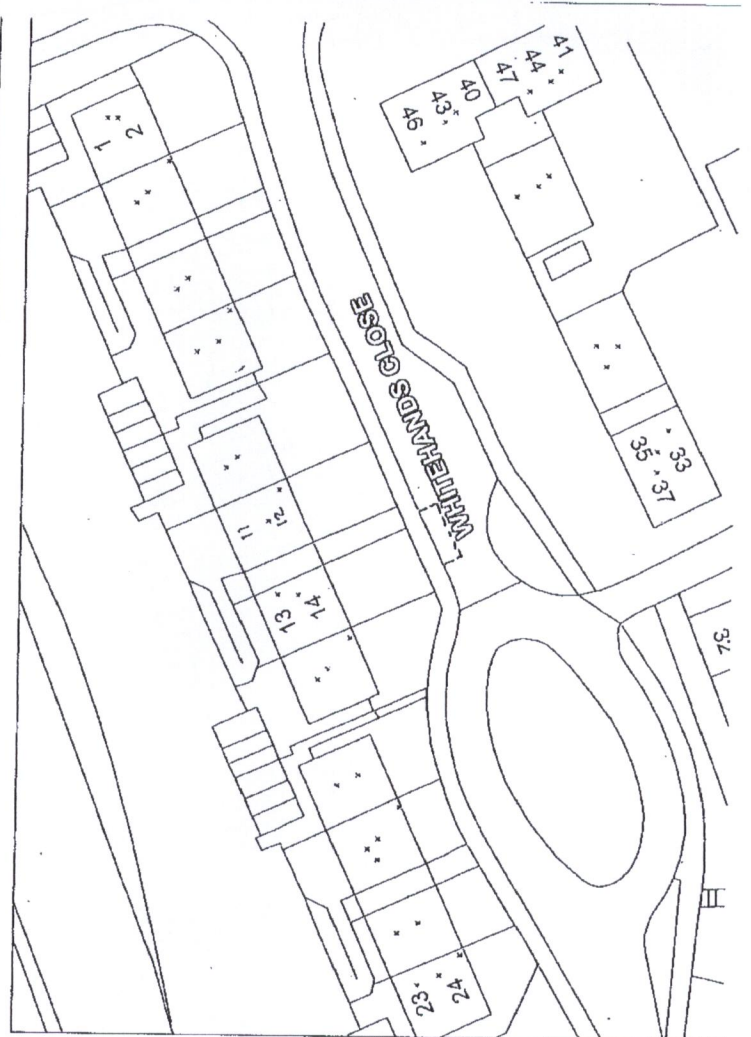
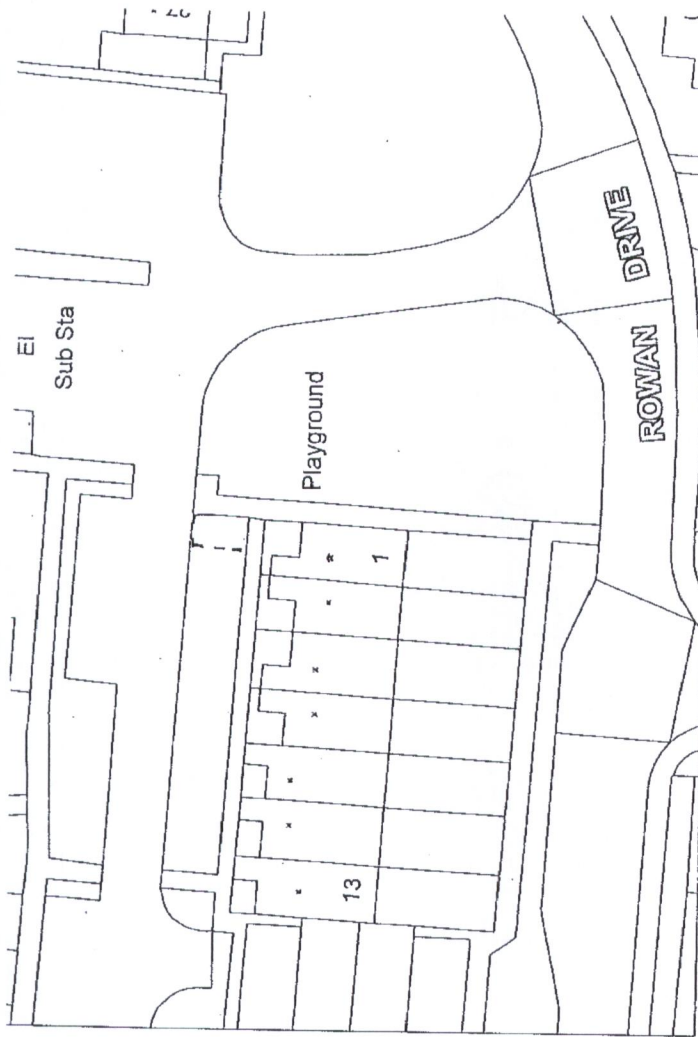

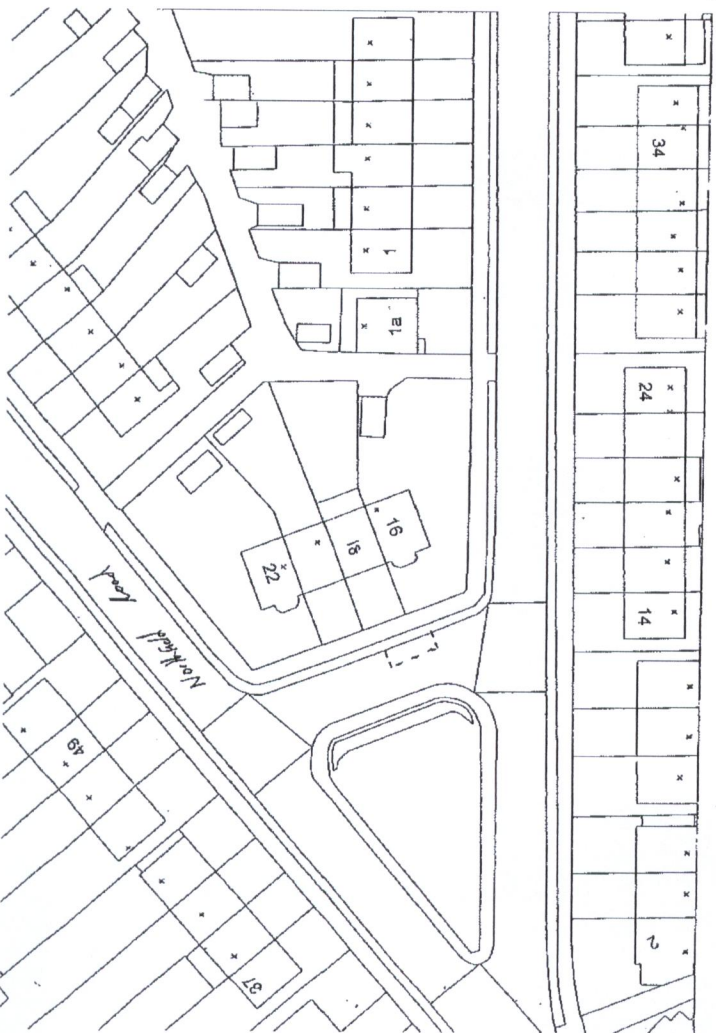
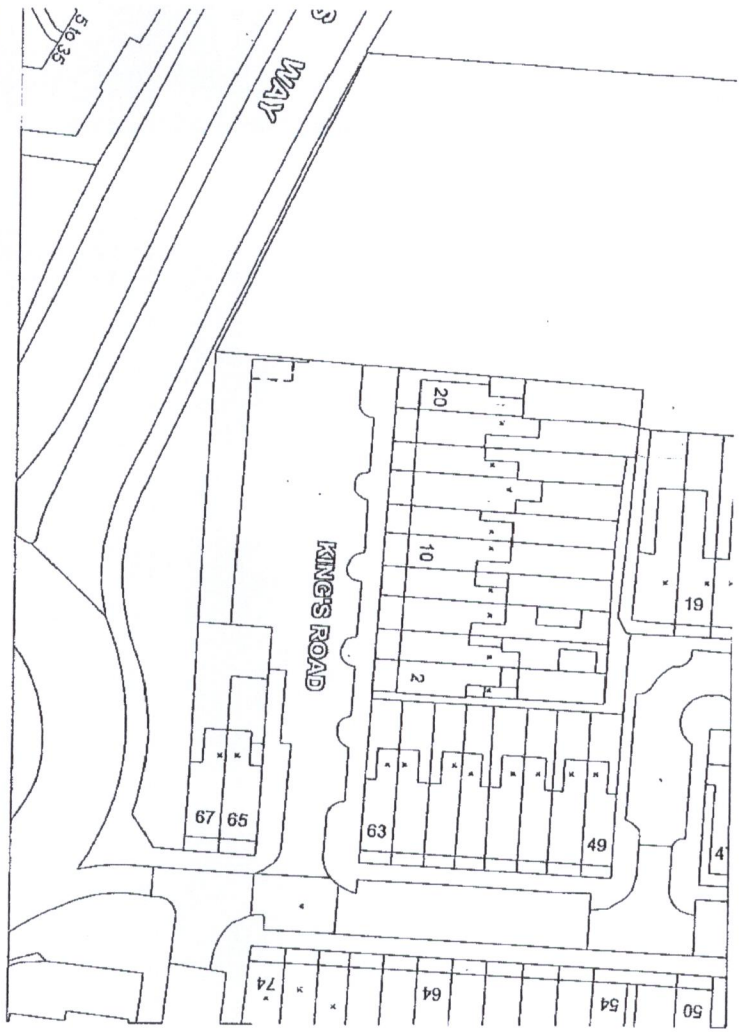
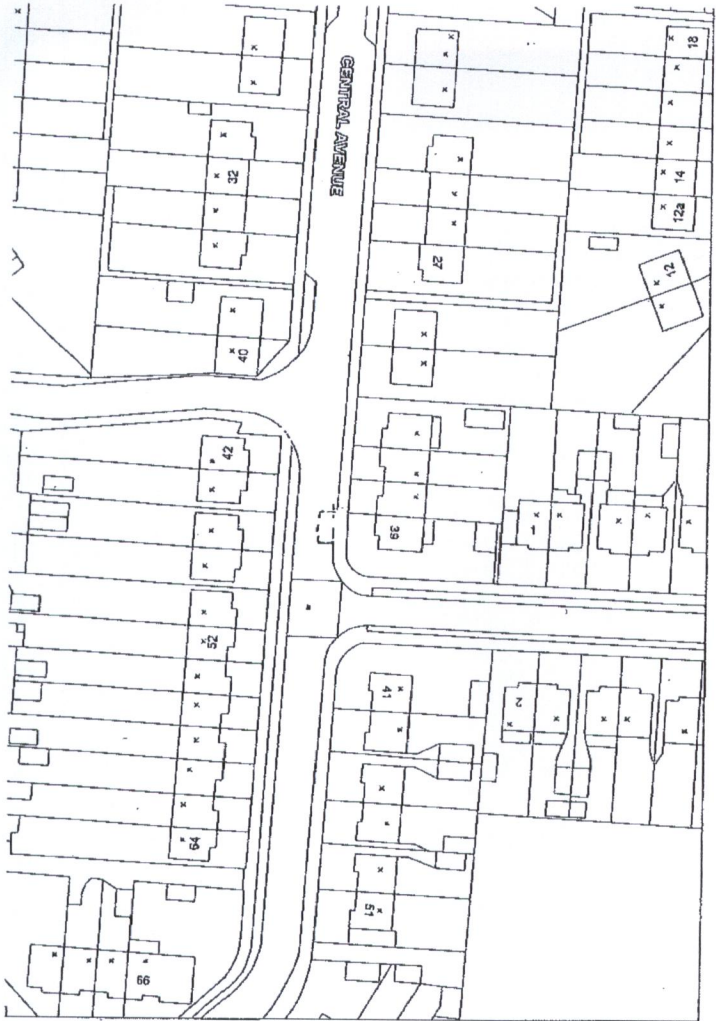

 CHIEF EXECUTIVE OFFICER

IN WITNESS whereof the Common Seal of the Council of the Borough of Broxbourne has hereunto been affixed on this 4th November 2013

The Common Seal of the COUNCIL OF THE BOROUGH OF BROXBOURNE was hereunto affixed in the presence of:-

3075



A handwritten signature in black ink, consisting of several loops and a long horizontal stroke at the end.

Chief Executive Officer

Dated 4th November 2013

ROAD TRAFFIC REGULATION ACT 1984

THE BOROUGH OF BROXBOURNE
(VARIOUS ROADS) (DISABLED
PERSON'S PARKING PLACES)
ORDER No. 2 2013

**THE BOROUGH OF BROXBOURNE
ROAD TRAFFIC REGULATION ACT 1984**

**THE BOROUGH OF BROXBOURNE (VARIOUS ROADS)
(DISABLED PERSONS' PARKING PLACES) ORDER No.2 2013**

NOTICE is hereby given that on 4th November 2013 the Council of the Borough of Broxbourne, pursuant to arrangements made with Hertfordshire County Council under Section 19 of the Local Government Act 2000 and the Local Authorities (Arrangements for the Discharge of Functions) (England) Regulations 2000, made an Order under Sections 32 and 35 of the Road Traffic Regulation Act 1984, the effect of which is to:

1. Provide Disabled Persons' Parking Places adjacent to or outside the following premises or in the locations indicated if not directly outside the premises as shown;

Premises	Location – if not directly outside Premises
i 27 Albury Grove Road, Cheshunt	
ii 50 College Road, Cheshunt	
iii 30 Collet Gardens, Cheshunt	In lay-by o/s 2 – 10 Collet Gardens
iv 30 Elderbek Close, Cheshunt	In parking bays o/s 30 – 37 Elderbek Close
v 30 Barclay Court, Hoddesdon	In lay-by to the side of 1 Taylors Avenue
vi 23a The Drive, Hoddesdon	In parking bays outside 21 – 27 The Drive
vii 11 Whitehands Close, Hoddesdon	Outside 13 & 14 Whitehands Close
viii 1 Rowan Drive, Turnford	
ix 39 Central Avenue, W. Cross	
x 20 Kings Road, W. Cross	In parking bays opposite 20 Kings Road
xi 18 Northfield Road, W. Cross	

2. Remove the existing Disabled Persons' Parking Places at the following locations which are no longer being used;

1 20 Churchfields, Broxbourne	13 53 Castle Road, Hoddesdon
2 143 High Road, Broxbourne	14 40 Cherry Tree Road, Hoddesdon
3 16 St Augustines Drive, Broxbourne	15 10 Hamilton Avenue, Hoddesdon
4 12 Albermarle Avenue, Cheshunt	16 24 Hawthorn Road, Hoddesdon
5 67 Brampton Close, Cheshunt	17 8 Middlefield Road, Hoddesdon
6 11 Cornwall Close, Cheshunt	18 30 Park Lane, Hoddesdon
7 46 Longmoor, Cheshunt	19 98 Rye Road, Hoddesdon
8 18 Medcalf Court, Cheshunt	20 3 Brickcroft, Turnford
9 14 Rowlands Close, Cheshunt	21 7 Garner Drive, Turnford
10 26 Wheatcroft, Cheshunt	22 88 Park Lane, W. Cross
11 189 Whitefields Road, Cheshunt	23 43 Swanfield Road, W. Cross
12 102 Burford Street, Hoddesdon	

The Order came into force on 6th November 2013.

Documents giving more detailed particulars of the Order namely a copy of the Order and the maps contained in it, showing each length of road to which the Order relates, a statement of the Council's reasons for making the Order, the Notice relating to the Council's intention to make the Order together with a copy of The Borough of Broxbourne (Control of Parking) (Consolidation)

Order 2011, The Borough of Broxbourne (Various Roads) (Disabled Persons' Parking Places) Order 2011 and The Borough of Broxbourne (Various Roads) (Disabled Persons' Parking Places) Order 2012 may be inspected at the Wolsey Hall One Stop Shop, Windmill Lane, CHESHUNT and the Hoddesdon One Stop Shop, Unit 42, Tower Centre, High Street, HODDESDON, between the hours of 9.00 am and 5.30 pm, Monday to Fridays and 9.00 am and 1.00 pm Saturdays, the Waltham Cross One Stop Shop, 123 High Street, WALTHAM CROSS between the hours of 9.00 am and 5.30 pm Monday to Fridays and 9.00 am and 4.00 pm Saturdays and at the office of the undersigned between the hours of 8.30 am and 5.30 pm Monday to Fridays (Tuesdays to 7.30 pm) and 9.00 am and 1.00 pm Saturdays.

Any person wishing to question the validity of the Order or any of its provisions on the grounds that it or they are not within the powers conferred by the Road Traffic Regulation Act 1984, or on the grounds that any requirements of that Act or any regulations made thereunder has not been complied with, may within 6 weeks from 6th November 2013, make any application for this purpose to the High Court.

Dated 4th November 2013

Borough Offices
Bishops' College
Churchgate
CHESHUNT
Herts. EN8 9XB

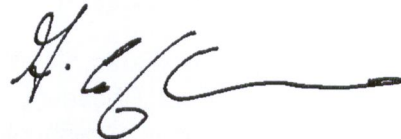

Alf Cuffaro
Head of Projects