

BROXBOURNE BOROUGH COUNCIL
ROAD TRAFFIC REGULATION ACT 1984

Date of Order: 7th August 2015

**THE BOROUGH OF BROXBOURNE COUNCIL (VARIOUS ROADS HODDESDON,
BROXBOURNE, CHESHUNT and WALTHAM CROSS) (RESTRICTION OF WAITING)
ORDER 2015**

The Council of the Borough of Broxbourne ("the Council") pursuant to arrangements made under Section 19 of the Local Government Act 2000 and the Local Government (Arrangements for Discharge of Functions) (England) Regulations 2000 with Hertfordshire County Council ("the County Council") and in exercise of the powers conferred by Sections 1, 2 and 3, of the Road Traffic Regulation Act 1984 ("the 1984 Act") and of all other enabling powers and after consultation with the Chief Officer of Police in accordance with Part III of Schedule 9 to the 1984 Act hereby make the following Order:

1. This Order may be cited as "The Borough of Broxbourne Council (Various Roads Hoddesdon, Broxbourne, Cheshunt and Waltham Cross) (Restriction of Waiting) Order 2015" and shall come into operation on Tuesday 1st September 2015
2. Save as provided in Articles 4, 5 and 6(1) of this Order no person shall cause or permit any vehicle to wait at any time in those lengths of road in Hoddesdon, Broxbourne, Cheshunt and Waltham Cross as specified in the Schedule 1 to this Order.
3. Save as provided in Article 4, 5 and 6(2) to this Order no person shall cause or permit any vehicle to wait between the hours of 9:00am to 10:00am Monday to Friday on those lengths of road in Broxbourne and Cheshunt as specified in Schedule 2 to this Order.
4. (1) Nothing in Article 2 of this Order applies to the lengths of road restricted by that Article (which said lengths of road are referred to in this Article as "the restricted area") in relation to –
 - (a) a vehicle being used for Fire and Rescue, Ambulance or Police purposes.
 - (b) anything done with the permission of or at the direction of a Police Constable in uniform; or with permission of a Civil Enforcement Officer as defined by the Traffic Management Act 2004 and appointed by Broxbourne Borough Council.
 - (c) a vehicle which is prevented from proceeding by circumstances beyond the drivers control or which has stopped in order to avoid injury or damage to persons or property or when required to do so by law;
 - (d) a vehicle which is stationary in order that it may be used for one or more of the purposes specified in sub-Article (2) of this Article and which cannot reasonably be used for such a purpose without stopping in the restricted area;
 - (e) a marked vehicle which, whilst used by a universal service provider in the course of the provision of a universal postal service, is stationary only for so long as may be reasonably necessary for postal packets to be delivered or collected;

In this Article -

The expressions "universal service provider", "provision of a universal postal Service" and "postal packet" shall bear the same meanings as in the Postal Services Act 2000.

- (2) The "purposes" referred to in sub-Article (1)(d) of this Article are –
 - (a) any operation involving building, demolition or excavation;
 - (b) the removal of any obstruction to traffic;
 - (c) the maintenance, improvement or reconstruction of a road;
 - (d) constructing, improving, maintaining, or cleaning of any street furniture; or

- (e) the laying, erection, alteration, repair or cleaning of any sewer or of any main pipe or apparatus for the supply of gas, water or electricity, or of any telecommunications apparatus kept or installed for the purposes of a telecommunications code system or of any other telecommunications apparatus lawfully kept installed in any position.
5. Nothing in Articles 2 or 3 of this Order applies to the lengths of road restricted by those Articles (which said lengths of road are referred to in this Article as "the restricted area") so as to render it unlawful to cause or permit any vehicle to wait only for so long as may be reasonably necessary –
- (a) to enable goods to be loaded on or unloaded from the vehicle from or to premises adjacent to the restricted area; or
- (b) to enable a passenger to board or alight and to load and unload any luggage.
6. (1) Nothing in Article 2 of this Order shall render it unlawful to cause or permit a disabled person's vehicle which displays in the relevant position a disabled person's badge and a parking disc, to wait at any time in the lengths of road specified in Schedule 1 of this Order for a period not exceeding 3 hours (not being a period separated by an interval of less than 1 hour from a previous period of waiting by the same vehicle in the same length of road).
- (2) Nothing in Article 3 of this Order shall render it unlawful to cause or permit a disabled person's vehicle which displays in the relevant position a disabled person's badge, to wait at any time in the lengths of road specified in Schedule 2 of this Order.
- (3) In this Article -
- "disabled person's vehicle" has the same meaning as in Section 142(1) of the Act of 1984;
- "disabled person's badge" has the same meaning as given in Regulation 3(1) of The Local Authorities' Traffic Orders (Exemptions for Disabled Persons) (England) Regulations 2000
- "parking disc" has the same meaning as given in Regulation 8(5) of The Local Authorities' Traffic Orders (Exemptions for Disabled Persons) (England) Regulations 2000; and
- "relevant position" has the same meaning as given in Regulation 4 of The Local Authorities' Traffic Orders (Exemptions for Disabled Persons) (England) Regulations 2000
7. The Interpretation Act 1978 shall apply for the interpretation of this Order as it applies for the interpretation of an Act of Parliament.
8. The restrictions imposed by this Order shall be in addition to and not in derogation from any restriction or requirement imposed by any other regulations made or having effect as if made under the Act of 1984 or by or under any other enactment.

SCHEDULE 1

lengths of road in Hoddesdon, Broxbourne, Cheshunt & Waltham Cross – no waiting at any time

Hoddesdon

Lampits
(north west side) from a point 10.5 metres south west of a point in line with the boundary between 18 and 20 Lampits south westwards and westwards for approximately 36 metres to a point 6.5 metres east of a point in line with the boundary between 22 and 24 Lampits.

Broxbourne

Nursery Road
(north side) from its junction with the north east kerbline of High Road north eastwards for approximately 3 metres to a point 3.5 metres south west of a point in line with the south west fascia wall of 12 Turnford Cottages, High Road.

(south side) from its junction with the north east kerbline of High Road north eastwards for approximately 35 metres to a point in line with the north east boundary of 12 Turnford Cottages, High Road.

Cheshunt

Pear Tree Walk (north east side) (a) from a point in line with the projected north west kerbline of Beechwood Close north westwards for approximately 4 metres to a point 10 metres south east of a point in line with the boundary between 22 and 24 Pear Tree Walk.

(b) from a point in line with the projected south east kerbline of Beechwood Close south eastwards for approximately 7 metres to a point 6 metres north west of a point in line with the boundary between 18 and 20 Pear Tree Walk.

Beechwood Close (both sides) from its junction with the north east kerbline of Pear Tree Walk north eastwards for approximately 11 metres to a point 18 metres south west of a point in line with the north east boundary of 20 Pear Tree Walk.

Longfield Lane (north east side) from a point in line with the projected north west kerbline of Debenham Road north westwards for approximately 16.5 metres to a point 21 metres south east of a point in line with the boundary between 102 and 104 Longfield Lane.

Debenham Road (north west side) from its junction with the north east kerbline of Longfield Lane north eastwards for approximately 33.5 metres to a point in line with the boundary between 1 and 3 Debenham Road.

Waltham Cross

Queens Way (south east side) from a point 24 metres north east of a point in line with the north east kerbline of Longcroft Drive north eastwards for approximately 35.5 metres to a point in line with the projected south west kerbline of the entrance to Albert Court.

SCHEDULE 2

lengths of road in Broxbourne and Cheshunt – no waiting 9.00am to 10.00am Monday to Friday

Broxbourne

Woodstock Road (north east side) (a) from a point in line with the projected north west kerbline of Sutton Close north westwards for approximately 10 metres to a point 2 metres south east of a point in line with the south east facia wall of 8 Woodstock Road.

(b) from a point in line with the projected south east kerbline of Sutton Close south eastwards for approximately 90 metres to a point in line with the projected north west kerbline of Badminton Place.

(c) from a point in line with the projected south east kerbline of Badminton Place south eastwards for approximately 57 metres to its junction with the north west kerbline of Park Lane.

(south west side) from a point 10 metres north west of a point in line with the projected north west kerbline of Sutton Close south eastwards for approximately 170 metres to its junction with the north west kerbline of Park Lane.

Sutton Close (both sides) from its junction with the north east kerbline of Woodstock Road north eastwards for approximately 8 metres to a point 10 metres south west of a point in line with the boundary between 1 and 2 Sutton Close.

Badminton Place (both sides) from its junction with the north east kerbline of Woodstock Road north eastwards for approximately 124 metres to its end (including its turning heads)

Park Lane (north west side) (a) from a point in line with the projected north east kerbline of Woodstock Road north eastwards for approximately 19 metres to a point 16 metres south west of a point in line with the boundary between 2 and 4 Badminton Place.

(b) from a point in line with the projected south west kerbline of Woodstock Road south westwards for approximately 18 metres to a point 2 metres south west of a point in line with the boundary between 49 and 51 Park Lane.

Grenville Avenue
(south west side)

from a point 9 metres south east of a point in line with the boundary between 1a and 1 Grenville Avenue north westwards for approximately 100.5 metres to a point 20.5 metres north west of a point in line with the north west boundary of 15 Grenville Avenue.

(north east side)

from a point 2 metres south east of a point in line with the boundary between 4 and 6 Grenville Avenue north westwards for approximately 75.5 metres to a point 20.5 metres north west of a point in line with the north west boundary of 16 Grenville Avenue.

Monson Road
(fronting no's 2 to 22)
(both sides)

from a point in line with the south west facia wall of 2 Monson Road north eastwards and north westwards for approximately 36 metres to a point in line with the boundary between 20 and 22 Monson Road.

(fronting no's 33 to 51)
(both sides)

from a point 2.5 metres north east of a point in line with the boundary between 33 and 35 Monson Road north eastwards (including the turning head fronting no 24 Monson Road) for approximately 40 metres to a point 4 metres north east of a point in line with the boundary between 49 and 51 Monson Road.

(fronting no's 9 to 23)
(both sides)

from a point 11 metres south west of a point in line with the boundary between no's 33 and 35 Monson Road south westwards and south eastwards for approximately 49 metres to a point 1 metre south east of a point in line with the boundary between no's 9 and 11 Monson Road.

(south west side)

from a point 1 metre south east of a point in line with the boundary between 9 and 11 Monson Road south eastwards for approximately 23.5 metres to a point 0.5 metres south east of a point in line with the south east facia wall of 2 Monson Road.

(north east side)

from a point in line with the boundary between 20 and 22 Monson Road north westwards for approximately 10 metres to a point 2.5 metres north east of a point in line with the boundary between 33 and 35 Monson Road.

Salwey Crescent
(both sides)

from a point 14 metres south west of its junction with the south west kerbline of Park Lane south westwards for approximately 83 metres to its end (including its turning heads).

Bassingbourne Close
(both sides)

from a point in line with the projected south east kerbline of Mandeville Road south eastwards, southwards and north westwards for approximately 185 metres to its end (including all of the turning heads).

(south side)

from a point in line with the projected south east kerbline of Mandeville Road westwards for 5 metres.

Mandeville Close
(south east side)

from its junction with the north east kerbline of Bassingbourne Close north eastwards for approximately 9 metres to a point 7 metres south west of a point in line with the boundary between 2 and 4 Mandeville Close.

Cheshunt

Palmer's Way
(both sides)

from a point 9 metres south east of its junction with the south east kerbline of Landmead Road south eastwards and south westwards for approximately 224 metres to a point 23 metres north east of its junction with the north east kerbline of Roundmoor Drive.

IN WITNESS whereof the Common Seal of the Council of the Borough of Broxbourne was hereunto affixed this 7th August 2015

The Common Seal of **THE COUNCIL**
OF THE BOROUGH OF BROXBOURNE
Was hereunto affixed in the presence of:



Gawth

Authorised Signatory

Disclaimer: All measurements (site areas etc) to be checked on site for accuracy before any work commences and any discrepancies shall be reported to the Client representative.

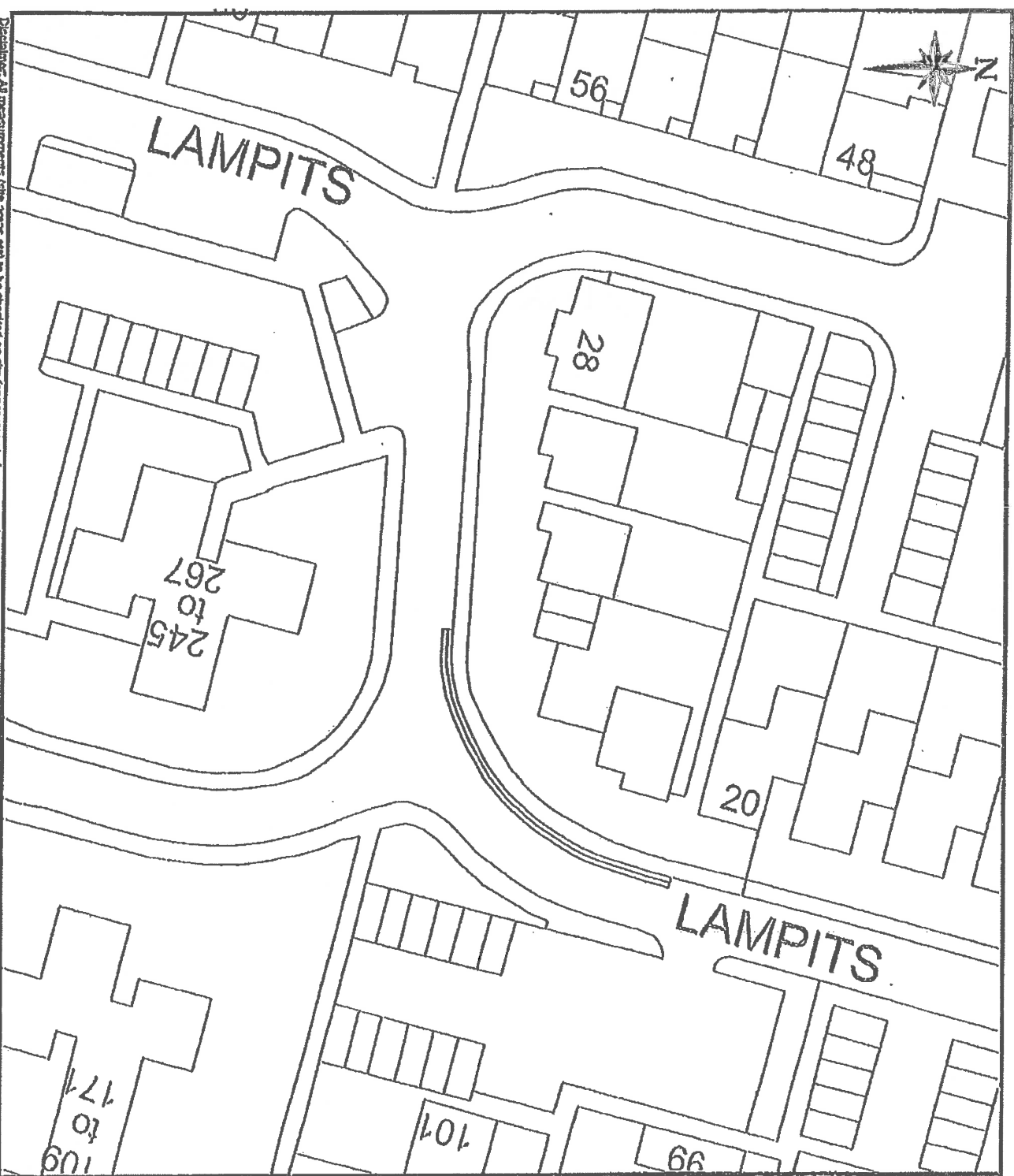

KEY



Rev	Date	Description

Project:
Lampits
Hoddleston
Hertfordshire

Title:
Proposed DYLs

Design By: NP

CAD By: CJA
Date: 30/07/14
Scale: 1:500 @ A4

BOGARDON CONSULTANTS
www.bogardon.co.uk

Engineering & Surveying Services
Borough & Stonehouse
Barnhill Office
28/1000 Oldway
Chesham
West Bucks MK35 9JG

TEL: PHONE: 01292 78855

Info	Planning	BC	Contract	As Built
✓				

No. _____

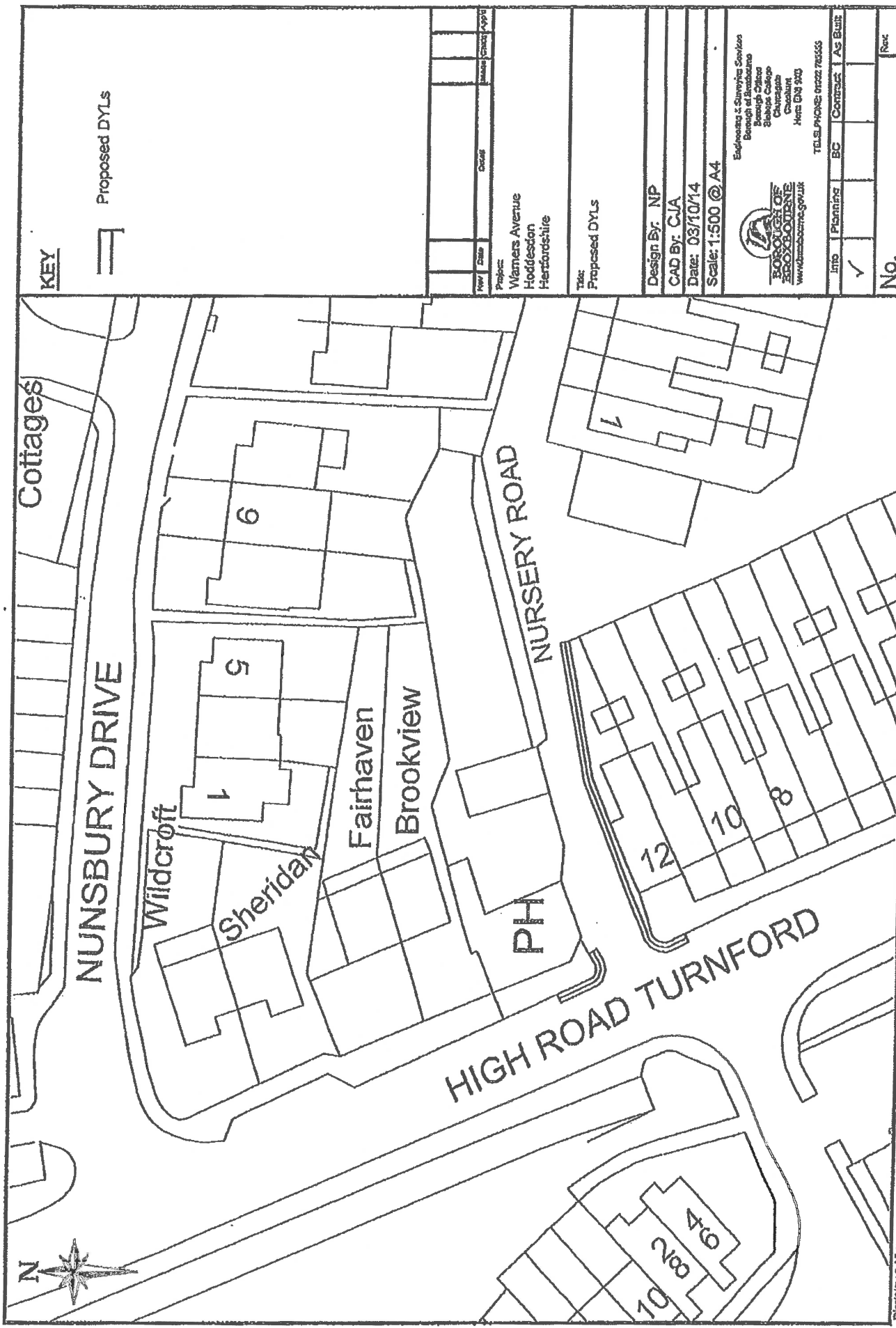

KEY

Proposed DYLS

Rev	Date	Drawn	Checked	App'd

Project:
 Warners Avenue
 Hoddeston
 Hertfordshire

Title:
 Proposed DYLS

Design By: NP

CAD By: CJA

Date: 03/10/14

Scale: 1:500 @ A4

Engineering & Surveying Services
 Borough of Broxbourne
 Borough Office
 Blakes Cottage
 Churchgate
 Churchgate
 Here EN9 5AG
 www.broxbourne.gov.uk

TELEPHONE: 01277 76655

INTD	Planning	BC	Contract	As Built
✓				

No.

Rev

Disclaimer: All measurements (plus areas etc) to be checked on site for accuracy before any work commences and any discrepancies shall be reported to the Clients representative.

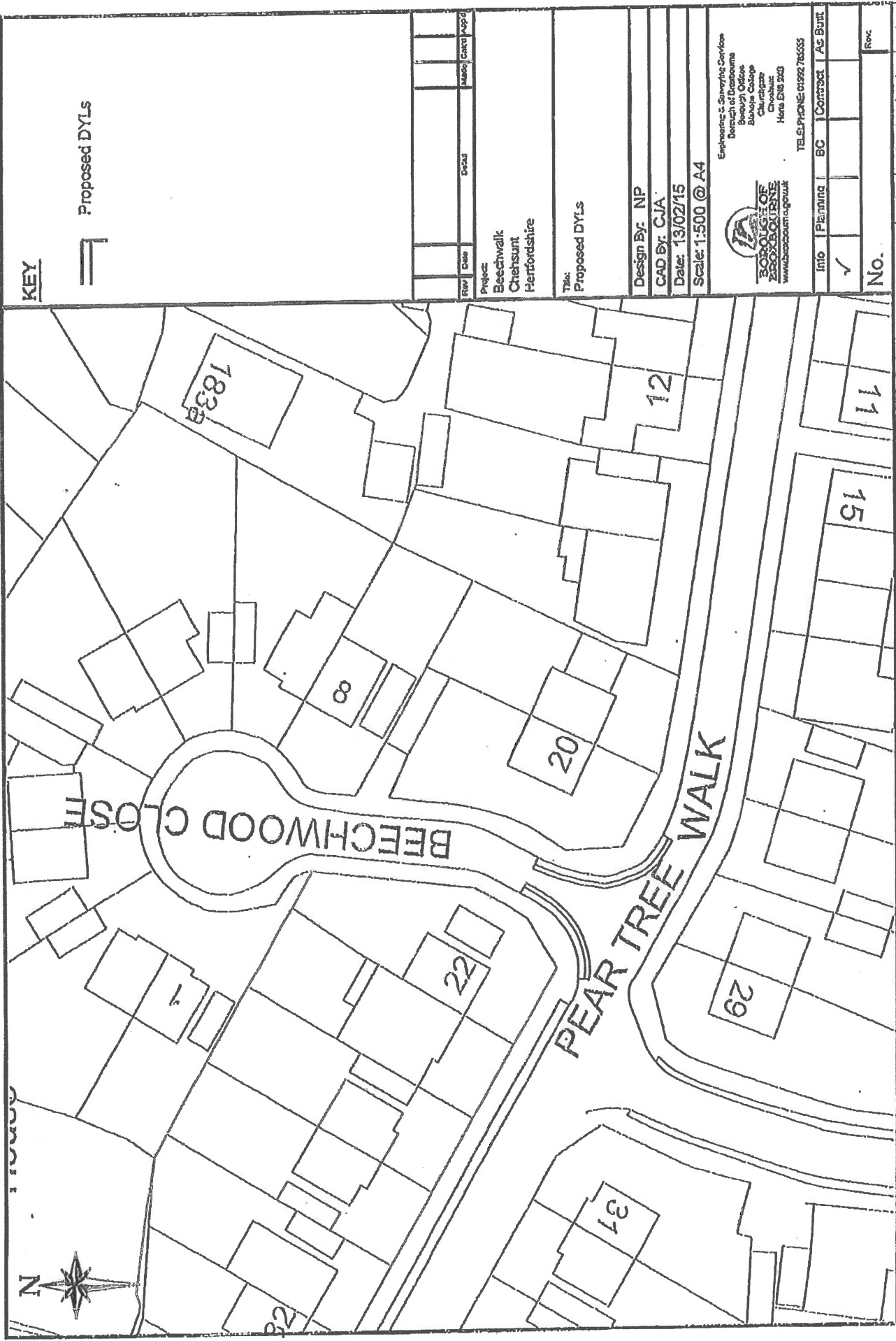

KEY

Proposed DYLS



Rev	Date	Desc	Drawn	Checked	App'd

Project:
Beechwalk
Chersunt
Hertfordshire

Title:
Proposed DYLS

Design By: NP
CAD By: CJA
Date: 13/02/15
Scale: 1:500 @ A4

Engineering & Surveying Services
District of Stroud
Borough Office
Borough College
Churchgate
Stroud
Herts EN8 2JG
TELEPHONE: 01927 76555
www.stroudsborne.gov.uk

Info	Planning	BC	Contract	As Built
✓				
No.				Rev.

Disclaimer: All measurements (also areas etc) to be checked on site for accuracy before any work commences and any discrepancies shall be reported to the Client's representative.

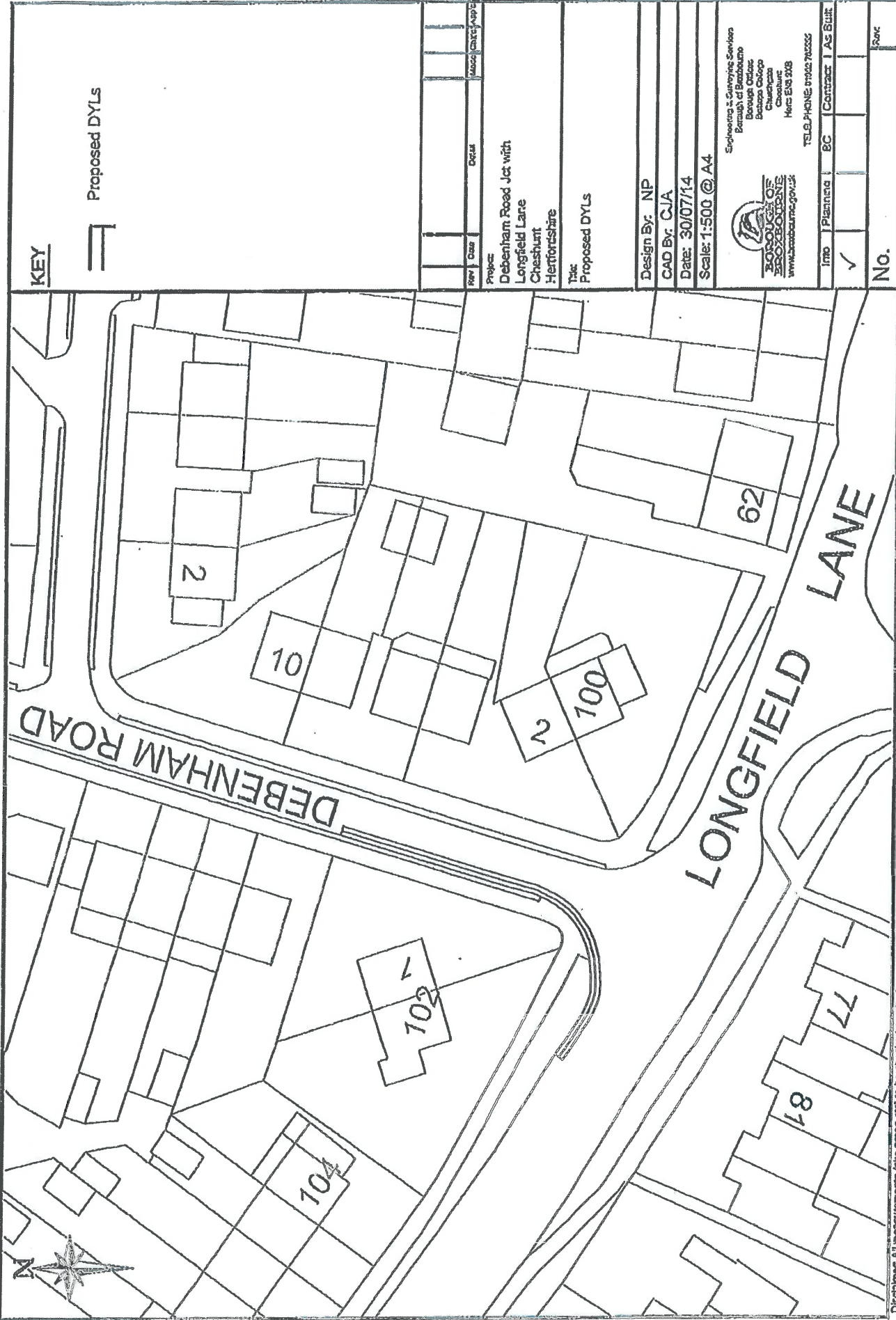

KEY

Proposed DYLS

Rev	Date	Detail	Issue/Comments

Project:
 Debenham Road Jct with
 Longfield Lane
 Cheshunt
 Hertfordshire

Title:
 Proposed DYLS

Design By: NP
CAD By: CJA
Date: 30/07/14
Scale: 1:500 @ A4



Engineering & Surveying Services
 Borough of Barnet
 Barnet Office
 Barnet, Herts
 Herts EN8 9TB
 TEL: 020 8448 7000

Info	Planning	BC	Contract	AS Built
✓				

No.	Rev

Disclaimer: All measurements (site areas etc) to be checked on site for accuracy before any work commences and any discrepancies shall be reported to the Client representative.



ELEANOR CROSS ROAD

LONG CROFT DRIVE

QUEENS WAY

Albert Court
188 to 192
366 to 381

Harold Court
352 to 366

Mel
100
150
170
150

KEY

Proposed DYLS



Rev	Date	Desc	Issue	Checked	Appr

Project:
Queens Way
Waltham Cross
Hertfordshire

Title:
Proposed DYLS

Design By: NP

CAD By: CJA

Date: 30/07/14

Scale: 1:500 @ A4



Engineering & Surveying Services
Borough of Broxbourne
Brookside Offices
Sturges Close
Chesham
Herts SG8 3JG
TELEPHONE: 01922 765555

Info	Planning	BC	Contract	AS Built
✓				

No. _____

Disclaimer: All measurements (site areas etc) to be checked on site for accuracy before any work commences and any discrepancies shall be reported to the Clients representative.

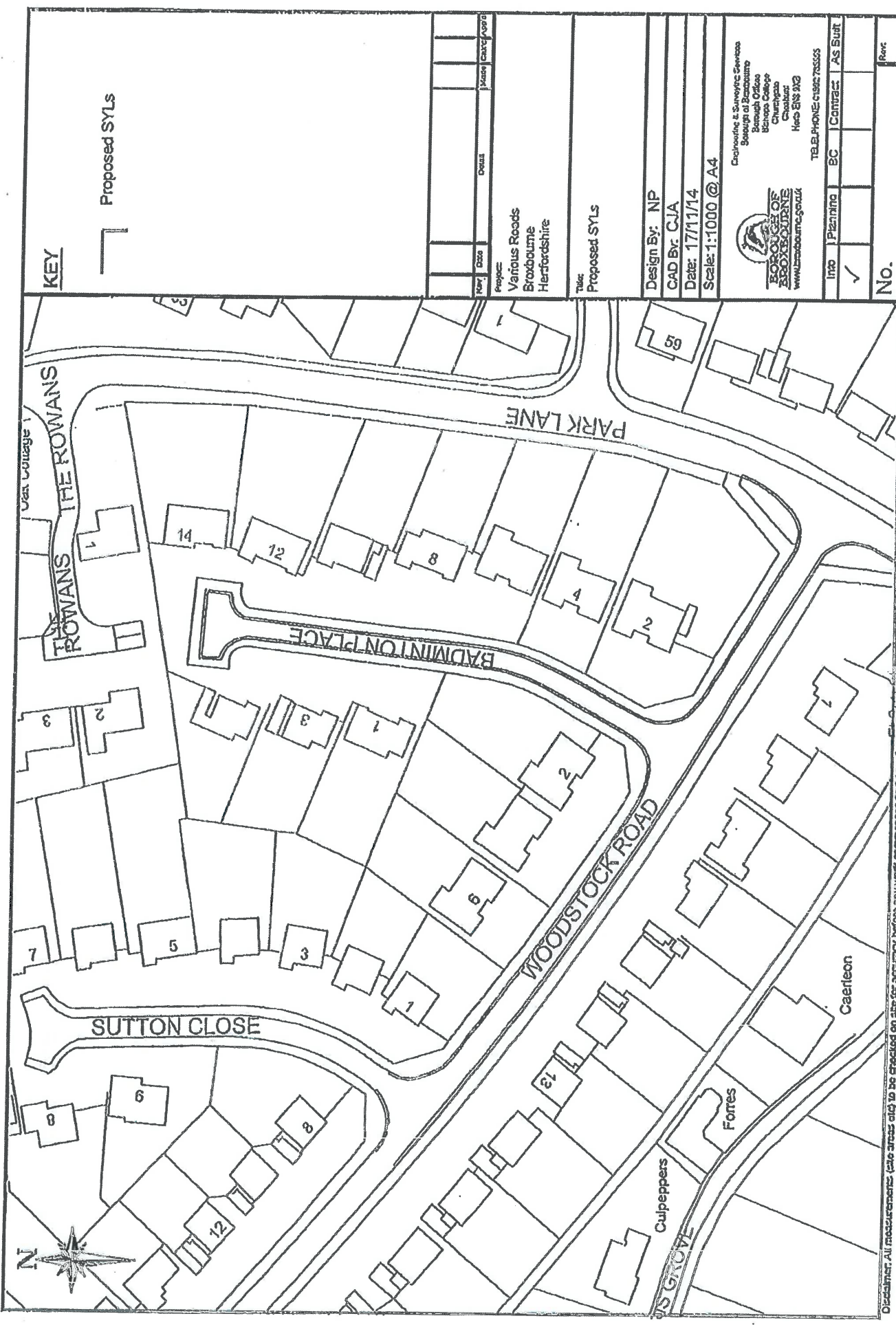

KEY



Proposed SYLs

No.	Date	Drawn	Checked	Appr'd

Project:
Various Roads
Broxbourne
Herefordshire

Title:
Proposed SYLs

Design By: NP
CAD By: CJA
Date: 17/11/14
Scale: 1:1000 @ A4



Coopering & Surveying Services
Solutions of Broxbourne
Borough Office
Broxbourne College
Churchyard
Chesham
Here EN9 9JG
TELEPHONE: 01837 76555

Intd	P/znning	BC	Contract	AS Built

No.

Disclaimer: All measurements (with areas etc) to be checked on site for accuracy before any work commences and any discrepancies shall be reported to the Client's representative.



KEY

Proposed SYLs



Start	Date	Detail	Drawn	Checked	App'd
Project: Grenville Avenue Broxbourne Hertfordshire					
Task: Proposed SYLs					
Design By: NP					
CAD By: CJA					
Date: 11/02/15					
Scale: 1:500 @ A4					
Engineering & Surveying Services Borough of Broxbourne Borough Office Market Square Broxbourne Hertfordshire SG8 6NR UK TEL: 01838 200000 FAX: 01838 200001					
INTD	Planning	BC	Contract	As Built	
<input checked="" type="checkbox"/>					
No.					Rev.

Disclaimer: All measurements (site areas etc) to be checked on site for accuracy before any work commences and any discrepancies shall be reported to the Client representatives.

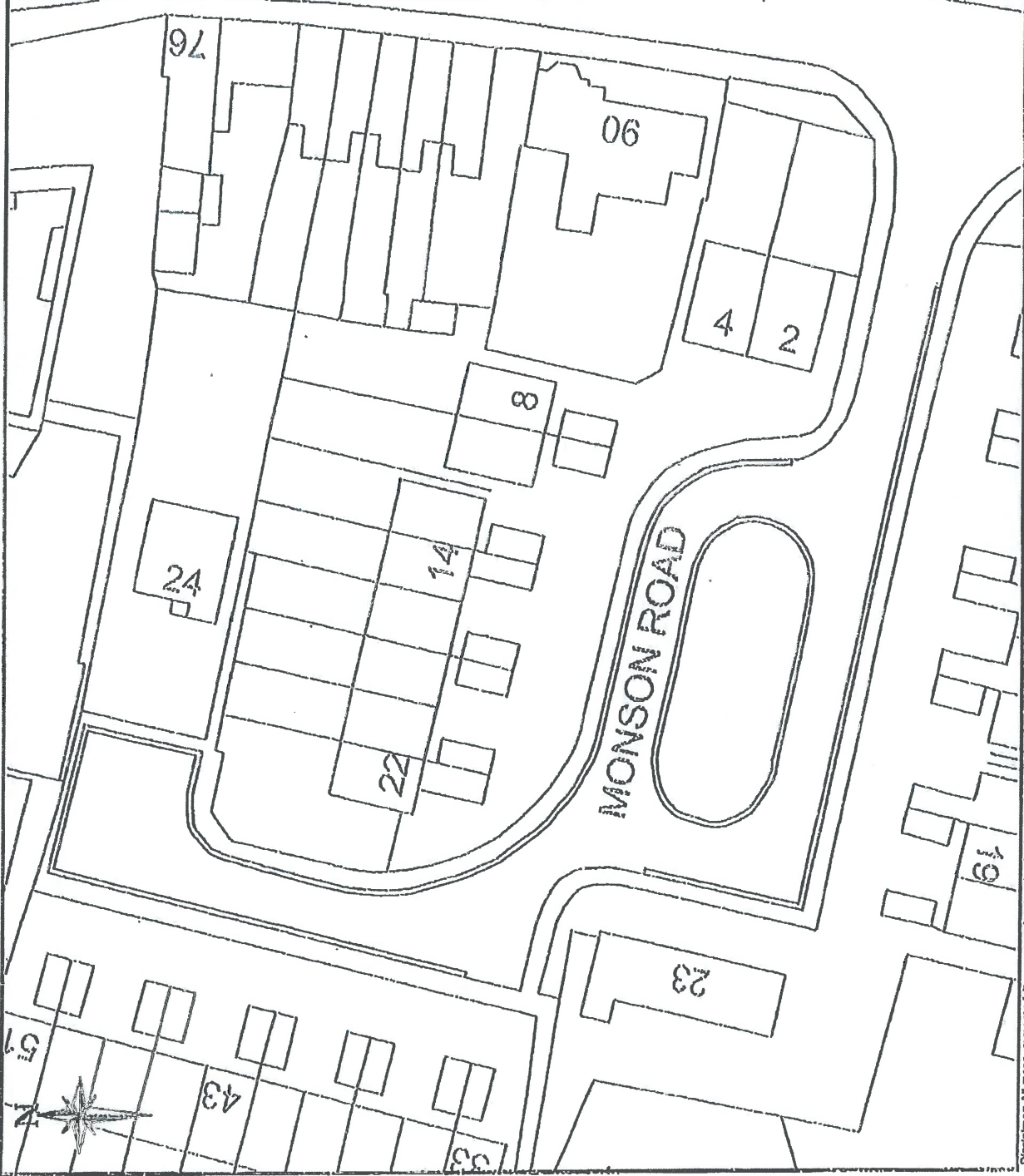

KEY

Proposed SYLS



Year	Date	Drawn	Checked	Scale

Project:
 Monson Road
 Broxbourne
 Hertfordshire

Title:
 Proposed SYLS

Design By: NP
CAD By: CJA
Date: 11/02/15
Scale: 1:500 @ A4

 Borough of Broxbourne
 Borough Office
 St James College
 Churchgate
 Hemel Hempstead
 Herts SG9 9BB
 TEL: 01462 715555
 www.broxbourne.gov.uk

Info	Planning	BC	Contract	As Built	Rev.
✓					
No.					

Disclaimer: All measurements (also areas etc) to be checked on site for accuracy before any work commences and any discrepancies shall be reported to the Client's representative.

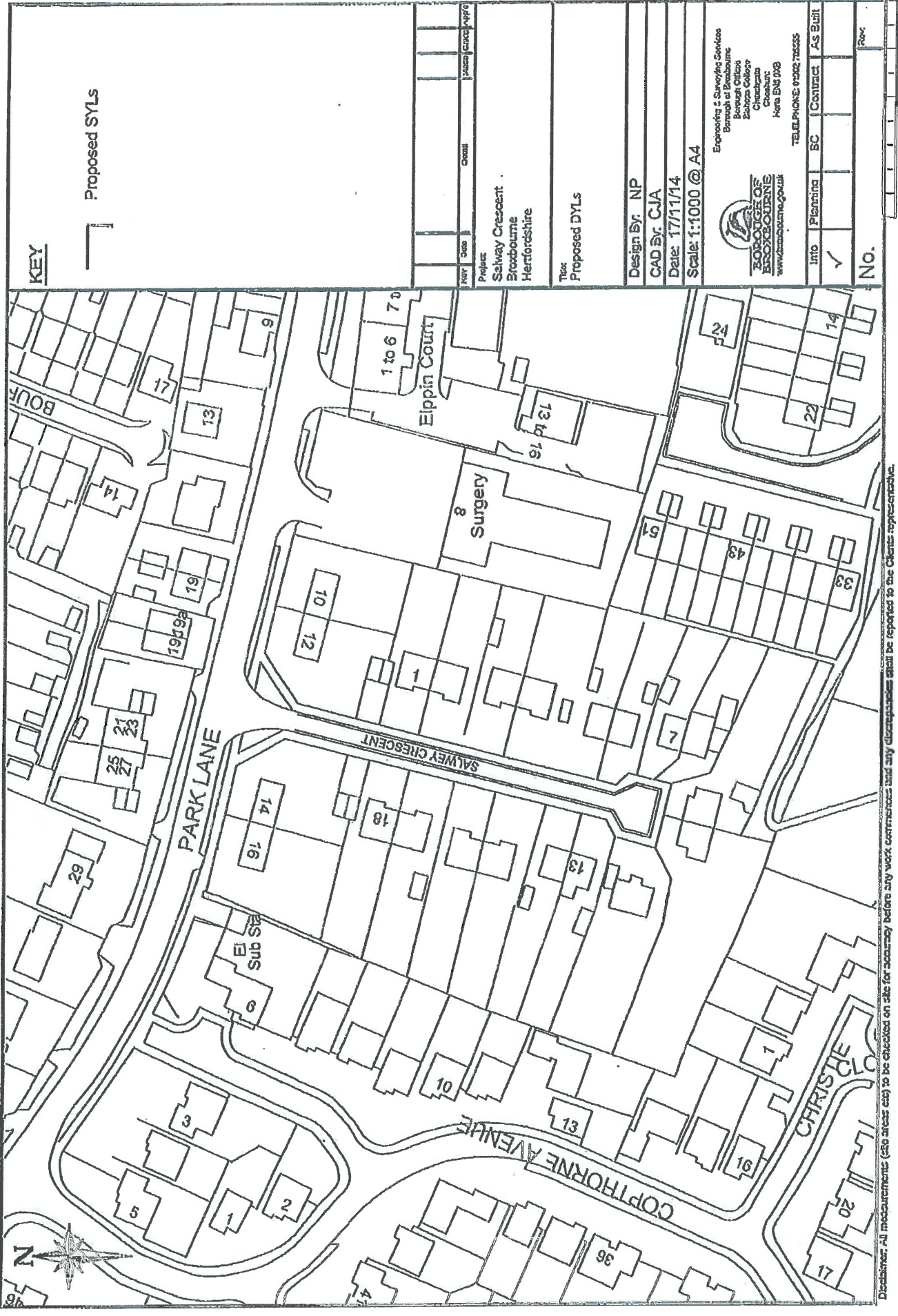

KEY

Proposed SYLs

Rev	Desc	Drawn	Checked	Scale	Project
					Salwey Crescent Bloxbourne Herefordshire
					Title: Proposed DYLS
					Design By: NP
					CAD By: CJA
					Date: 17/11/14
					Scale: 1:1000 @ A4

Engineers & Surveyors
Borough of Hereford
Borough Office
Bloxbourne
Hereford
Herefordshire



TELEPHONE: 01527 716505

Info	Planning	BC	Contract	AS BUILT
✓				
No.				

Disclaimer: All measurements (also areas etc) to be checked on site for accuracy before any work commences and any discrepancies shall be reported to the Client representative.

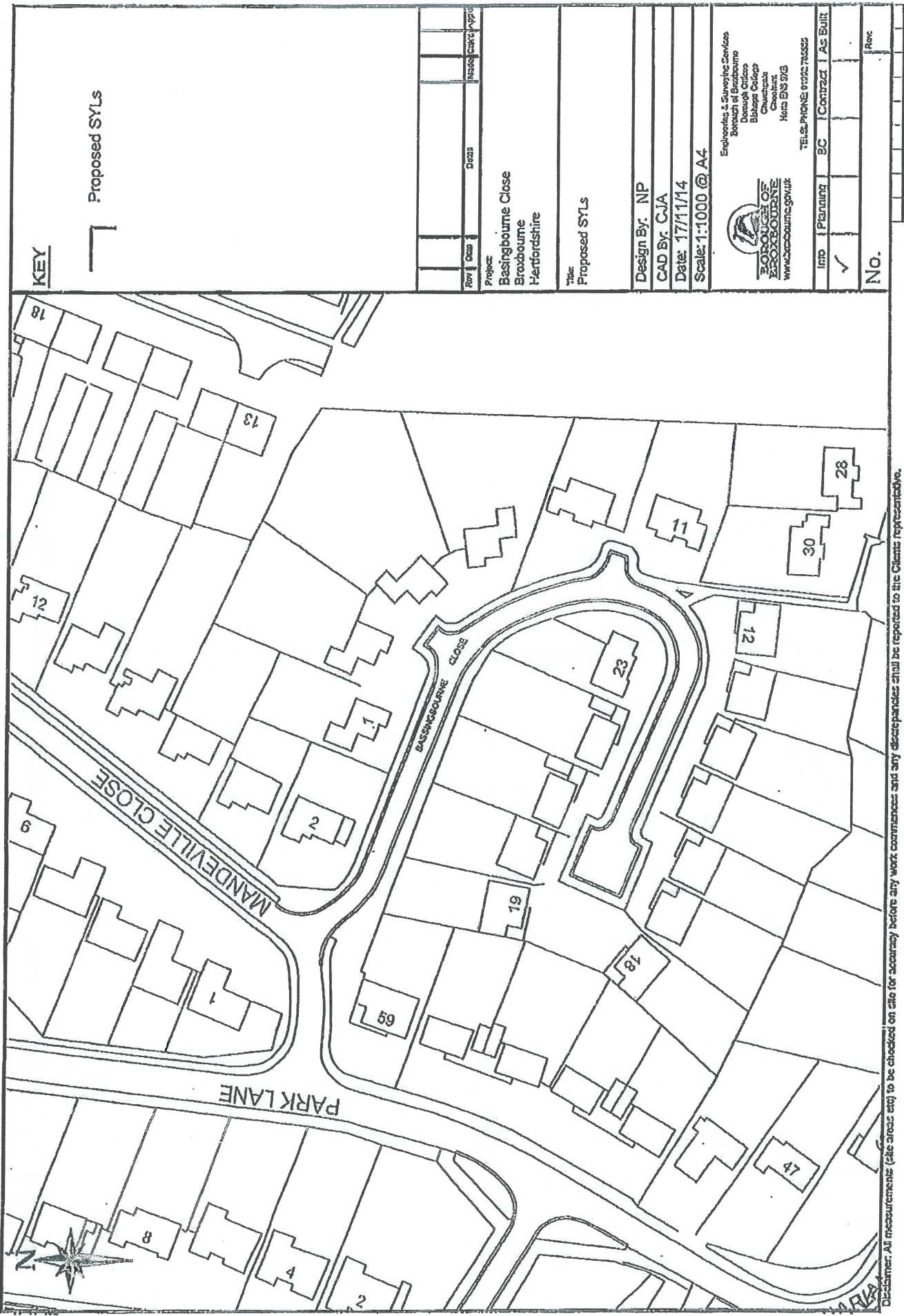

KEY

Proposed SYLs

Rev	Desc	Drawn	Checked	Issue Date	Appr
Project:					
Basingbourne Close					
Broxbourne					
Hertfordshire					
Title:					
Proposed SYLs					
Design By: NP					
CAD By: CJA					
Date: 17/11/14					
Scale: 1:1000 @ A4					
 Engineers & Surveying Services Division of Broxbourne Brookfields Blagden Close Churchgate Chesham Herts EN8 9JG www.broxbourne.gov.uk TEL: 01438 70227/8/9/5					
INTD	Planning	BC	Contract	AS BUILT	
✓					
No.					Rev

Disclaimer: All measurements (site areas etc) to be checked on site for accuracy before any work commences and any discrepancies shall be reported to the Clients representative.

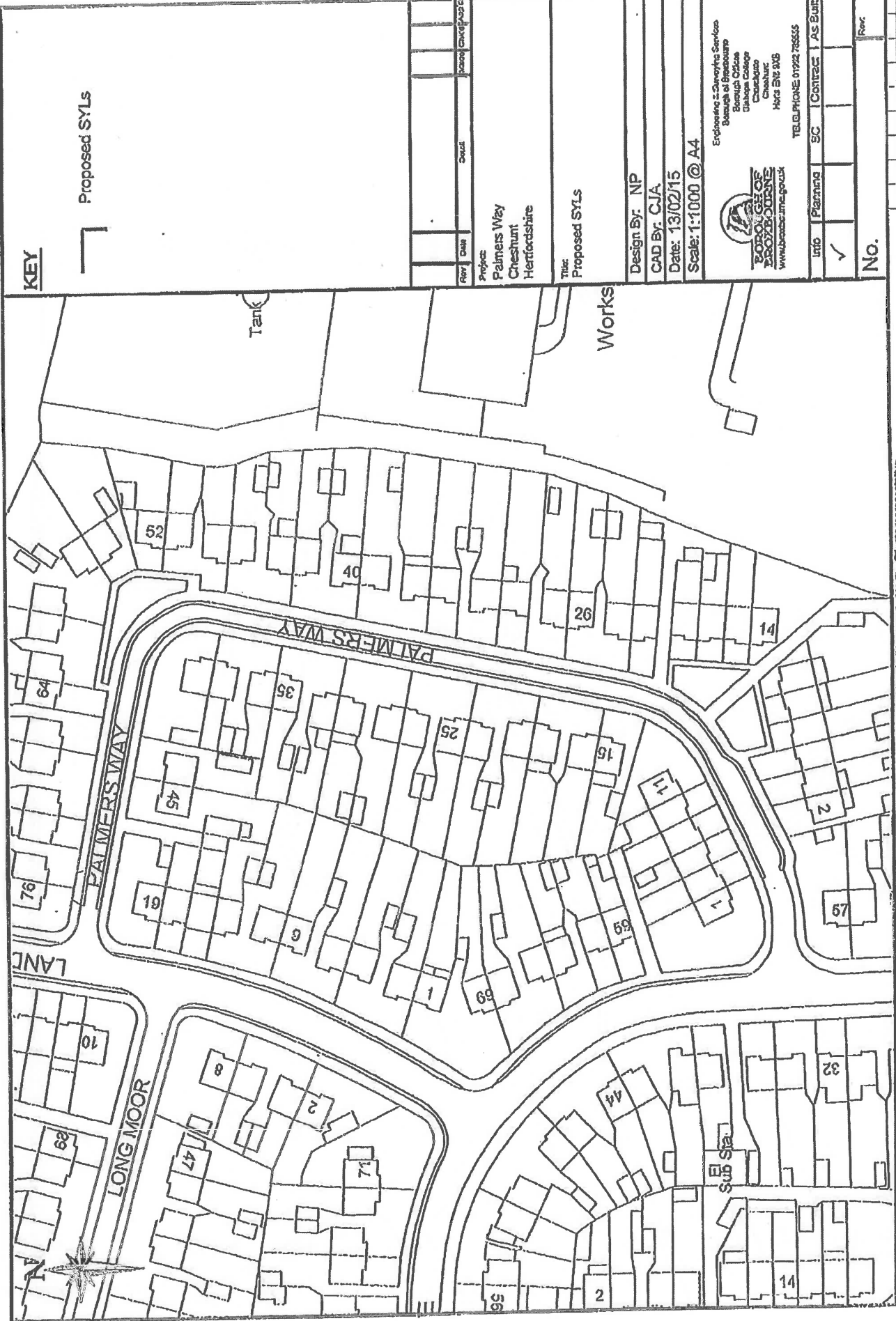

KEY

Proposed SYLS

Rev	Date	Drawn	Checked	Approved
Project: Palmers Way Creshunt Hertfordshire				
Title: Proposed SYLS				
Design By: NP CAD By: CJA Date: 13/02/15 Scale: 1:1000 @ A4				
 Explaining & Surveying Services Borough of Broxbourne Borough Office Gauging College Chesham Hemel Hempstead Herts SG8 5JG TEL: 01438 755555 www.borocams.gov.uk				
Info	Planning	SC	Contract	AS Built
✓				
No.				Rev.

Disclaimer: All measurements (site areas etc) to be checked on site for accuracy before any work commences and any discrepancies shall be reported to the Client's representative.