

BOROUGH OF BROXBOURNE
ROAD TRAFFIC REGULATION ACT 1984

THE BOROUGH OF BROXBOURNE (VARIOUS ROADS)
(DISABLED PERSONS' PARKING PLACES) ORDER 2019

THE COUNCIL OF THE BOROUGH OF BROXBOURNE, pursuant to arrangements made with the Hertfordshire County Council under Section 19 of the Local Government Act 2000 and the Local Authorities (Arrangements for the Discharge of Functions) (England) Regulations 2012, and in exercise of its powers under Sections 32 and 35 of Schedule 9 of the Road Traffic Regulation Act 1984, (hereinafter called "the 1984 Act") and of all other enabling powers, and after consultation with the Chief Officer of Police in accordance with Part III of Schedule 9 of the Act of 1984, hereby make the following Order:

1(1) In this Order

"Disabled Person's Badge" has the same meaning as in The Local Authorities' Traffic Orders (Exemptions for Disabled Persons) (England) Regulations 2000.

"Disabled Person's Vehicle" has the same meaning as in Section 142(1) of the 1984 Act

"Driver", in relation to a vehicle waiting in a Parking Place, means the person driving the vehicle at the time it was left in the Parking Place

"Parking Place" means any part of a road authorised by this Order to be used as a parking place

(2) For the purposes of this Order a vehicle shall be regarded as displaying a Disabled Person's Badge in the relevant position if:

- (i) in the case of a vehicle fitted with a dashboard or fascia panel, the badge is exhibited thereon so that the serial number and the date of expiry of the badge is legible from outside the vehicle; or
- (ii) in the case of a vehicle not fitted with a dashboard or fascia panel, the badge is exhibited in a conspicuous position on the vehicle so that the serial number and the date of expiry of the badge is legible from outside the vehicle.

2(1) Those parts of the roads specified in Column 1 of Schedule 1 and shown for identification purposes only in the plan in the Schedule to this Order are authorised to be used in a position specified in Column 2 of the said Schedule 1 and subject to the following provisions of this Order, as Parking Places at any time for Disabled Person's Vehicles which display in the relevant position a Disabled Person's Badge.

(2) Nothing in paragraph (1) of this Article shall restrict the power of the Council, for preventing obstruction of the roads, by order, or by notice on the occasion of any public procession, rejoicing or illumination, or when the roads are thronged or liable to be obstructed, to close the Parking Place.

3 Where in Column 1 of Schedule 1 to this Order a Parking Place is described as available for a Disabled Person's Vehicle which displays in the relevant position a Disabled Person's Badge, the Driver of a vehicle shall not permit it to wait in that Parking Place unless it is:

- (a) a Disabled Person's Vehicle on which is displayed in the relevant position a Disabled Person's Badge, and

(b) wholly within the limits of the Parking Place.

4 A Driver of a vehicle shall not use a Parking Place:-

(a) so as unreasonably to prevent access to any premises adjoining the road, or the use of the road by other persons, or so as to be a nuisance;

(b) when for preventing obstruction of the road the Council shall by order or by notice made on the occasion of any public procession, rejoicing or illumination or when the roads are thronged or liable to be obstructed have closed that Parking Place and exhibited notice of such closing on or near the Parking Place.

5 The Driver of a motor vehicle using a Parking Place shall stop the engine as soon as the vehicle is in a position in the Parking Place, and shall not start the engine except when about to change the position of the vehicle in or to depart from the Parking Place.

6 No person shall use a vehicle, while it is in a Parking Place, in connection with the sale of any article to persons in or near the Parking Place or in connection with the selling or offering for hire of his skill or service.

7 Subject to the provision hereto, when a vehicle is left in a Parking Place in contravention of any of the provisions contained in Articles 3 and 4 of this Order a person authorised in that behalf by the Council may remove the vehicle or arrange for it to be removed from that Parking Place provided that when a vehicle is waiting in a Parking Place in contravention of the provisions of Articles 3 and 4 of this Order, a person authorised in that behalf by the Council may alter or cause to be altered the position of the vehicle in order that its position shall comply with that provision.

8 Any person removing a vehicle or altering its position by virtue of Article 7 of this Order may do so by towing or driving the vehicle or moving the vehicle in such other manner as he may think necessary and may take such measures in relation to the vehicle as he may think necessary to enable him to remove it or alter its position, as the case may be.

9 When a person authorised by the Council removes or makes arrangements for the removal of a vehicle from a Parking Place by virtue of Article 7 of this Order, he shall make such arrangements as may be reasonably necessary for safe custody of the vehicle.

10 A vehicle left in a Parking Bay in contravention of Articles 2 or 3 of this Order or left otherwise in accordance with the provisions of this Order shall incur a penalty charge.

11 The lengths of road specified in Schedule 2 of this Order are no longer authorised for the sole parking of disabled persons vehicles.

12 The provisions of The Borough of Broxbourne (Control of Parking) (Consolidation) Order 2013 ("the 2013 Order") are hereby revoked but only in so far as they are affected by the restrictions imposed by this Order.

13 Paragraph 35 of schedule 1 of the Borough of Broxbourne (Various Roads) (Disabled Persons Parking Places) Order No.2 2014 is revoked.

14 Paragraph 37 of schedule 1 of the Borough of Broxbourne (Various Roads) (Disabled Persons Parking Places) Order No.2 2014 is revoked.

- 15 Paragraph 2 of Schedule 1 of the Borough of Broxbourne (Various Roads) (Disabled Persons Parking Places) Order No. 2018 is revoked.
- 16 This Order shall come into operation on 10th June 2019 and may be cited as the Borough of Broxbourne (Various Roads) (Disabled Persons' Parking Places) Order No. 2019.

SCHEDULE 1

Column 1	Column 2
Description of the Parking Place	
i DOWNFIELD ROAD, CHESHUNT South side from a point 6.9 metres east of a point in line with the western flank wall of No.5 Wakefield Walk, eastwards for a distance of 4.6 metres.	Parallel and adjacent to the kerb
ii THEOBALDS LANE, CHESHUNT North side from a point 1 metre west of a point in line with the eastern flank wall of No.69 Theobalds Lane, westwards for a distance of 6 metres.	Parallel and adjacent to the kerb
iii BRISCOE ROAD, HODDESDON Southside from a point 1 metre east of a point in line with the eastern flank wall of No.7 Briscoe Road, eastwards for a distance of 6 metres.	Parallel and adjacent to the kerb
iv KENNING ROAD, HODDESDON North side from a point 1.2 metres west of a point in line with the western flank wall of No.25 Kenning Road, westwards for a distance of 5.6 metres.	Parallel and adjacent to the kerb
v NORRIS RISE, HODDESDON West side from a point 0.7 metres south of a point in line with the northern flank wall of No.83 Norris Rise, southwards for a distance of 5.8 metres.	Parallel and adjacent to the kerb
vi OLD ESSEX ROAD, HODDESDON South side from a point 0.7 metres east of a point in line with the eastern flank wall of No.3 Old Essex Road, eastwards for a distance of 5.9 metres.	Parallel and adjacent to the kerb
vii ELDERBEK CLOSE, CHESHUNT North side from a point 7 metres north of a point in line with the southern flank wall of No.104 Elderbek Close, north-eastwards for a distance of 5.5 metres.	Lengthwise at 90° to the kerb in a Southwest / Northeast direction in the end parking bay

- | | | |
|------|---|--|
| viii | LAMPITS, HODDESDON
East side of the parking area serving Nos.93-107 Lampits. From a point 4.9 metres north of a point in line with the northern flank wall of No.101 Lampits, northwards for a distance of 2.5 metres. | Lengthwise at 90° to the kerb in a East/West direction |
| ix | SHIRLEY CLOSE, CHESHUNT
East side from a point 8.75 metres south of a point in line with the northern flank wall of No.1 Shirley Close, southwards for a distance of 2.8 metres. | Lengthwise at 90° to the kerb in an East / West direction in the end parking bay |
| x | 14 FARMHOUSE CLOSE, TURNFORD
South side from a point 0.55 metres west of a point in line with the eastern flank wall of No.13 Farmhouse Close, eastwards for a distance of 2.4 metres. | Lengthwise at 90° to the kerb in an North / South direction in the parking area |
| xi | PENTON DRIVE, CHESHUNT
North-west side from a point 2.75 metres south-west from a point in line with the south-western flank wall of No.87 Penton Drive, south-westwards for a distance of 5.5 metres. | Parallel and adjacent to the kerb in the layby |
| xii | HAWTHORNE AVENUE, CHESHUNT
West side from a point 18 metres south of a point in line with the northern flank wall of No.31 Hawthorne Avenue, southwards for a distance of 6 metres. | Parallel and adjacent to the kerb in the layby |
| xiii | LORD STREET, HODDESDON
North side from a point in line with the eastern flank wall of No.62 Lord Street, westwards for a distance of 5.35 metres. | Parallel and adjacent to the kerb |
| xiv | GLAMIS CLOSE, CHESHUNT
North side from a point 11.3 metres east of a point in line with the western flank wall of Nos.33-36 Glamis Close, eastwards for a distance of 2.4 metres. | Lengthwise at 90° to the kerb in an North / South direction in the parking area |
| xv | ROUNDMOOR DRIVE, CHESHUNT
North side from a point 12.75 metres west of a point in line with the eastern flank wall of No.107 Roundmoor Drive, westwards for a distance of 5.5 metres. | Parallel and adjacent to the kerb in the layby |
| xvi | PARK LANE, WALTHAM CROSS
North side from a point 7.9 metres west of a point in line with the western flank wall of Nos.91A-91B Park Lane, westwards for a distance of 5.8 metres. | Parallel and adjacent to the kerb |

SCHEDULE 2

Description of those parking places to be removed

ROWAN DRIVE, TURNFORD. South side from a point 0.3 metres east of a point in line with the boundary between Nos.11&13 Rowan Drive, eastwards for a distance of 3.6 metres.

PROSPECT ROAD, CHESHUNT. North side from a point in line with the eastern boundary of the building known as No.2, westwards for a distance of 6 metres.

CROMWELL AVENUE, CHESHUNT. North side from a point in line with the boundary between Nos.38&40, eastwards for a distance of 6 metres.

LILLIARD CLOSE, HODDESDON. South end from a point in line with the western flank wall of No.23, northwards for a distance of 6 metres.

WALNUT TREE CLOSE, HODDESDON. East side from a point 2.7 metres west of a point in line with the eastern flank wall Nos.23-28 Walnut Tree Close, westwards for a distance of 2.4 metres.

MIDDLEFIELD ROAD, HODDESDON. North side from a point in line with the boundary between Nos.26&28, westwards for a distance of 6 metres.

RUSSELLS RIDE, CHESHUNT. West side from a point in line with the northern flank wall of No.125, southwards for a distance of 6 metres.

BELL LANE, BROXBOURNE. North side from a point 1 metre east of a point in line with the boundary wall between Nos.3&5, eastwards for a distance of 6 metres.

STANSTED ROAD, HODDESDON. West side from a point in line with the boundary between Nos.182&184, northwards for a distance of 6 metres.

CHAMPIONS WAY, HODDESDON. West side of access road serving the rear of Nos.22-35 Champions Green, from a point 3.5 metres north of a point in line with the northernmost flank wall of No.22 Champions Green, northwards for a distance of 6 metres.

ABBEY ROAD, WALTHAM CROSS. East side from a point in line with the boundary wall between Nos.29&31, northwards for a distance of 6 metres.

PARK LANE, WALTHAM CROSS. South side from a point 2 metres east of a point in line with the eastern flank wall of No.91 Park Lane, eastwards for a distance of 6 metres.

IN WITNESS whereof the Common Seal of the Council of the Borough of Broxbourne has hereunto been affixed on this 5th June 2019

The Common Seal of the COUNCIL OF THE BOROUGH OF BROXBOURNE was hereunto affixed in the presence of:-



Authorised Signatory

Dated 5th June 2019

ROAD TRAFFIC REGULATION ACT 1984

THE BOROUGH OF BROXBOURNE
(VARIOUS ROADS) (DISABLED
PERSON'S PARKING PLACES)
ORDER No. 2019

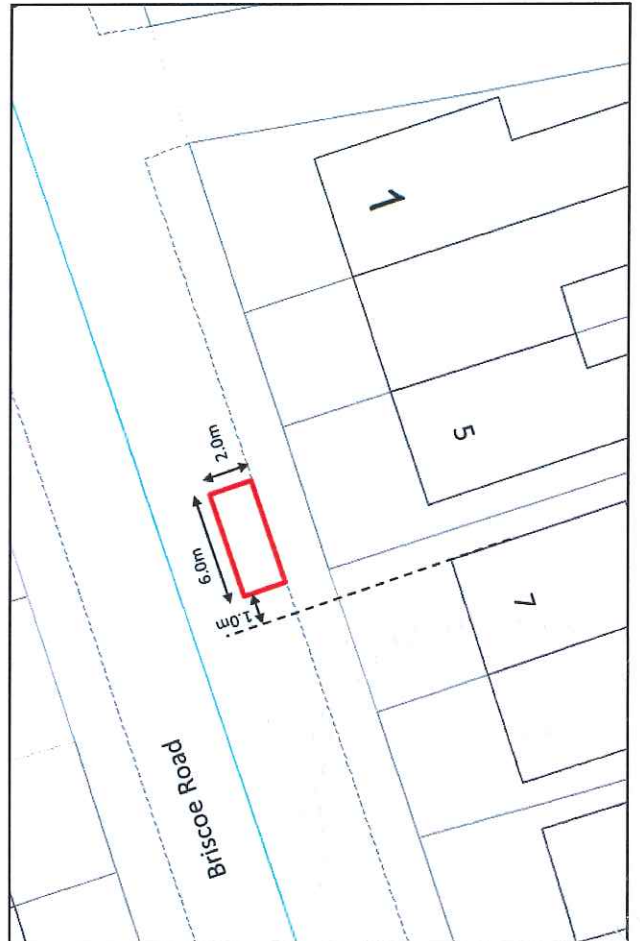
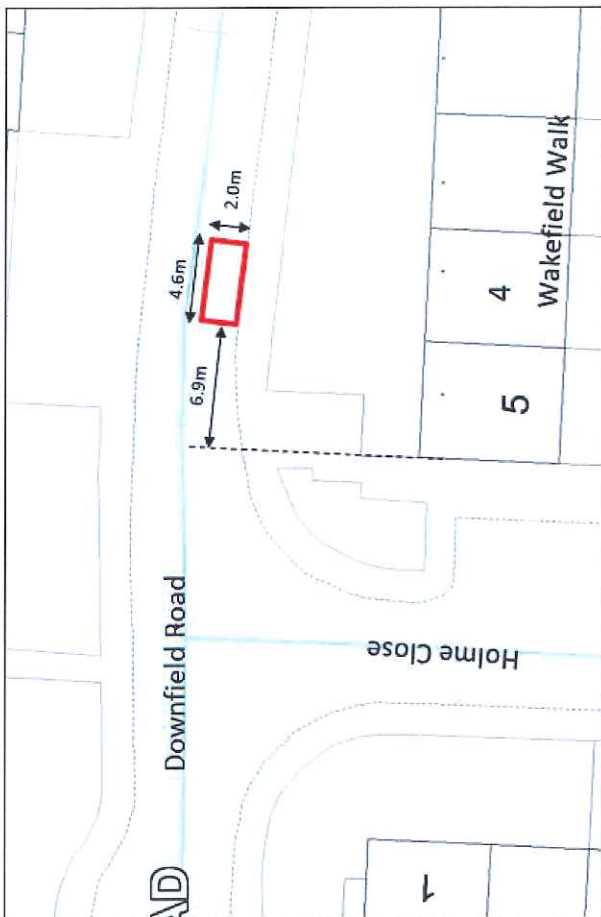
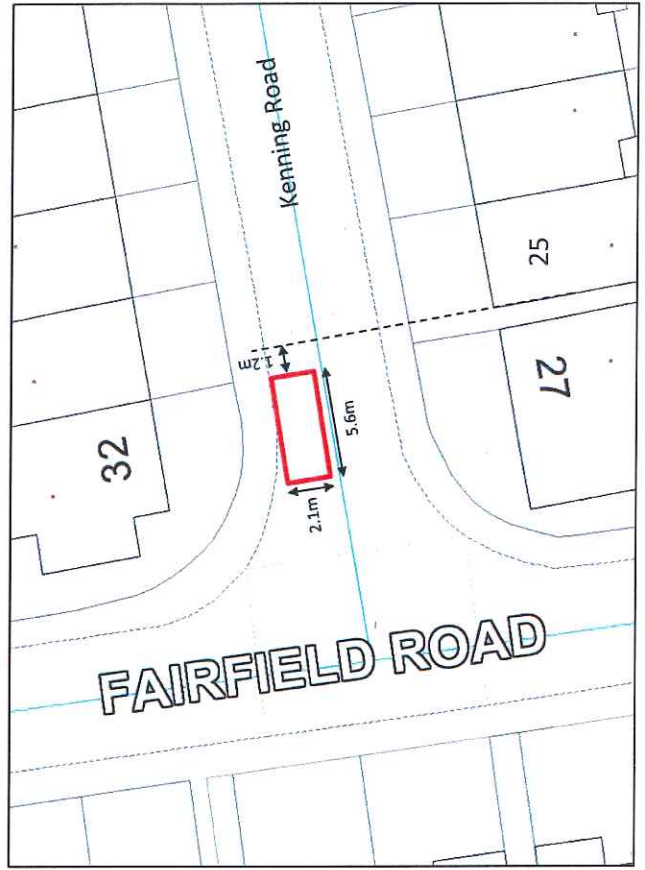
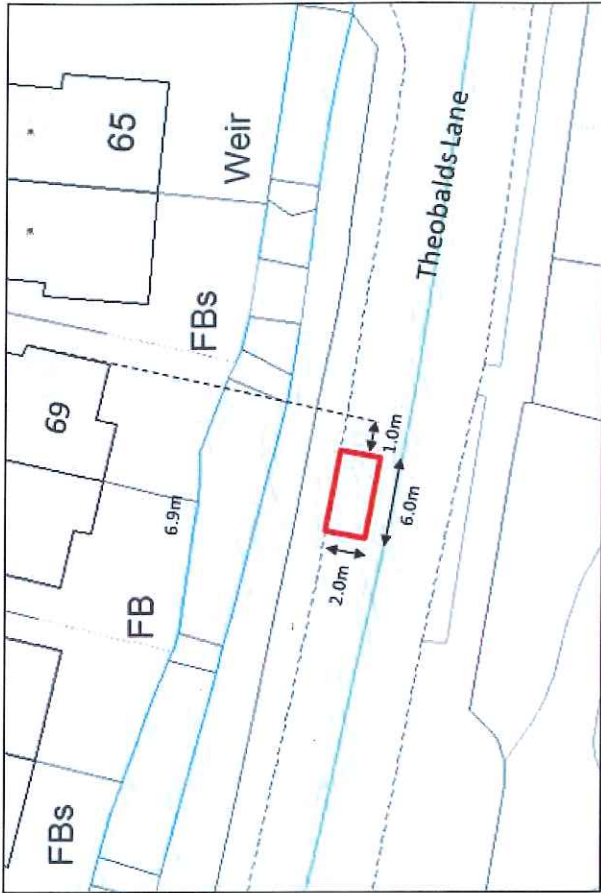

[Signature]
AUTHORISED SIGNATORY

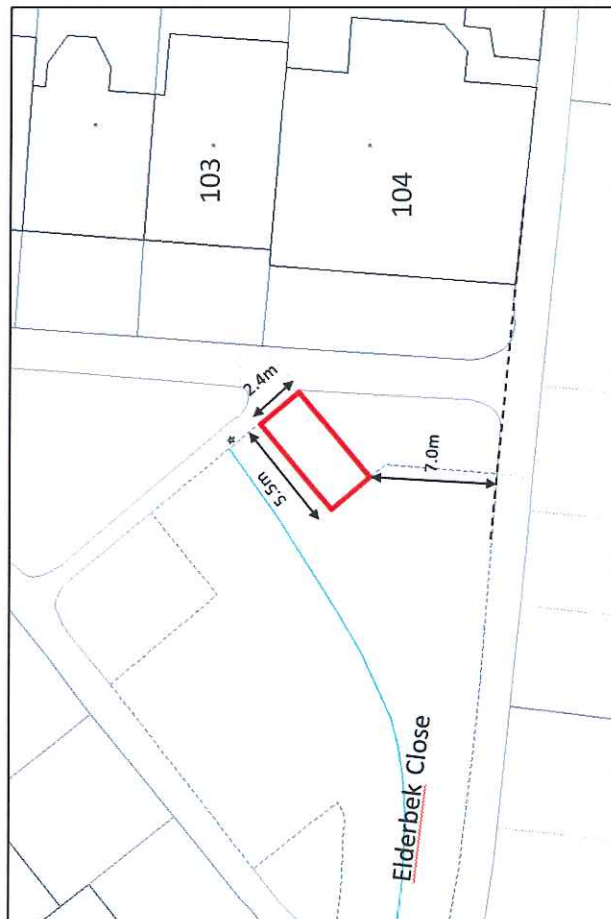
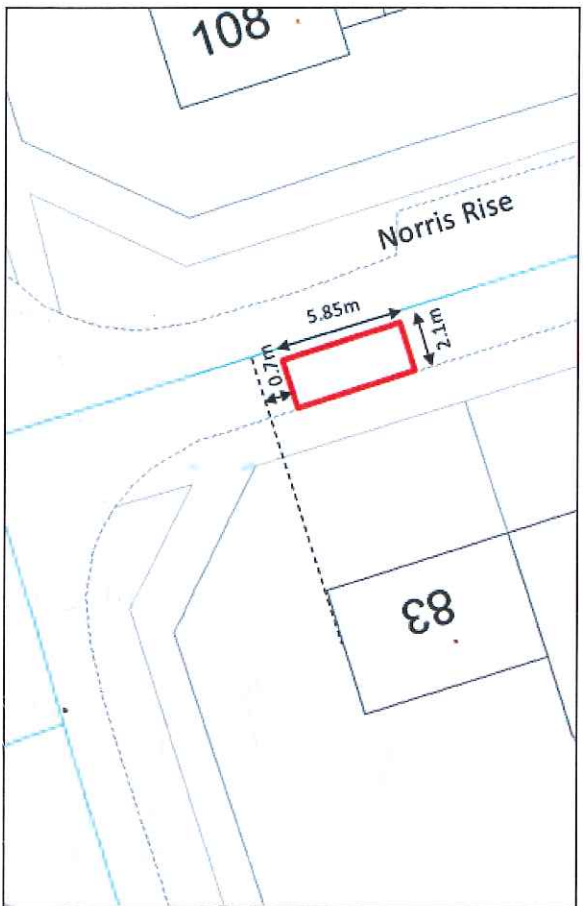
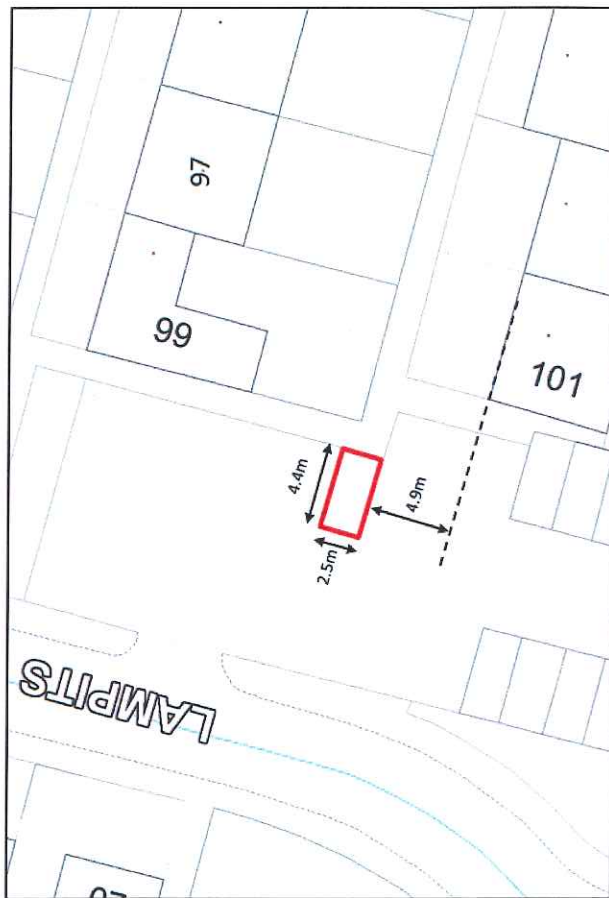
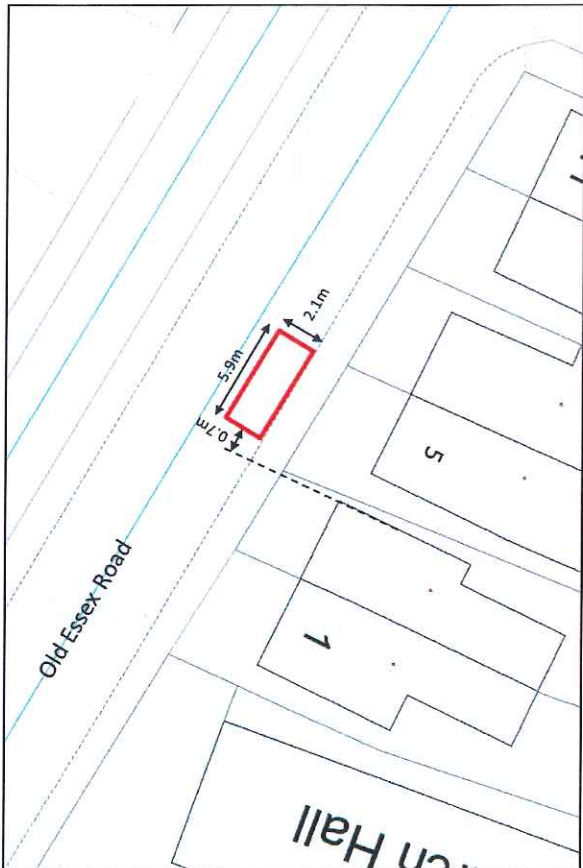

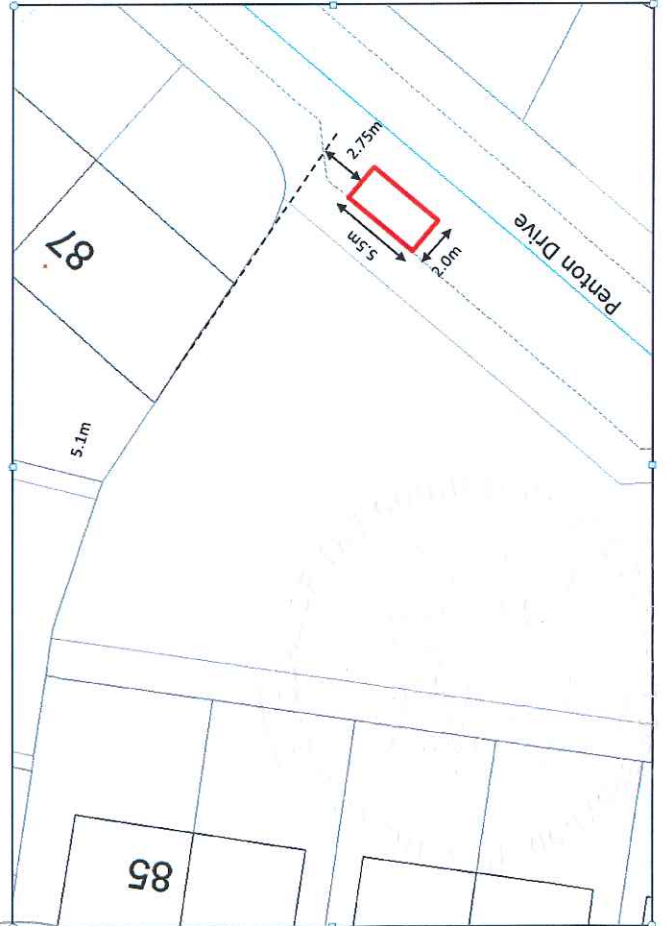
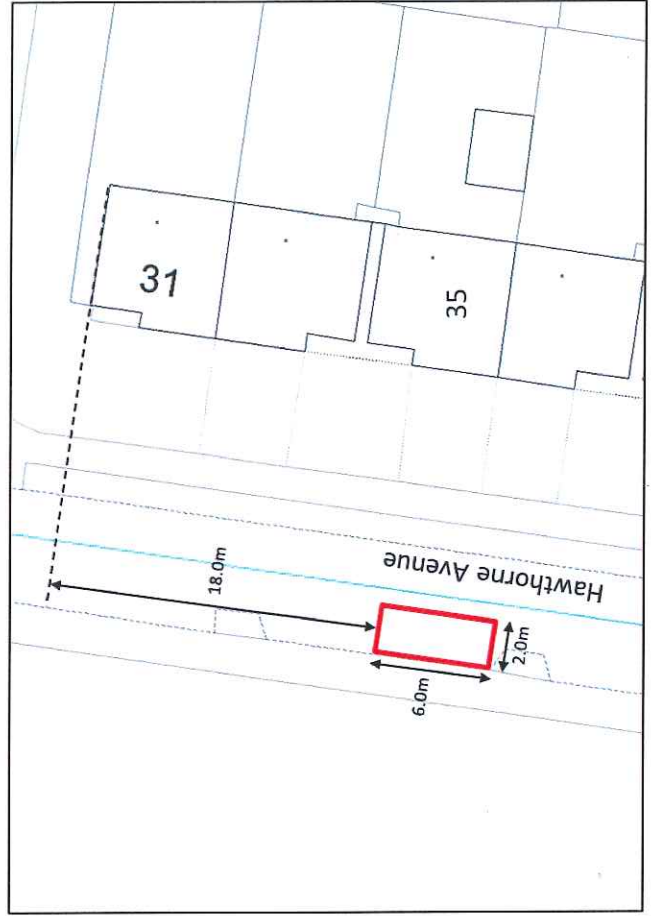
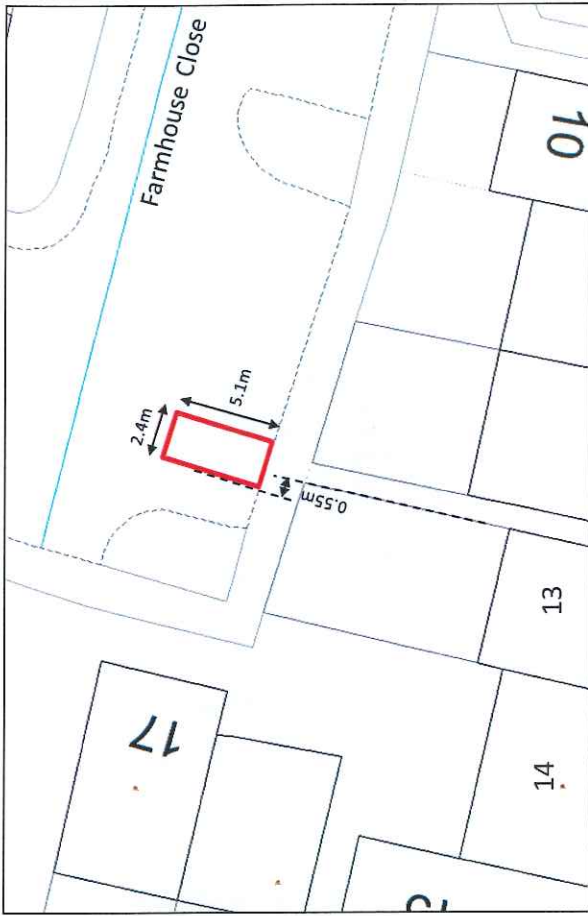

AUTHORISED SIGNATORY

