



Hertfordshire County Council,
County Hall, Pegs Lane,
Hertford SG13 8DQ



Borough Of Broxbourne,
Borough Offices, Bishops' College
Churchgate Cheshunt
Hertfordshire EN8 9XB

Sheet Active From: 18/07/2013

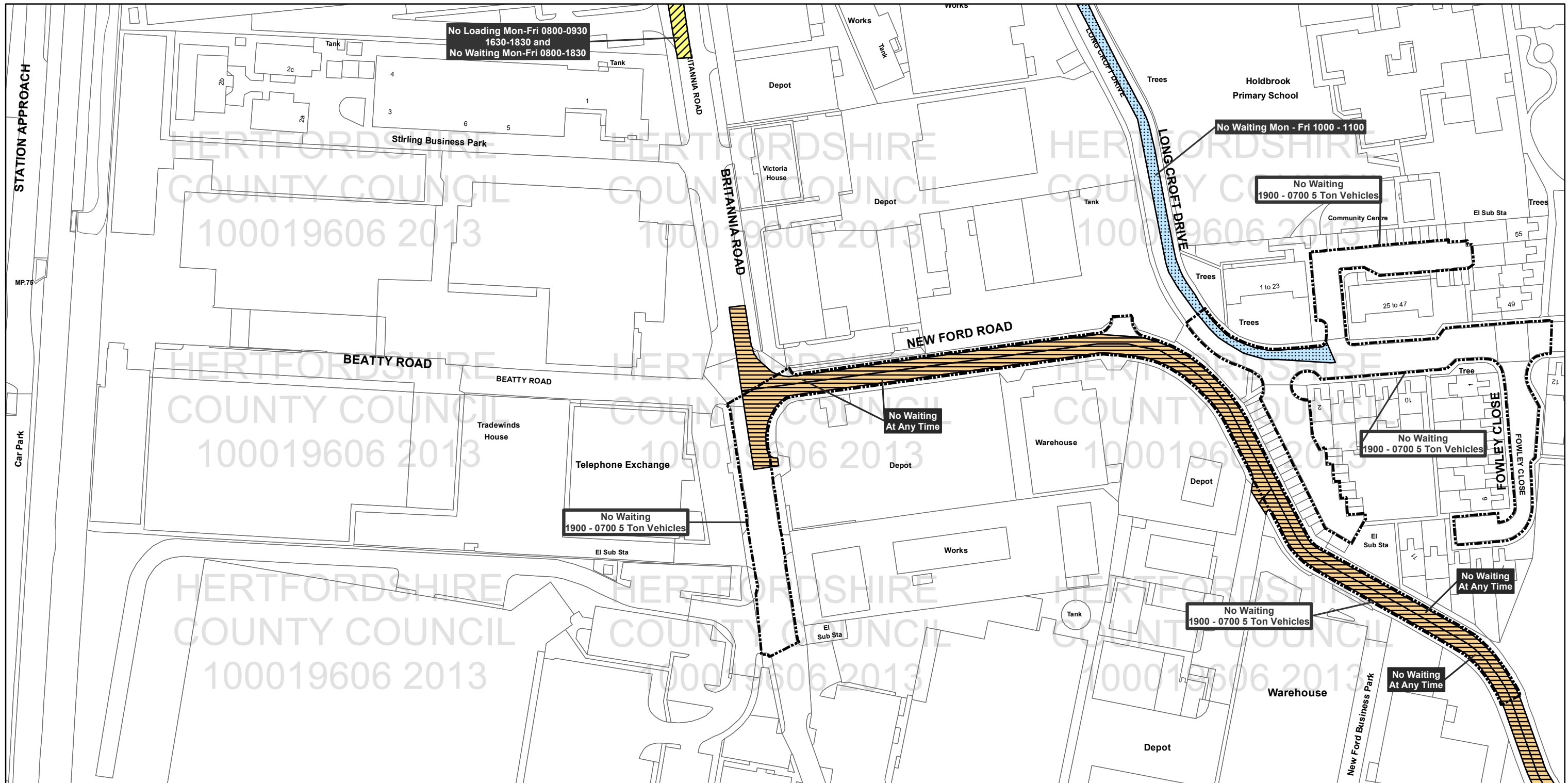

| Legend | |
|---|----------------------------------|
| Parking prohibitions and Restrictions | Designated Parking Places |
| No Stopping and No Loading/Unloading and No Waiting | Paid Parking |
| No Loading/Unloading and No Waiting | Voucher and Permit Holders |
| No Waiting at Any Time | Free Parking |
| Restricted Waiting | Disabled Parking |
| | Loading Unloading |
| Other Prohibitions Restrictions or Parking | Other Information |
| Taxi Bays | Controlled Parking Zone Boundary |
| Multiple Restriction | |
| Other Restrictions | |
| Total Restriction Zone (Can Occur in Conjunction with Other Restrictions) | |

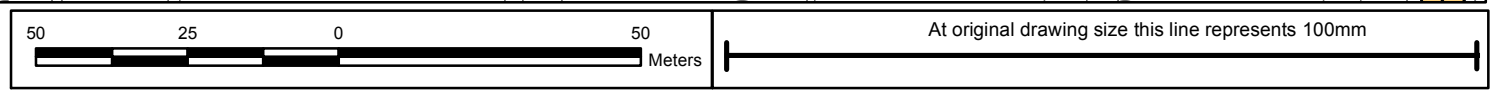

Title: Borough of Broxbourne
Control of Parking Consolidation Order
SCALE: 1:1,250

Based upon the Ordnance Survey material with the permission of Ordnance Survey on behalf of the Controller of Her Majesty's Stationary Office © Crown copyright. Unauthorised reproduction infringes Crown copyright and may lead to prosecution or civil proceedings.
Hertfordshire County Council 100019606, 2013

All areas over which the provisions of the orders apply are defined by the shaded areas as shown on the following plans plus a contiguous area not indicated on the plans of verge and/or footway between the carriageway edge and the highway boundary. At all times current legislation applies to all areas. The plans in this schedule are based upon grid references of the Ordnance Survey National Grid defined by the OSGB36 triangulation.