

# Plan No: BRX0305 Cheshunt



Hertfordshire County Council,  
County Hall, Pegs Lane,  
Hertford SG13 8DQ



Borough Of Broxbourne,  
Borough Offices, Bishops' College  
Churchgate Cheshunt  
Hertfordshire EN8 9XB

Sheet Revision Number: 3

Sheet Active From: 28/07/2021

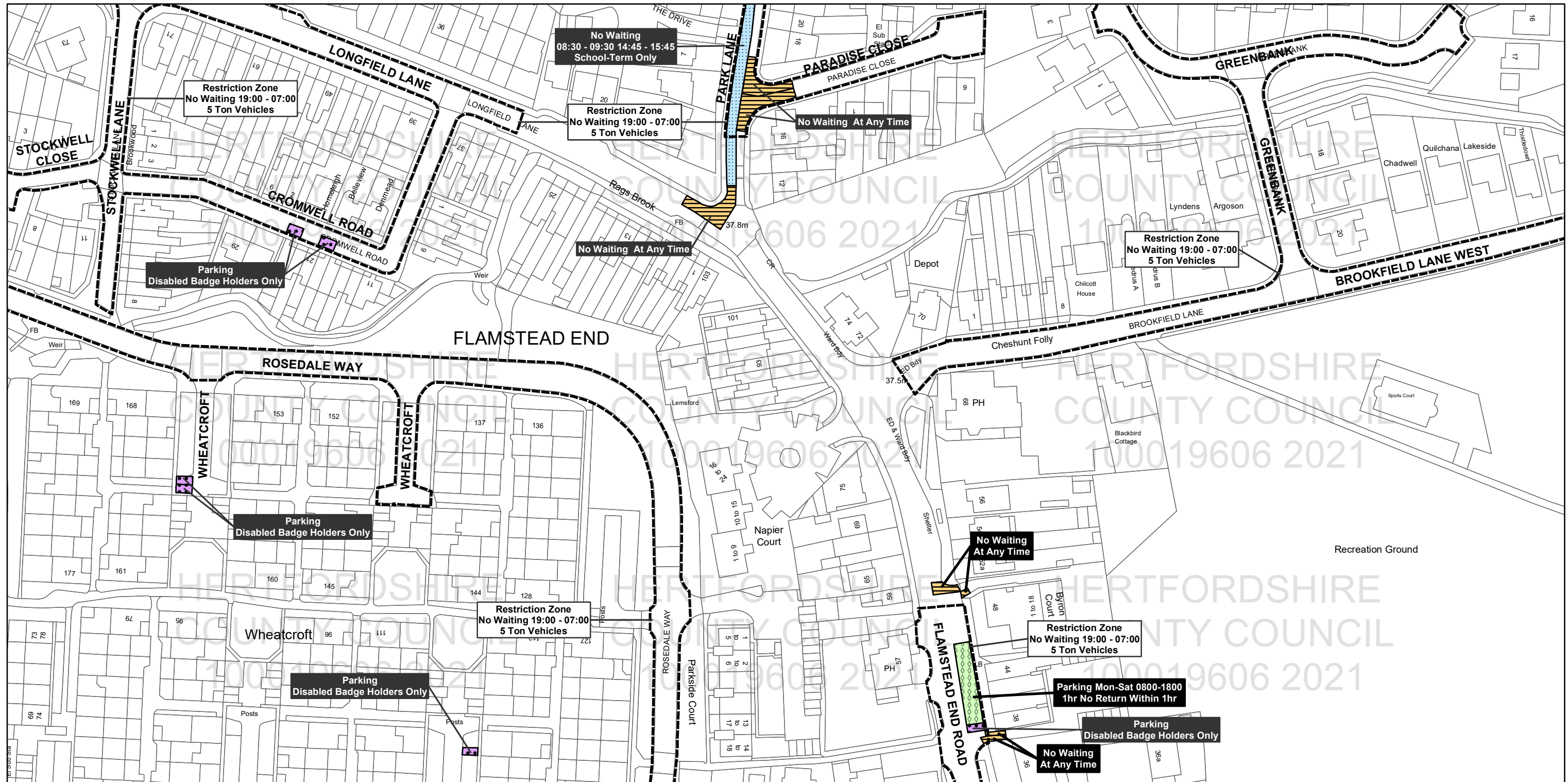

Legend		Other Information	
	No Stopping and No Loading/Unloading and No Waiting		Controlled Parking Zone Boundary
	No Loading/Unloading and No Waiting		Taxi Bays
	No Waiting at Any Time		Multiple Restriction
	Restricted Waiting		Other Restrictions
	Designated Parking Places		Total Restriction Zone (Can Occur in Conjunction with Other Restrictions)
	Paid Parking		Loading Unloading
	Voucher and Permit Holders		
	Free Parking		
	Disabled Parking		

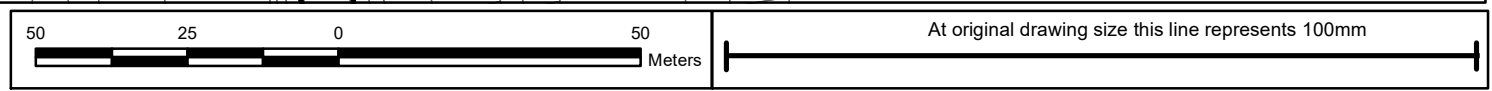

Title: Borough of Broxbourne  
Control of Parking Consolidation Order  
**SCALE: 1:1,250**

Based upon the Ordnance Survey material with the permission of Ordnance Survey on behalf of the Controller of Her Majesty's Stationary Office © Crown copyright. Unauthorised reproduction infringes Crown copyright and may lead to prosecution or civil proceedings.  
Hertfordshire County Council 100019606, 2021

All areas over which the provisions of the orders apply are defined by the shaded areas as shown on the following plans plus a contiguous area not indicated on the plans of verge and/or footway between the carriageway edge and the highway boundary. At all times current legislation applies to all areas. The plans in this schedule are based upon grid references of the Ordnance Survey National Grid defined by the OSGB36 triangulation.