

Plan No: BRX0235 Wormley and Turnford

Sheet Revision Number: 6

Sheet Active From: 28/07/2021



Hertfordshire County Council,
County Hall, Pegs Lane,
Hertford SG13 8DQ



Borough Of Broxbourne,
Borough Offices, Bishops' College
Churchgate Cheshunt
Hertfordshire EN8 9XB

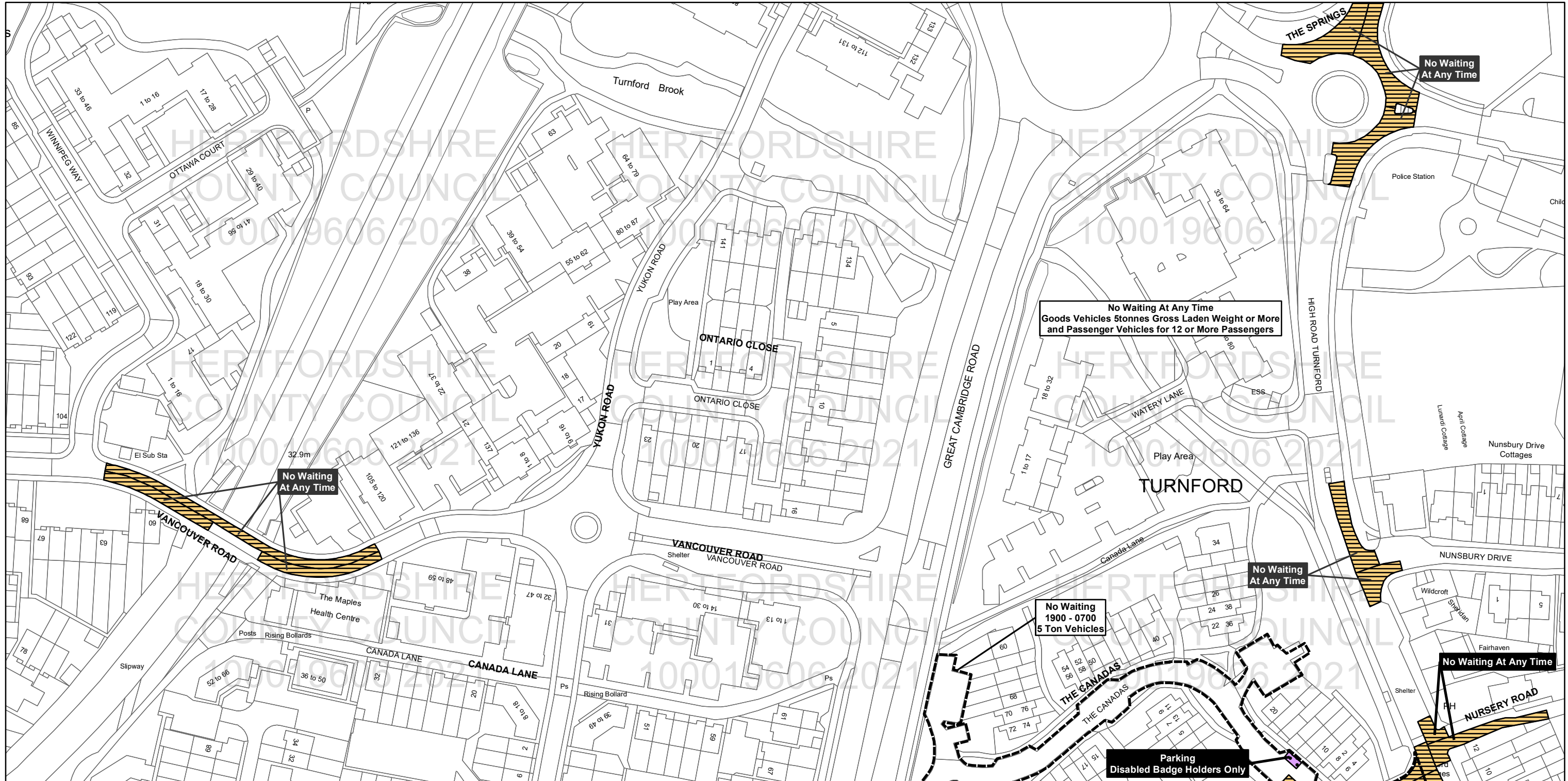

Parking prohibitions and Restrictions	Designated Parking Places	Other Prohibitions Restrictions or Parking	Other Information
No Stopping and No Loading/Unloading and No Waiting	Paid Parking	Taxi Bays	Controlled Parking Zone Boundary
No Loading/Unloading and No Waiting	Voucher and Permit Holders	Multiple Restriction	
No Waiting at Any Time	Free Parking	Other Restrictions	
Restricted Waiting	Disabled Parking	Total Restriction Zone (Can Occur in Conjunction with Other Restrictions)	
	Loading Unloading		

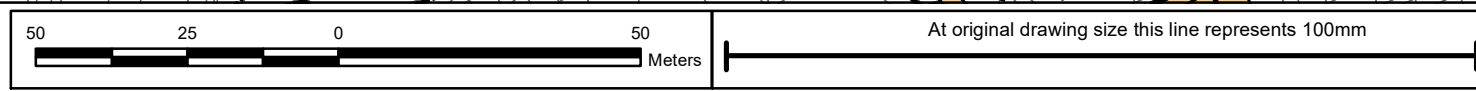

Title: Borough of Broxbourne
Control of Parking Consolidation Order
SCALE: 1:1,250

Based upon the Ordnance Survey material with the permission of Ordnance Survey on behalf of the Controller of Her Majesty's Stationary Office © Crown copyright. Unauthorised reproduction infringes Crown copyright and may lead to prosecution or civil proceedings.
Hertfordshire County Council 100019606, 2021

All areas over which the provisions of the orders apply are defined by the shaded areas as shown on the following plans plus a contiguous area not indicated on the plans of verge and/or footway between the carriageway edge and the highway boundary. At all times current legislation applies to all areas. The plans in this schedule are based upon grid references of the Ordnance Survey National Grid defined by the OSGB36 triangulation.