

Plan No: BRX0318 Cheshunt



Hertfordshire County Council,
County Hall, Pegs Lane,
Hertford SG13 8DQ



Borough Of Broxbourne,
Borough Offices, Bishops' College
Churchgate Cheshunt
Hertfordshire EN8 9XB

Sheet Revision Number: 6

Sheet Active From: 28/07/2021

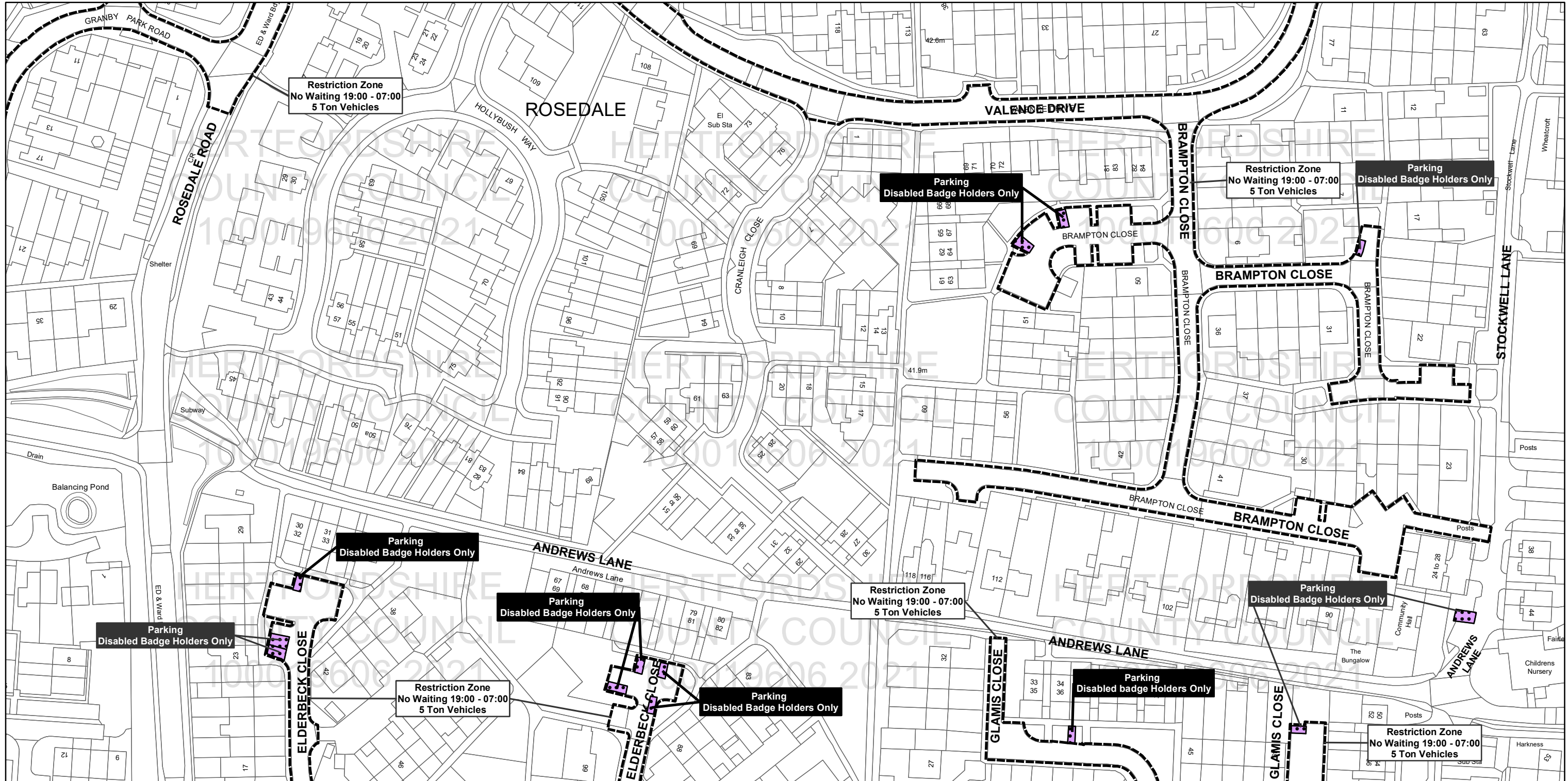

Legend

Parking prohibitions and Restrictions

- No Stopping and No Loading/Unloading and No Waiting
- No Loading/Unloading and No Waiting
- No Waiting at Any Time
- Restricted Waiting

Designated Parking Places

- Paid Parking
- Voucher and Permit Holders
- Free Parking
- Disabled Parking
- Loading Unloading

Other Prohibitions Restrictions or Parking

- Taxi Bays
- Multiple Restriction
- Other Restrictions
- Total Restriction Zone (Can Occur in Conjunction with Other Restrictions)

Other Information

- Controlled Parking Zone Boundary

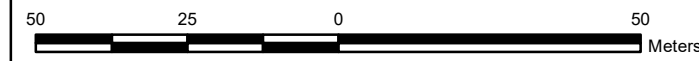

At original drawing size this line represents 100mm

Title: Borough of Broxbourne
Control of Parking Consolidation Order

SCALE: 1:1,250

Based upon the Ordnance Survey material with the permission of Ordnance Survey on behalf of the Controller of Her Majesty's Stationary Office © Crown copyright. Unauthorised reproduction infringes Crown copyright and may lead to prosecution or civil proceedings.
Hertfordshire County Council 100019606, 2021

All areas over which the provisions of the orders apply are defined by the shaded areas as shown on the following plans plus a contiguous area not indicated on the plans of verge and/or footway between the carriageway edge and the highway boundary. At all times current legislation applies to all areas. The plans in this schedule are based upon grid references of the Ordnance Survey National Grid defined by the OSGB36 triangulation.