

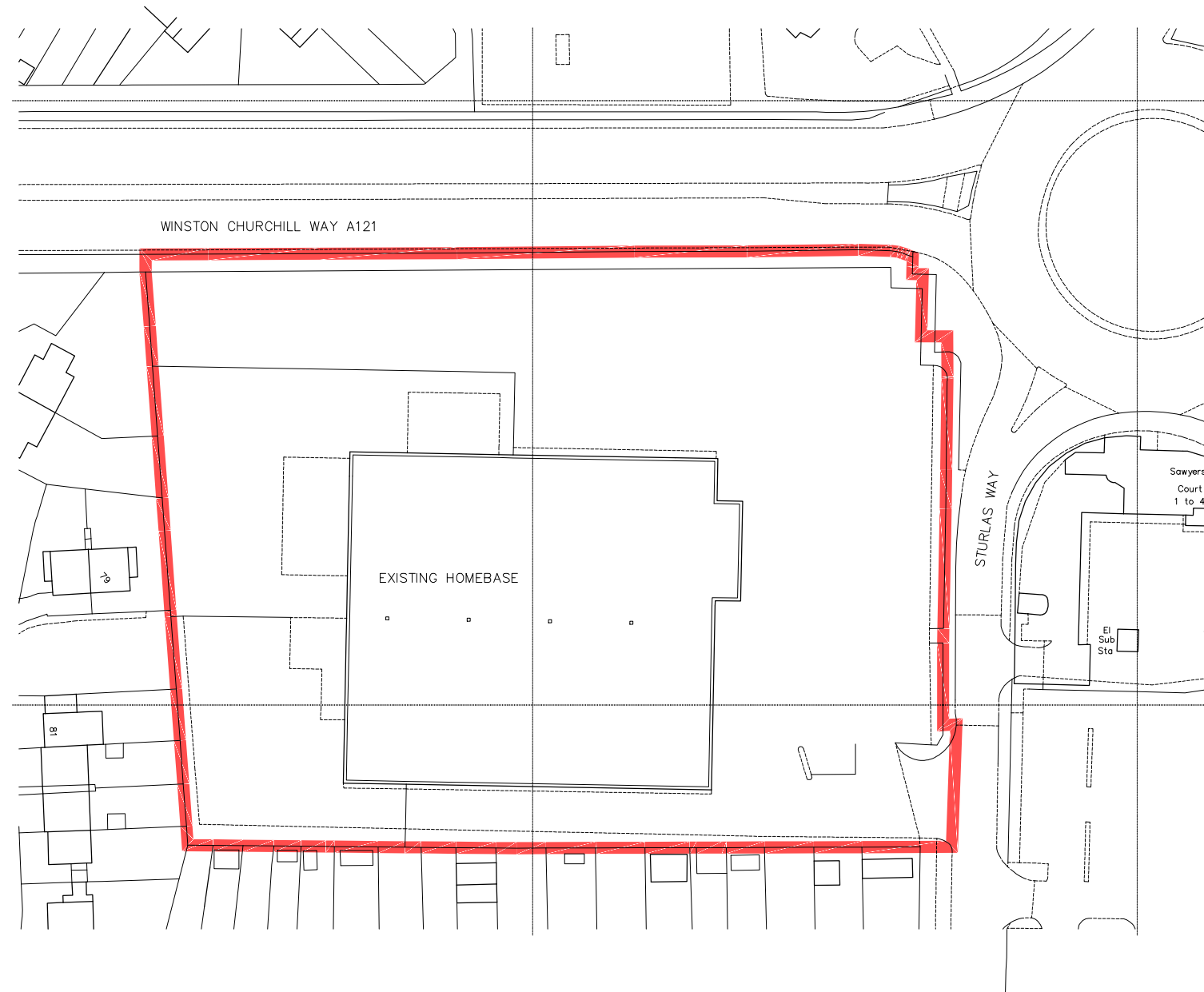

SUBJECT TO SITE SURVEY, CONFIRMATION OF LEGAL BOUNDARIES, SITE CONSTRAINTS & HIGHWAYS

THE HARRIS GROUP LTD DOES NOT ACCEPT LIABILITY FOR ANY DEVIATION FROM OUR DRAWINGS OR SPECIFICATION

APPLICATION SITE AREA (REDLINE) 1.64 HECTARES



Rev	Date	Description	Rev By	Chk'd By
A	19.03.21	APPLICATION BOUNDARY EXTENDED TO INCLUDE HIGHWAY ACCESS & TREE ON HIGHWAY AUTHORITY LAND IN NORTH EAST CORNER	JPG	---



Project Title	PROPOSED ALDI FOOD STORE AND HOMEBASE UNIT EXISTING HOMEBASE STURLAS WAY WALTHAM CROSS EN8 7BF			
Client	ALDI STORES LIMITED - CHELMSFORD			
Status	PLANNING			
Scale	1:1000	Drawing Size	A3	
Date	14.09.20	Drawn By	JPG	Checked-
Drawing Title	LOCATION PLAN			
Job-Dwg No	2924-COR-100	Rev	A	

- 2 St. Johns North, Wakefield, WF1 3QA t. 01924 291800
- Carvers Warehouse, 77 Dale Street, Manchester, M1 2HG t. 0161 2388555
- The Old Rectory, 79 High Street, Newport Pagnell, MK16 8AB t. 01908 211377
- 101 London Road, Reading, RG1 5BY t. 0118 9507700
- 10 Gees Court, St Christophers Place, London, W1U 1JJ t. 0207 4091215



This drawing is copyright and may not be reproduced in whole or part without written authority. Do not scale off this drawing.