

## BOROUGH OF BROXBOURNE COUNCIL

### THE BOROUGH OF BROXBOURNE (BOROUGH OFFICES BISHOPS' COLLEGE CAR PARK SOUTH)(OFF-STREET PARKING PLACES) ORDER 2019

The Council of the Borough of Broxbourne ("the Council"), pursuant to arrangements made under Section 19 of the Local Government Act 2000 and the Local Government (Arrangements for Discharge of Functions) (England) Regulations 2000 with Hertfordshire County Council ("the County Council") and in exercise of the powers conferred by Sections 32 and 53 of the Road Traffic Regulation Act 1984 ("the 1984 Act") and of all other enabling powers, and after consultation with the Chief Officer of Police in accordance with Part III of Schedule 9 to the 1984 Act, hereby make the following Order:

1. This Order may be cited as "The Borough of Broxbourne (Borough Offices Bishops' College Car Park South)(Off-Street Parking Places) Order 2019" and shall come into effect on 12<sup>th</sup> March 2020.
2. The Borough of Broxbourne (Borough Offices Bishops' College Car Park South)(Off-Street Parking Places) Order 2019 plan numbered BOB/2019/0902 herein after referred to in this Order as "the plan" is incorporated into this Order as Schedule 1.
3. Any reference in this Order to a numbered Article is a reference to the Article bearing that number in this Order and any reference in this Order to "the Schedule" is a reference to the Schedule to this Order.
4. In this Order except where the context otherwise requires the following expressions have the meaning hereby respectively assigned to them:

**"Authorised Officer"** – means an officer authorised in writing by the Chief Executive or the Director of Finances of the Council.

**"Bay Markings"** – means white or yellow lines marked on the surface of a parking place to indicate the limits of each individual parking bay.

**"Civil Enforcement Officer"** – means a person authorised by or on behalf of the Council pursuant to Section 76 of the Traffic Management Act 2004.

**“Disabled Person’s Badge”** has the same meaning as in the Disabled Persons (Badges for Motor Vehicles) (England) Regulations 2000.

**“Driver”** – in relation to a Vehicle waiting in a Parking Place means the person who was driving the Vehicle at the time it was left in the Parking Place and for the purposes of the Order and of any legal proceedings taken hereunder if on the date a Vehicle is left in a Parking Place a person is shown to have been the registered owner or keeper thereof by notification in writing from the Driver and Vehicle Licensing Agency or other appropriate authority he shall be deemed to have been the Driver of the Vehicle on the date unless the contrary is shown.

**“Hand-held Device”** – means a wireless hand-held computer which is programmed to interface with the Council’s database of Virtual permits

**“Operational Times”** – in relation to a parking place, means the hours between 7.30am and 5.30pm, Monday to Friday, excluding any time during which the operation of the parking place is suspended under the provision of Article 13.

**“Parking Place”** – means the area marked as ‘Borough Offices Bishops’ College Car Park South’ on the plan numbered BOB/2019/0902 incorporated into this Order.

**“Parking Space”** – means a part of a Parking Place marked out by means of white lines or otherwise for the leaving of a Vehicle.

**“Parking Permit”** means a permit issued by the Council or by an Authorised Officer which entitles the respective vehicle to which the parking permit was issued to park in the parking place by virtue of the vehicle displaying that parking permit in the relevant position.

**“Relevant Position”** means:

(a) In the case of a Disabled Persons Badge has the same meaning as in Regulation 4 of The Local Authorities’ Traffic Orders (Exemption for Disabled Persons) (England) Regulations 2000.

(b) In the case of a Parking Permit means;

- (i) in the case of a vehicle fitted with a front windscreen it is exhibited on the inside surface thereof with the face of the Parking Permit facing forwards such that the vehicle registration number, date and time of validity are legible and clearly visible from outside the vehicle; or
- (ii) in the case of a vehicle not fitted with a front windscreen it is exhibited in a conspicuous position on the front of the vehicle or as far as possible

towards the front of the vehicle on the nearside thereof with the face of the Parking Permit facing towards such that the vehicle registration number, date and time of validity are legible and clearly visible from outside the vehicle.

**“Vehicle”** means a motor car (not exceeding 2 metres in height) without trailers, motorcycles with or without side cars attached, invalid carriages.

**“Virtual Permit”** means a permit granted by the Council or Service Provider to park in the parking place by virtue of the vehicle displaying its vehicle registration mark, and by that mark appearing on a list of vehicles authorised by the Council or Service Provider to be left in the parking place.

5. No person shall cause or permit a Vehicle to wait in a parking space at any time unless every part of the vehicle is positioned wholly within markings of a Parking Space.
6. The Driver of a Vehicle shall not permit it to wait in a Parking Space that has been reserved by means of a sign or surface marking specifically for use by a disabled person unless the Vehicle is displaying in the Relevant Position a Disabled Persons' Badge issued in accordance with the Disabled Persons (Badges for Motor Vehicles) Regulations (England) 2000.
7. No person shall cause or permit a vehicle to wait in a parking space during the Operational Hours:
  - (i) without displaying a valid parking permit in the relevant position, or
  - (ii) without the virtual permit being granted to the vehicle.
8. During the Operational Times relating to a parking place at all times during which a Vehicle is left in that Parking Place:
  - (a) It shall display in the relevant position a valid Parking Permit, so that all the particulars on that Parking Permit are clearly and easily visible from outside the vehicle and from the front of the vehicle; or

- (b) where the Council or the Service Provider has granted the vehicle one virtual permit, the details of the permit in respect of that vehicle shall appear on a hand-held device.
9. (a) The Council may at its absolute discretion issue a Parking Permit or to authorise a Virtual Permit for the parking of a specified Vehicle at a Parking Place.  
(b) Any Parking Permit or Virtual Permit shall not be transferable between vehicles or Parking Places and shall be valid only for the Parking Place and for the period specified by the Council.
10. A vehicle left in a Parking Place at any time in contravention of any provision of this Order shall incur a Penalty Charge Notice in accordance with the provisions of Part 6 and Schedule 9 of the Traffic Management Act 2004.
11. (1) The period for which a Vehicle may be left in a Parking Place during the Operational Times after a Penalty Charge has been incurred shall not exceed four hours;  
(2) If a Vehicle is left in a Parking Place during the Operational Times for more than four hours after the Penalty Charge has been incurred it shall be the duty of the Civil Enforcement Officer to attach to the Vehicle in a conspicuous position a further Penalty Charge Notice and note the time at which the Civil Enforcement Officer first noticed that the Vehicle had been left in the Parking Place for more than four hours after the Penalty Charge had been incurred.
12. When a Penalty Charge Notice has been attached to a Vehicle in accordance with any of the foregoing provisions of this Order, no person, not being the Driver or person in charge of the Vehicle shall remove the notice from the Vehicle or interfere with the notice unless he is the Driver or person authorised to do so by the Driver or a Civil Enforcement Officer.
13. (1) The Council may by notice or sign displayed at or near the parking place close, suspend or reserve for particular vehicles the use of the parking place or any part thereof for any purpose.

(2) No person shall cause or permit any vehicle to be in the parking place or any part thereof if there is a notice or sign indicating that the use of the parking place or part thereof is closed, suspended or reserved for particular vehicles or a particular purpose.

Provided that nothing in this sub-paragraph shall apply in relation to a vehicle in respect of which the parking place or part thereof has been reserved.

14. (1) Where a vehicle is left in a Parking Place in contravention of any of the provisions contained in this Order a person authorised by the Council may remove the vehicle or arrange for it to be removed from that Parking Place PROVIDED that if a vehicle is waiting in a Parking Place in a position other than fully within markings of the Parking Space a person authorised by the Council may alter or cause to be altered the position of the Vehicle in order that its position shall comply with that provision;

(2) Any Civil Enforcement Officer or other person duly authorised by the Council or a police constable in uniform may move or cause to be moved in the case of an emergency to any place he/she thinks fit any vehicle left in a Parking Place;

(3) Any person removing or altering the position of a vehicle by virtue of Article 14 of this Order may do so by towing or driving the vehicle or in such other manner as he/she may think necessary and may take such measures in relation to the vehicle as he/she may think necessary to enable him/her to remove it or alter its position as aforesaid;

(4) Any person removing or arranging for the removal of a vehicle by virtue of the provisions of this Article shall make such arrangements as he/she considers to be reasonably necessary for the safety of the vehicle in the place to which it is removed and the Council shall not be liable for any loss or damage caused to the vehicle or its contents as a result of its being moved within the Parking Place or removed from the Parking Place under the provision of this Article;

- (5) All reasonable expenses including administrative expenses incurred by the Council in the removal of a vehicle by virtue of this Article shall be reimbursed to the Council by the Driver of the vehicle.
15. Where in a Parking Place signs are erected or surface markings are laid for the purpose of indicating:
- (a) the entrance to or exit from the Parking Place or
  - (b) that a Vehicle using the Parking Place shall proceed in a specified direction within the Parking Place.
  - (c) No person shall drive or cause or permit to be driven any Vehicle:
    - (i) so that it enters the Parking Place otherwise than by an entrance or leaves the Parking Place otherwise than by an exit so indicated; or
    - (ii) in a direction other than that specified as the case may be.
16. A Driver of a Vehicle shall not use a Parking Place so as to unreasonably prevent access to any premises adjoining the Parking Place or so as to be a nuisance to the Council or the owners or occupiers of any adjoining property or to any persons using a Parking Place.
17. A Driver of a Vehicle using a Parking Place shall stop the engine as soon as the Vehicle is in position in the Parking Space and shall not start the engine except when about to change position of the Vehicle or to depart from the Parking Place.
18. No person shall without prior consent in writing of the Council use a Vehicle while it is in a Parking Place in connection with the sale of any article or purchase of any article from other persons or in connection with the selling or offering for hire of his/her skill or services whether in or near the Parking Place.
19. The Driver of a Vehicle using a Parking Place shall not sound any horn, musical equipment or other similar instrument whilst the Vehicle is stationary.

20. No person shall service, overhaul, carry out work of construction or repair to a Vehicle while it is in a Parking Place or allow or permit the same except such as may be necessary to enable the Vehicle to be removed from the Parking Place.
21. No person shall unless having a right of way over the Parking Place or except with the permission of a person duly authorised by the Council drive any vehicle in a Parking Place other than for the purpose of leaving that vehicle in the Parking Place in accordance with the provisions of this Order or for the purpose of departing from the Parking Place.
22. No person shall in a Parking Place wantonly shout or otherwise make any loud noise or use any threatening abusive or insulting language gesture or conduct with intent to put any person in fear or so as to occasion a breach of the peace or whereby a breach of the peace is likely to be occasioned.
23. No Person shall use or permit or allow to be used any part of a Parking Place or any vehicle left in a Parking Place for sleeping or camping purposes or for providing any form of overnight accommodation.
24. No person shall use any part of a Parking Place or any vehicle left in a Parking Place for cooking purposes.
25. No person shall in a Parking Place whether inside or outside of any vehicle light or cause or permit to be lit any fire.
26. No person in a Parking Place shall erect or cause to be erected any booth stand or building or other structure without the prior written consent of the Council.
27. No person shall deposit in a Parking Place any vehicles goods equipment matter or materials so as to obstruct any part of the Parking Place.

28. The Council does not undertake to supervise the Parking Places specified on the plan incorporated into this order and entry to and exit from and use of the Parking Spaces specified as aforesaid is entirely at the users' risk and although the Council is servants or agents do not attempt to exempt themselves from their common law duty of reasonable skill and care of their obligations under the Occupiers Liability Act 1957 and 1984 the Council its servants and agents do not accept liability for any damage to or loss of Vehicles or their contents which arise from acts or omissions outside their reasonable control.

#### SCHEDULE 1

Plan incorporated into this Order – The Borough of Broxbourne (Borough Offices Bishops' College Car Park South)(Off-street Parking Places) Order 2019

Plan numbered BOB/2019/0902 is incorporated into this Order.

IN WITNESS whereof the Common Seal of the Council of the Borough of Broxbourne was hereunto been affixed this 5<sup>th</sup> March 2020

The Common Seal of **THE COUNCIL**  
**OF THE BOROUGH OF BROXBOURNE**  
was hereunto affixed in the presence of:



  
Authorised Signatory





Project: THE BOROUGH OF BROXBOURNE (BOROUGH OFFICES BISHOPS' COLLEGE CAR PARK SOUTH)  
(OFF-STREET PARKING PLACES) ORDER 2019

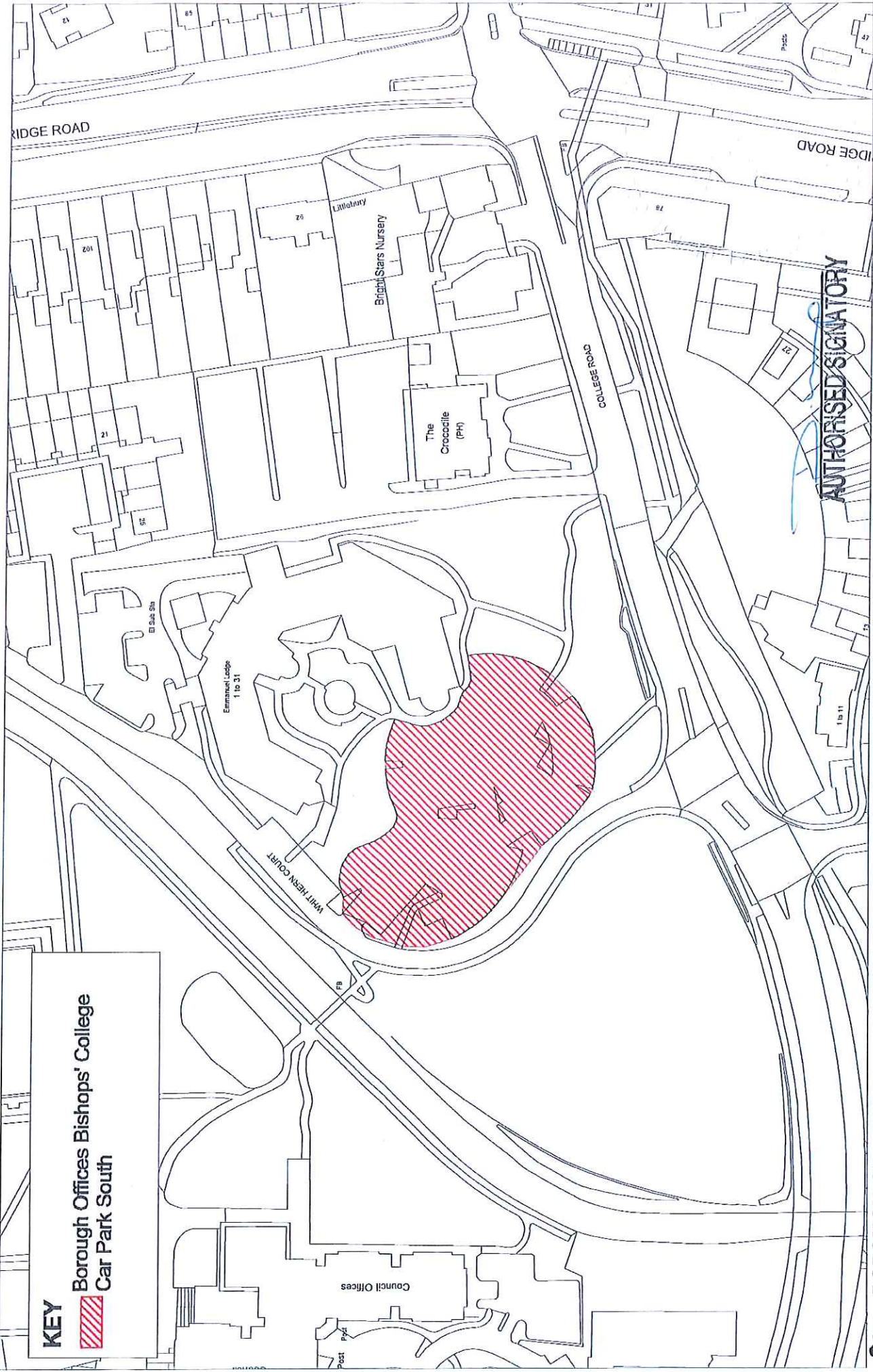

**KEY**

 Borough Offices Bishops' College  
Car Park South

**AUTHORISED SIGNATORY**

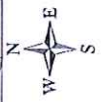

Crown Copyright: Borough of Broxbourne LA100023526  
USER: S.Bates/ER DATE 10 September 2019 SCALE : 1/1,250

Street: Borough Offices Bishops' College Car Park South  
Drawing No: BOB/2019/0902

**BOROUGH OF  
BROXBOURNE**  
www.broxbourne.gov.uk

The following information is provided for your reference. The data is accurate as of the date of the report.

The total number of units produced during the period was 1,200 units. The total cost of production was \$120,000.

The cost per unit is calculated as follows:

$$\text{Cost per unit} = \frac{\text{Total Cost}}{\text{Total Units}} = \frac{\$120,000}{1,200} = \$100$$

Therefore, the cost per unit is \$100.

The following table shows the breakdown of the total cost:

Category	Amount
Direct Materials	\$60,000
Direct Labor	\$40,000
Overhead	\$20,000
<b>Total</b>	<b>\$120,000</b>

The following table shows the breakdown of the total units produced:

Category	Amount
Units Produced	1,200

The following table shows the breakdown of the total cost per unit:

Category	Amount
Direct Materials	\$50
Direct Labor	\$33.33
Overhead	\$16.67
<b>Total</b>	<b>\$100</b>